



DIY Bathroom Mirror Storage Case

Copyright © 2014 Shanty-2-Chic.com

Supply List

Item	Quantity	Description
19" x 63" x 1/4" plywood	1	
1 x 6 x 8'	2	Pine or whitewood board
1 x 4 x 8"	4	Pine or whitewood board
1-1/4" pocket hole screws	44	
Staples	handful	To attach the plywood panel
Wood glue		
Finish of choice		
Decorative overlay hinges	4	
Door pull	1	
Magnetic catch	1	

Drill pocket holes for 1-1/4" pocket hole screws as indicated by the arrows.

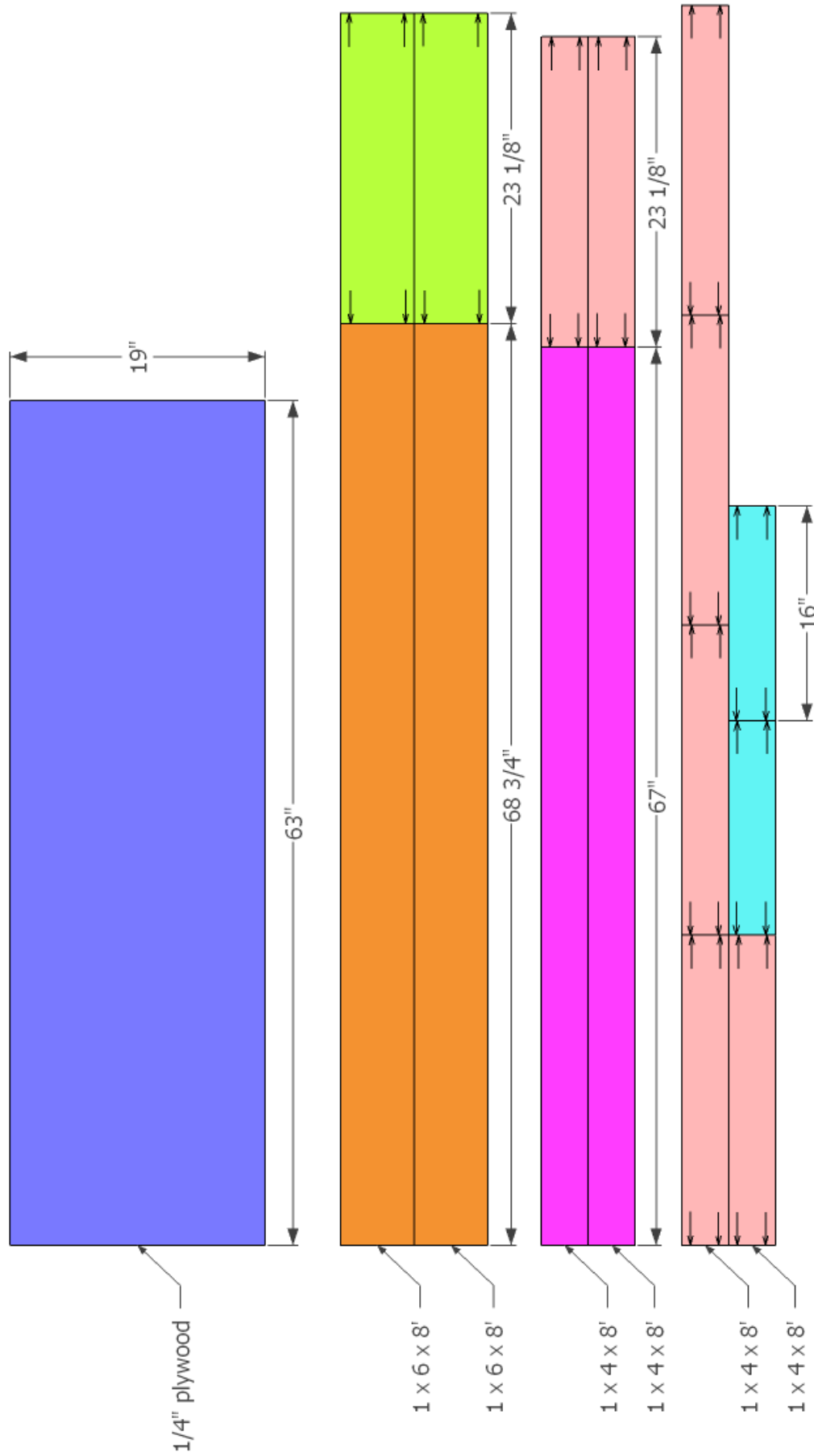

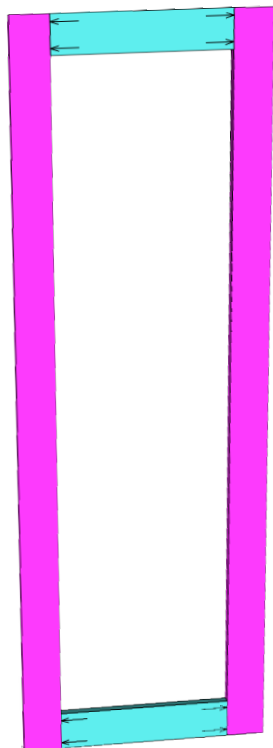

1

Assemble the door parts with glue and 1-1/4" pocket hole screws. Then attach the 1/4" plywood to the back using a thin bead of wood glue and staples.

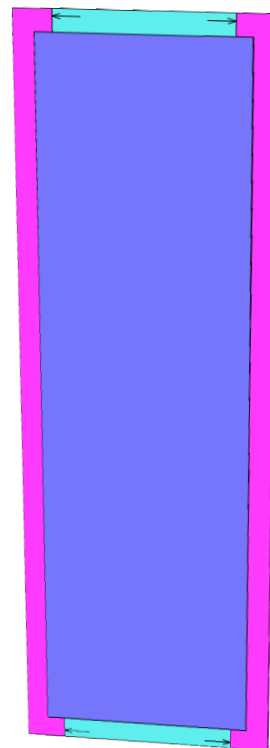

2

Assemble the case frame. Use glue and 1-1/4" pocket hole screws to attach the horizontal 1 x 6 pieces to the vertical 1 x 6 pieces.

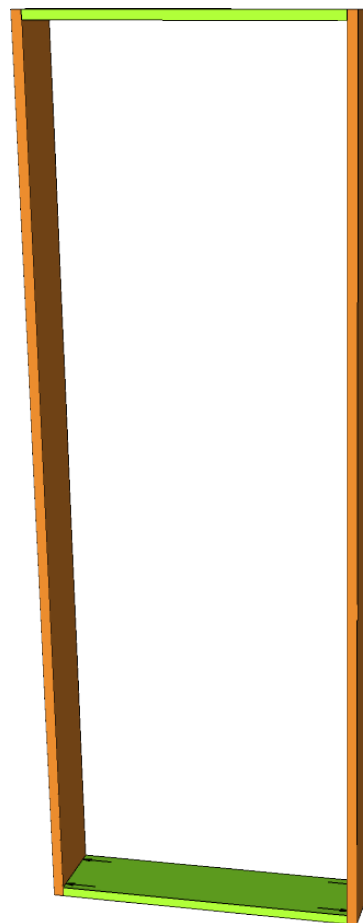

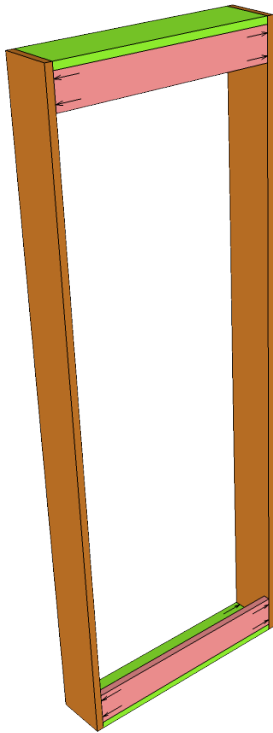

3

Next, attach the top and bottom braces to the inside of the case. Line these up to the back side and make sure the pocket holes are facing the back. Secure these with wood glue and 1-1/4" pocket hole screws. We will screw through these braces to hang it on the wall later.

4

Add the shelves. You can choose whatever height you want or use the measurements that I used. These are installed so that the pocket holes are on the bottom of each shelf and with the back side of the shelf lined up with the back of the case.

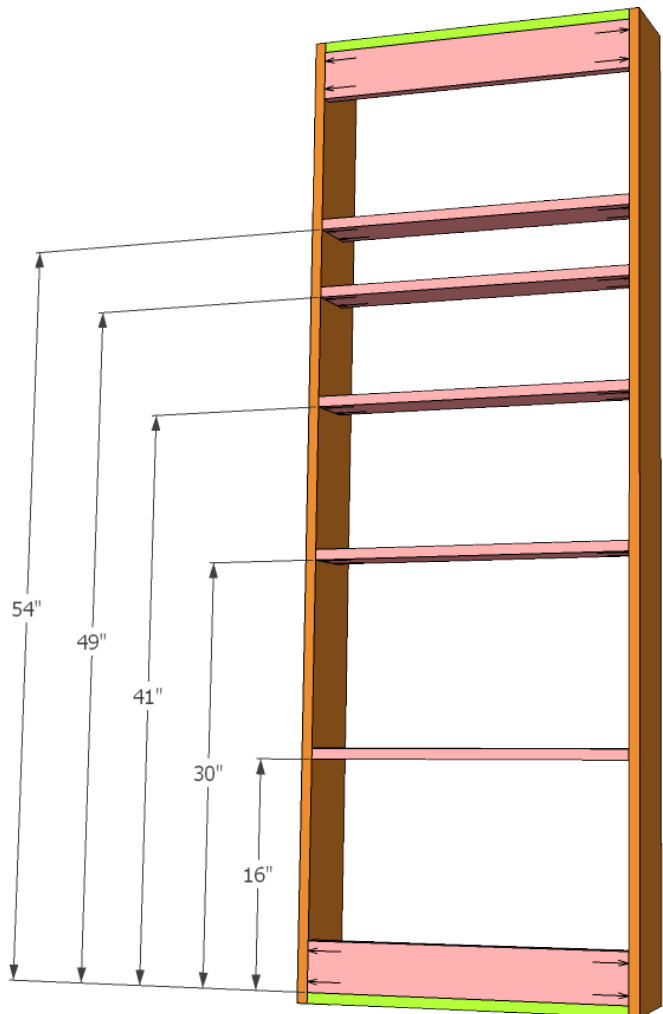

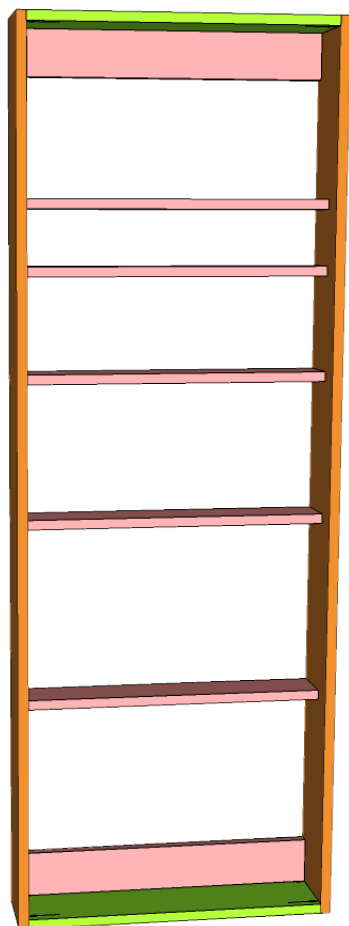

5

At this point you can sand and stain using your finish of choice. Drill through the top and bottom braces at the correct distance to locate two of your wall studs. Secure the case to the wall with two 3" wood screws in each brace.

6

Using mirror glue attach the mirror to the door. After giving the glue enough time to cure you can position the door where you want it in the case with a pair of clamps at the top. Then add your hinges, door pull, and magnetic latch. If you decide to make this project be sure to stop by our website and let us know!

