

## Dress-Up Storage Cart

Copyright © 2014 Shanty-2-Chic.com

### Supply List

Item	Quantity	Description
48" x 96" x 3/4" plywood	1	You could substitute three 1 x 12 x 8' if you want
1 x 2 x 8'	2	Pine or whitewood board
1" dowel	1	
1-1/4" pocket hole screws	24	
Brad nails	handful	
2" wood screws	2	For attaching the dowel
Wood filler		
Finish of choice		
2" swivel casters	4	

Drill pocket holes for 1-1/4" pocket hole screws as indicated by the arrows.

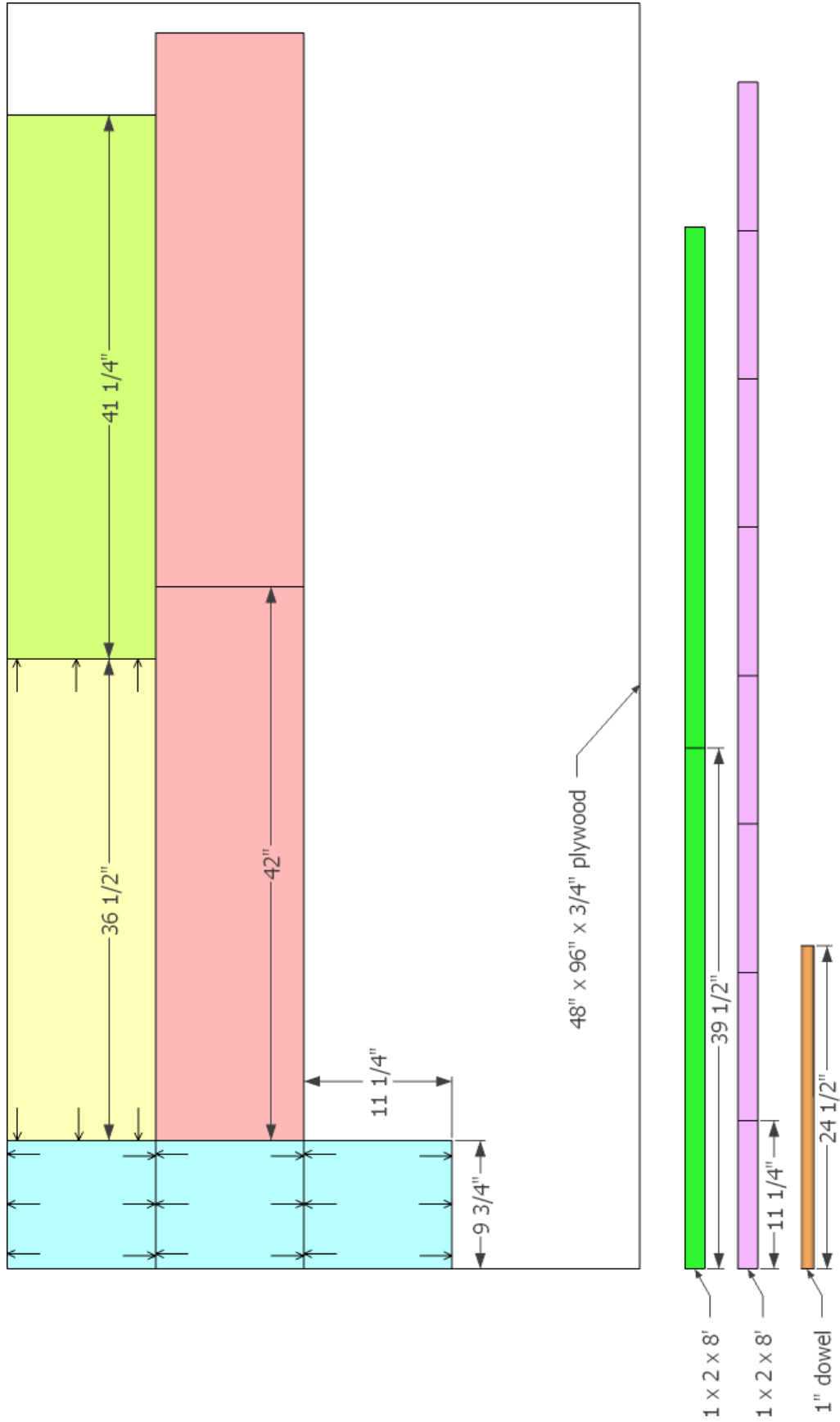

1

Use wood glue at every joint in this project. Attach the two sides to the bottom panel with 1-1/4" pocket hole screws. Make sure the pocket holes are on the bottom of the project.

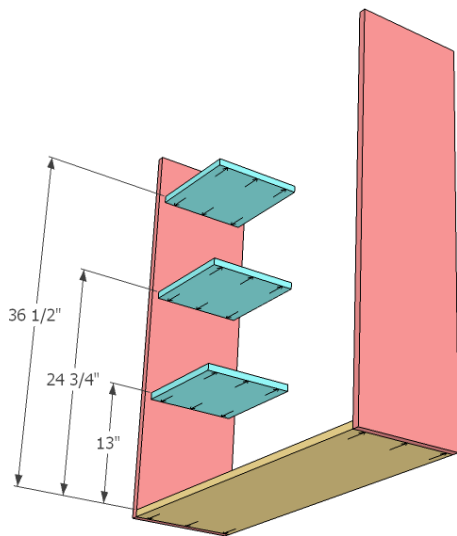
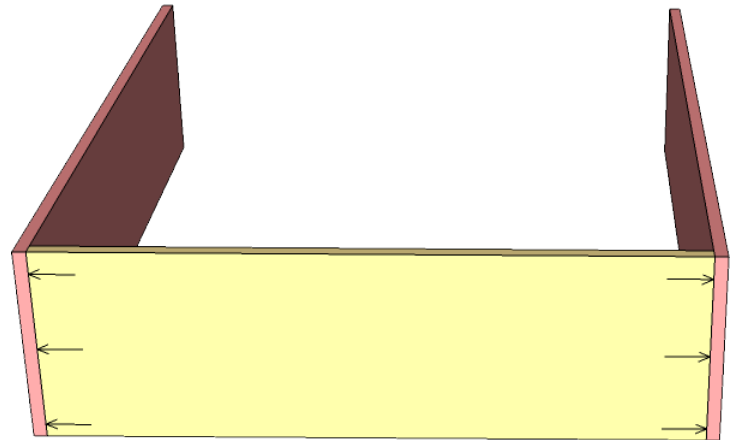

2

Attach the shelves to one side. The shelf spacing is 13", 24-3/4", and 36-1/2" from the bottom panel. Make sure these shelves are centered on the side panel. This will allow room for the trim boards later.

3

Add the middle divider next. Use 1-1/4" pocket hole screws to attach the shelves to it and you can either pocket hole screw the base of this divider to the bottom panel or use brad nails from below to secure it in place.

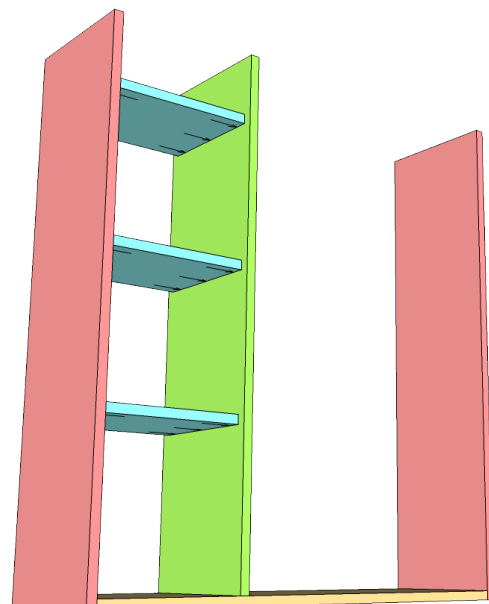

4

Cut and fit the trim pieces for the shelves. These should be 11-1/4" long. Use brad nails to attach them to the shelves.

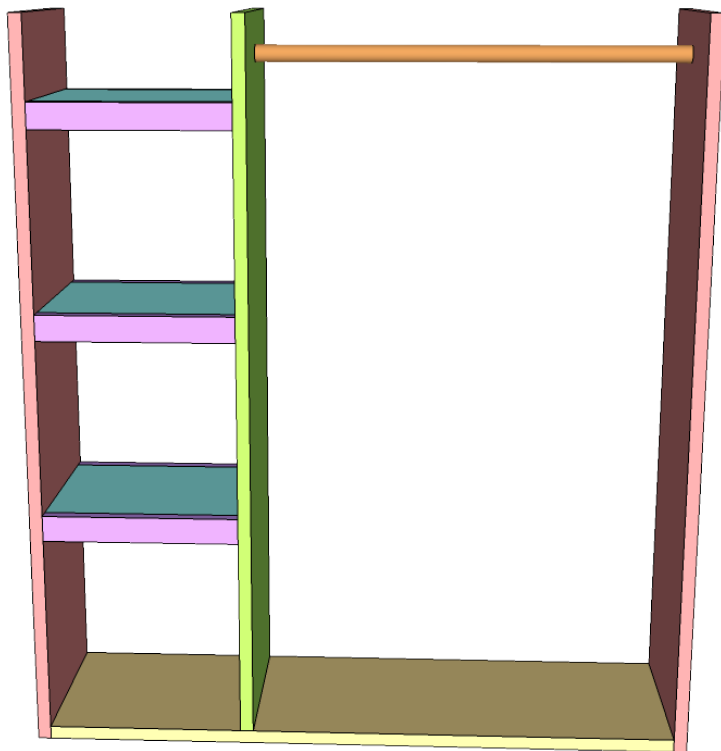
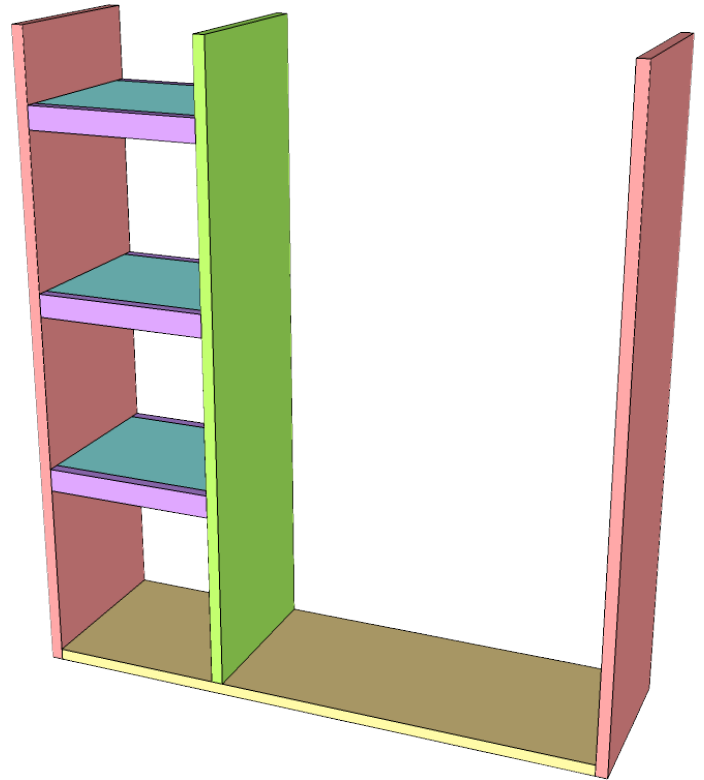

5

Cut the dowel rod to length and attach it to the inside of the large opening. Pre-drill through the panels and use a 2" wood screw to hold the dowel in place.

6

Attach the base trim with brad nails. The side pieces should go on first followed by the front and back.

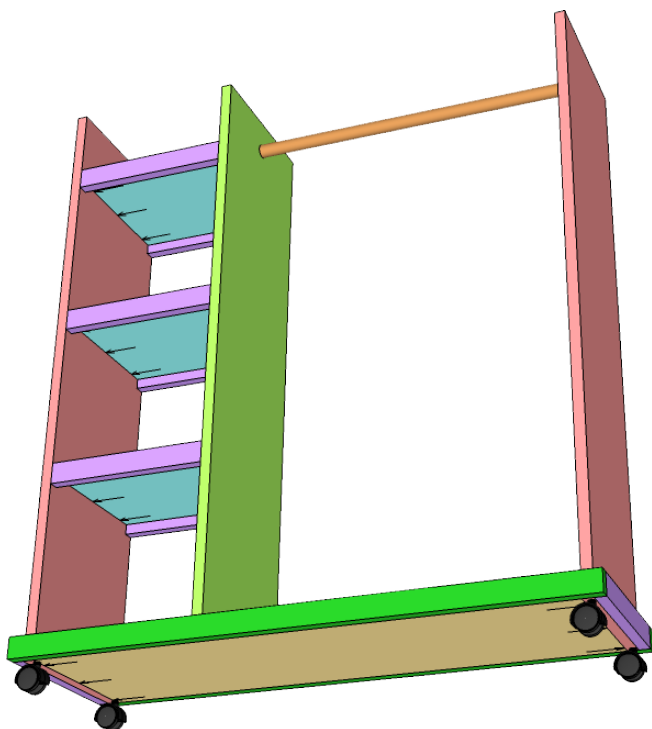
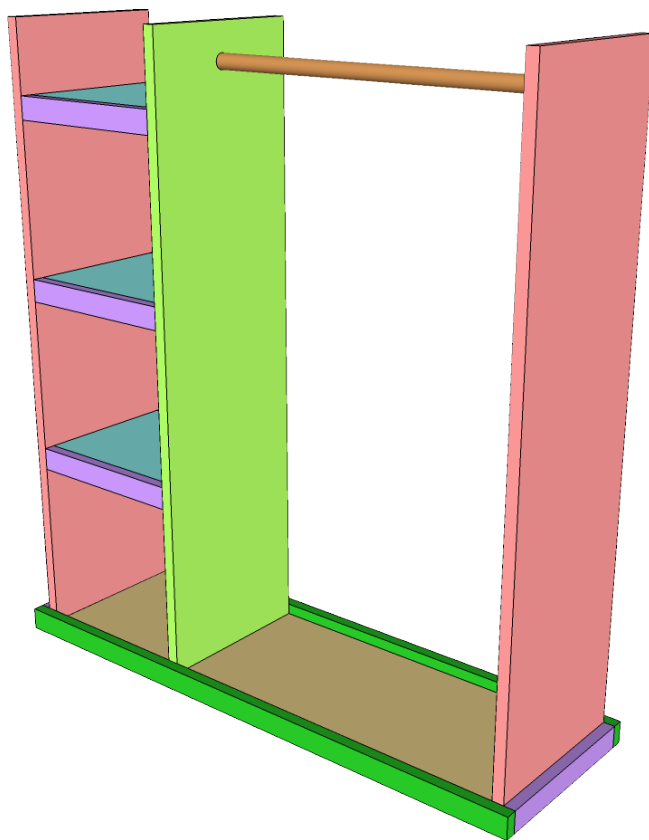

7

Now you just need to fill all of your holes, sand, and finish. Add your casters and personalize as you wish! If you decide to make one of these super easy Dress-Up Storage Carts be sure to stop by our website and let us know!