

Coffee Cabinet

Copyright © 2014 Shanty-2-Chic.com

Supply List

Item	Quantity	Description
1 x 4 x 8'	3	Pine or whitewood board
1 x 4 x 6'	1	Pine or whitewood board
1 x 3 x 8'	2	Pine or whitewood board
1 x 3 x 6'	2	Pine or whitewood board
1 x 2 x 6'	1	Pine or whitewood board
41-1/2" x 38" x 1/4" plywood	1	For the back
17" x 30-3/4" x 1/2" wire mesh	2	
48" x 96" x 3/4" plywood	1	
1-1/4" pocket hole screws	139	
Brad nails	handful	
Wood glue		
Finish of choice		
1/2" wide drawer pulls		
1/2" staples		For attaching the wire mesh
Decorative hinges	4	

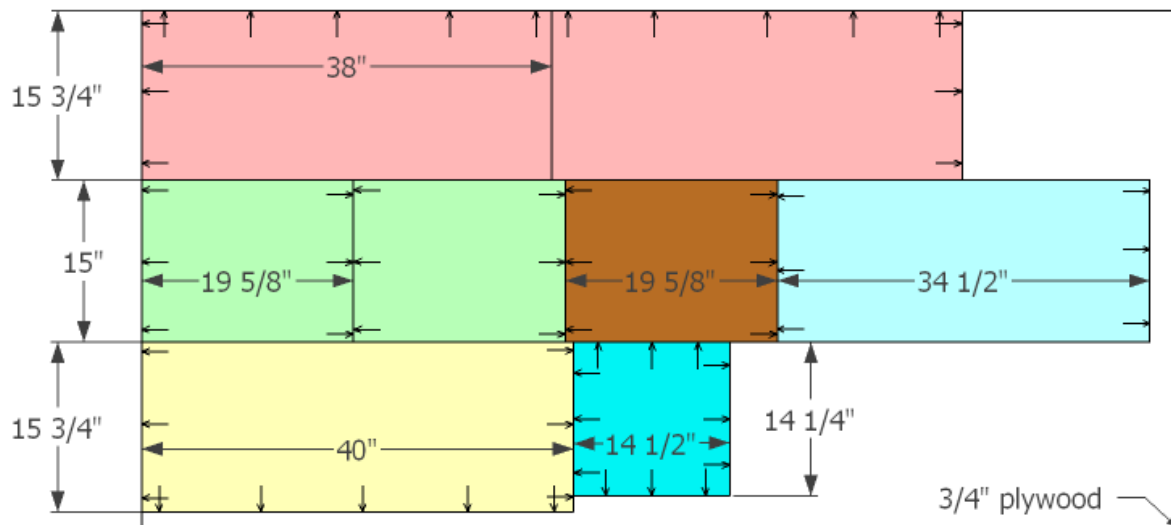
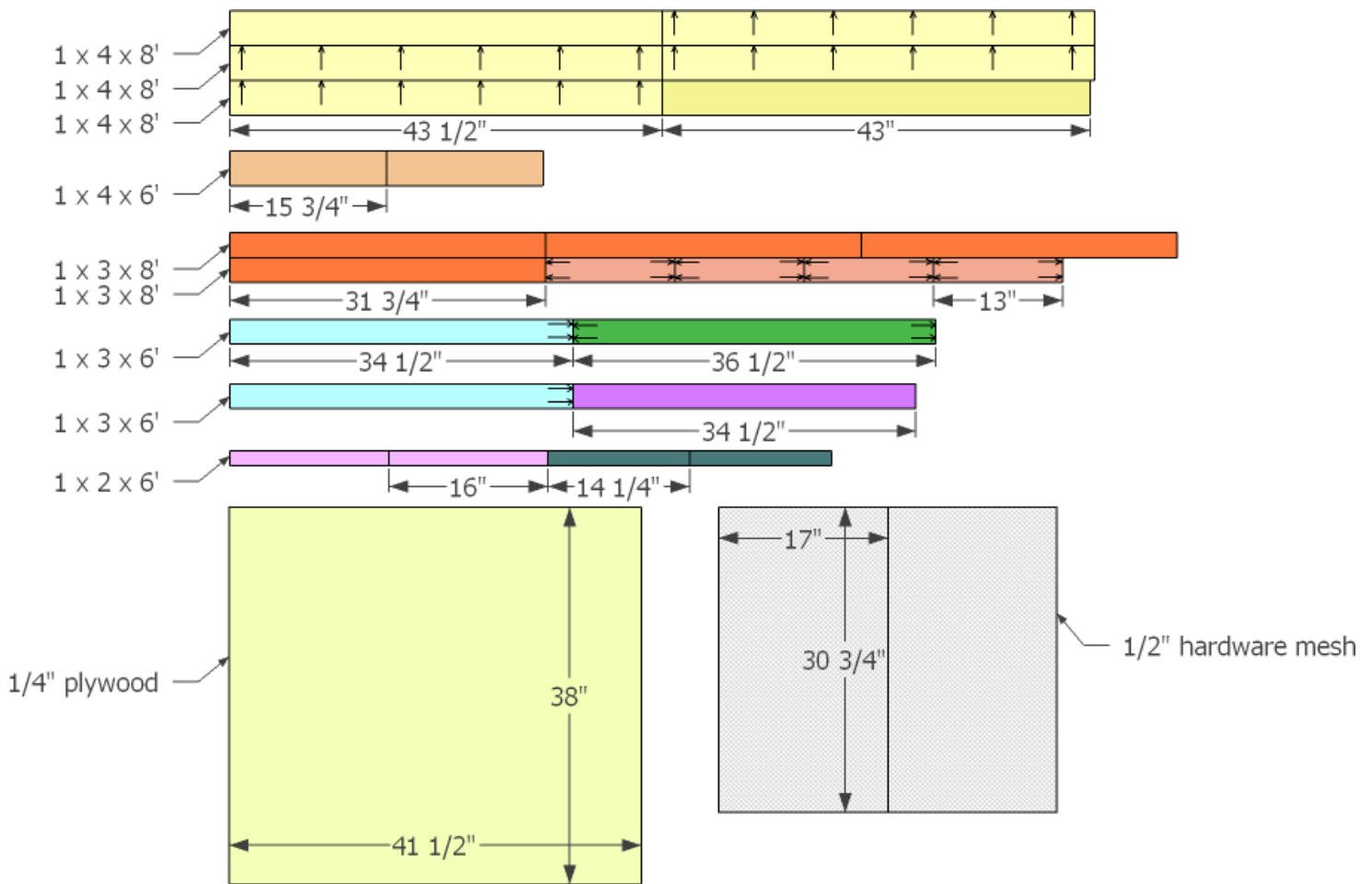

Drill pocket holes for 1-1/4" pocket hole screws as indicated by the arrows. Adjust all of your measurements as needed as they might be slightly different as you build.

1

Use wood glue at every joint in this project. Secure the bottom panel to side panels. Make sure the pocket holes are positioned on all of the pieces to later attach the front face frame. The top of the bottom shelf should be 3-1/2" from the ground.

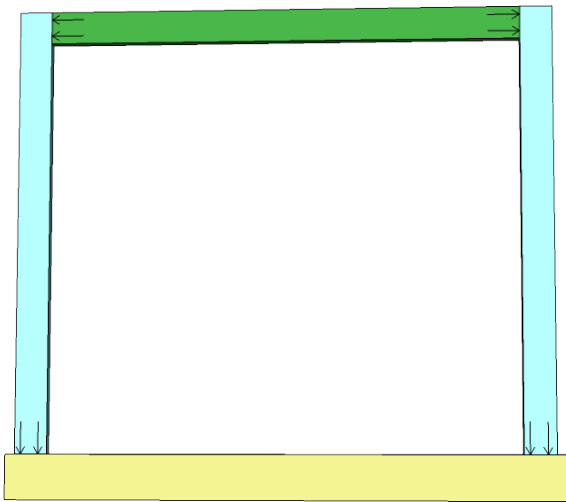
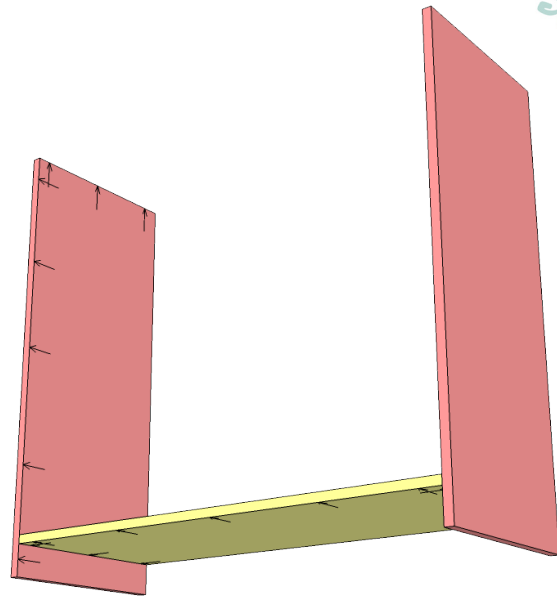

2

Assemble the face frame with pocket hole screws. The bottom board is centered with 3/4" overhang on both ends.

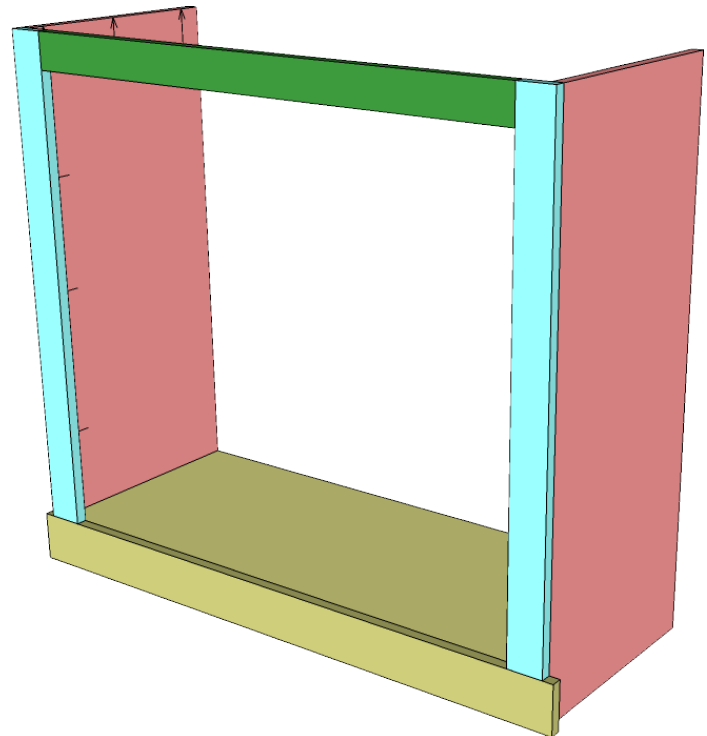

3

Glue and screw the front face frame onto the plywood panels.

4

Using glue and brad nails, attach the lower side trim boards.

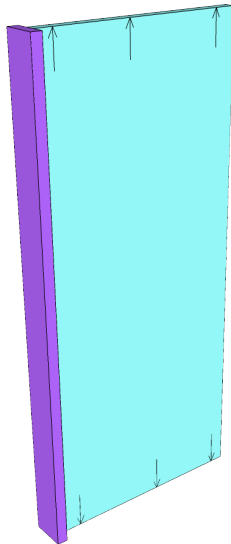
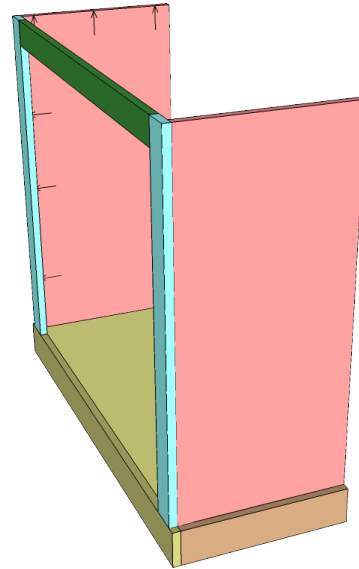

5

Using glue and brad nails, attach the center trim board to the middle divider. This trim board should be centered on the plywood.

6

Secure the center divider in place with pocket hole screws on the bottom end with brad nails through the top of the center trim board into the top of the face frame.

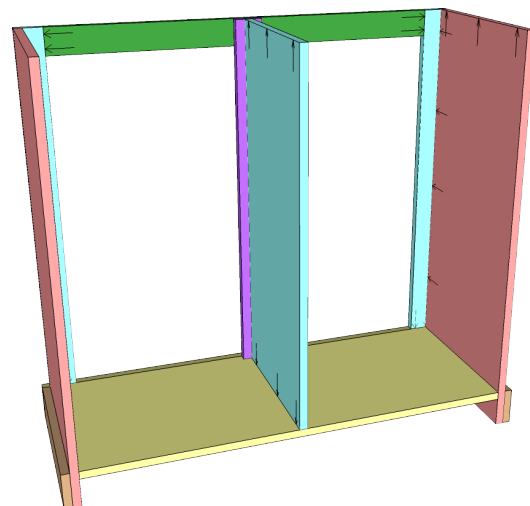



Add the shelves. One side should have two shelves spaced evenly and the other should be positioned to allow room for whatever you want to put on it. I spaced my shelf for my Keurig machine.

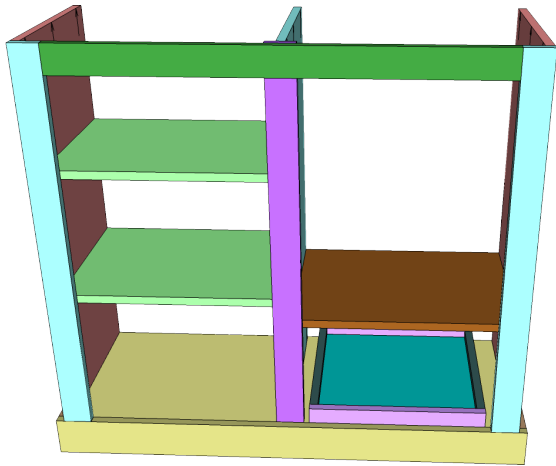
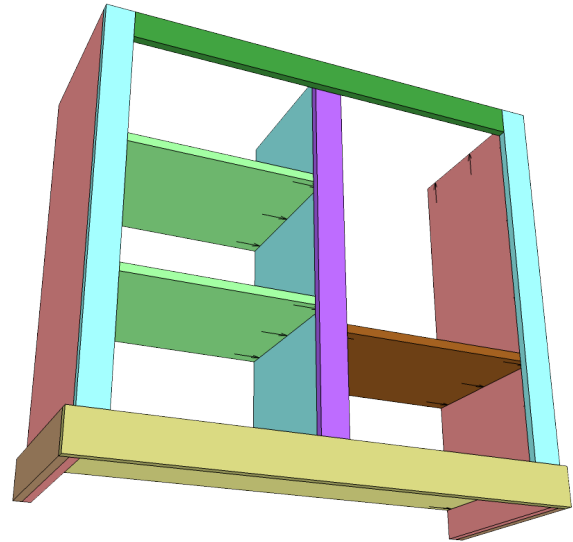

Assemble the shallow drawer and install it with drawer runners on the bottom. The drawer itself is nothing more than a piece of 3/4" plywood trimmed out with 1 x 2 strips. This plan calls for pocket holes on the bottom of the plywood but you can use brad nails if you want.

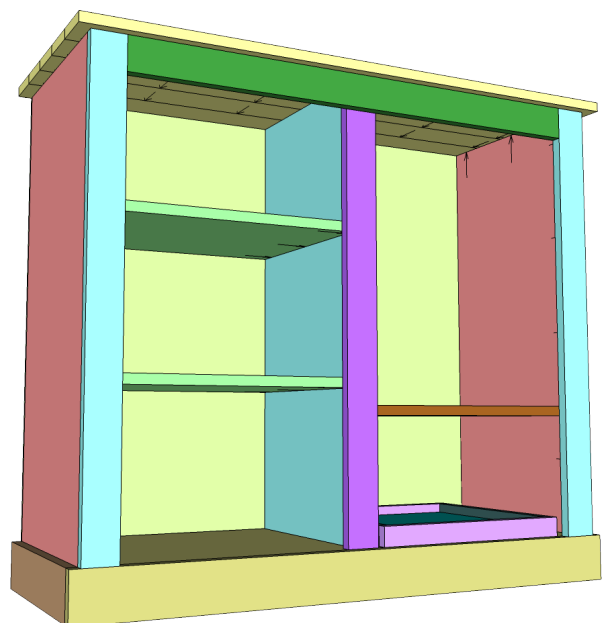

Use pocket hole screws to assemble the planked top. Then center it on the cabinet and attach it with pocket hole screws through the vertical sides and center divider. Attach your 1/4" plywood panel for the back with glue and brad nails.

10

Assemble both door frames with glue and pocket hole screws. Adjust your dimensions as needed. The measurements in this plan will leave a 1/8" spacing around the door. Before you attach the 1/2" hardware mesh sand and finish the door. Then staple the wire mesh to the inside of the door panels.

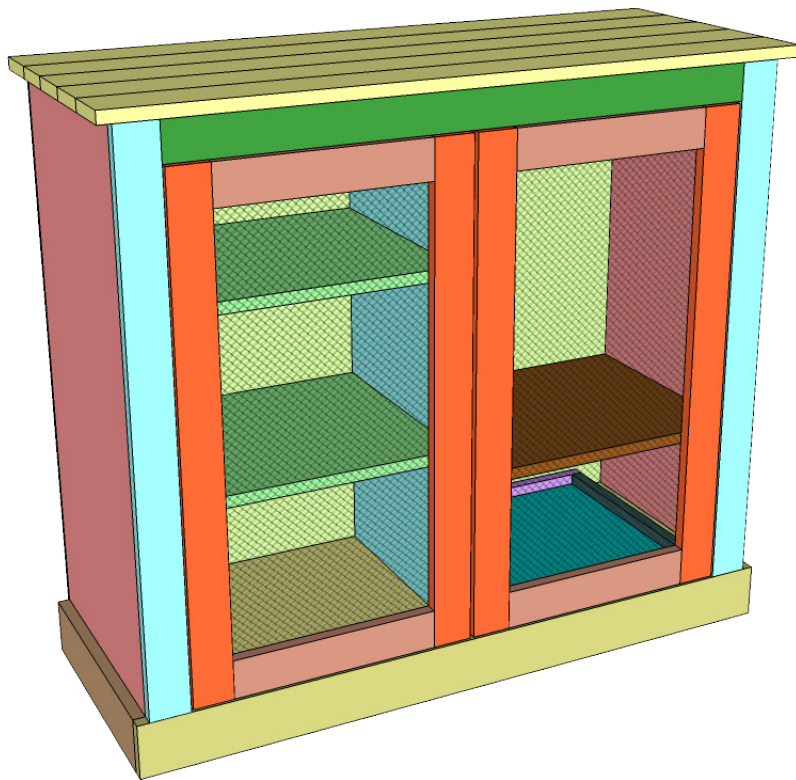
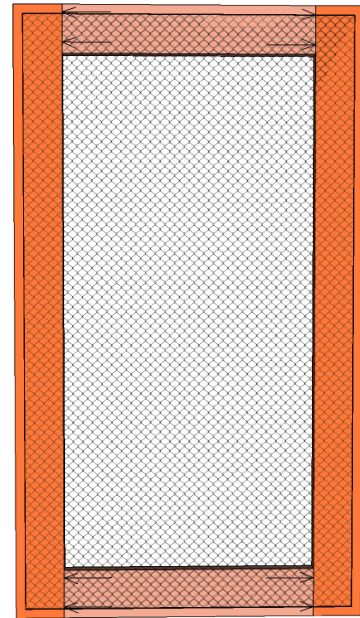

11

Fill any nail holes, sand, and apply your finish of choice. Then attach the doors to the cabinet with your decorative hinges. Add any door pulls you wish to use and personalize it however you wish. Make it look awesome! Be sure to stop by our website and let us know if you decided to make one of these super easy coffee cabinets.