

DIY Lounger

Copyright © 2015 Shanty-2-Chic.com

Supply List

Item	Quantity	Description
1 x 6 x 8'	3	Pine or whitewood board
1 x 4 x 8'	6	Pine or whitewood board
1 x 3 x 8'	1	Pine or whitewood board
2 x 4 x 21"	1	Pine or whitewood board
1-1/4" pocket hole screws	124	
1-1/4" wood screws	handful	
Wood glue		
Finish of choice		
Hinges		Either one pair or one 20" piano hinge for the back assembly and one hinge for the back support board.

Drill pocket holes for 1-1/4" screws as indicated by the arrows. It's always best to measure for your pieces and cut as you go.

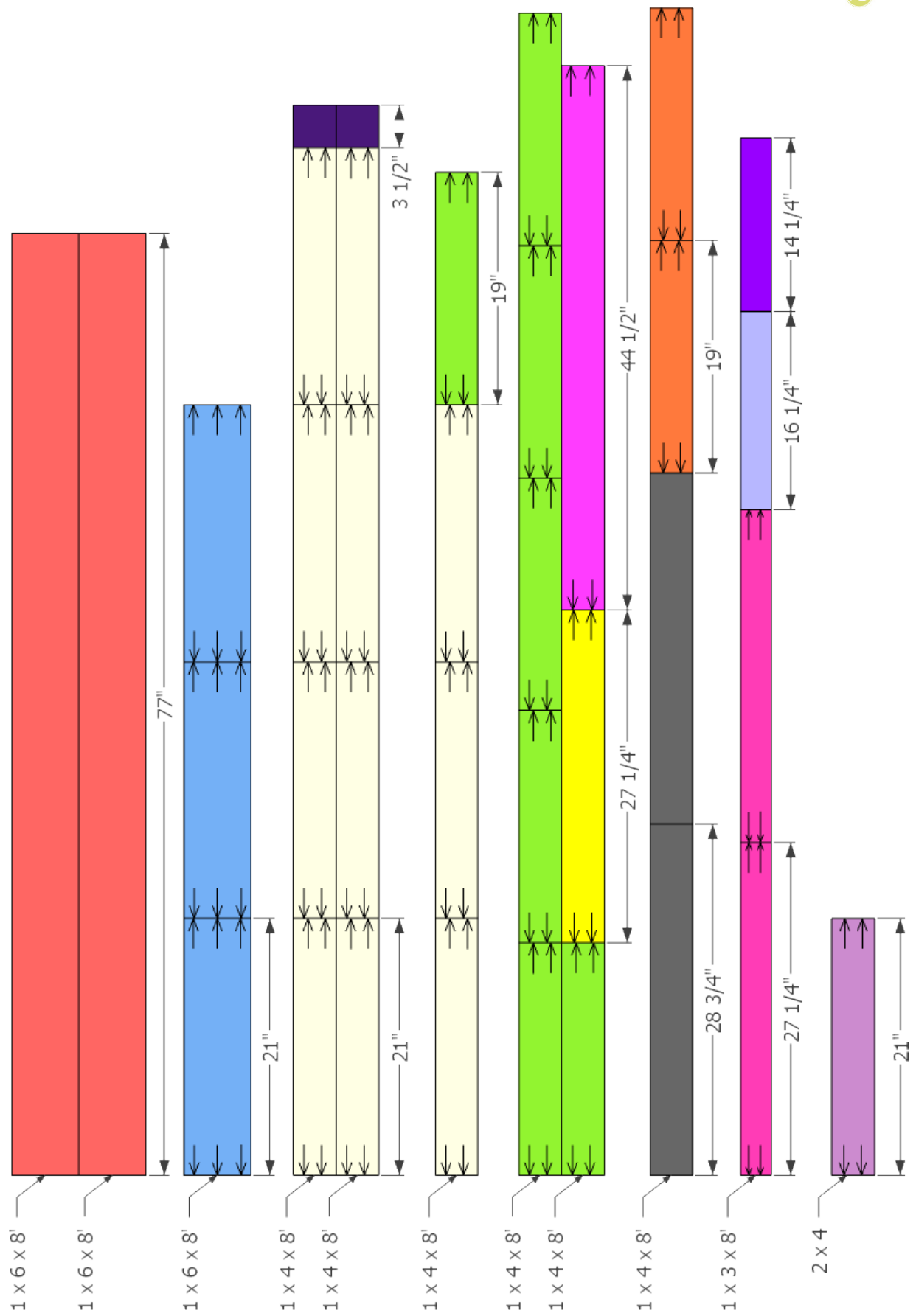

Exact measurements aren't critical. These cuts will establish a hand grab to lift the back rest.

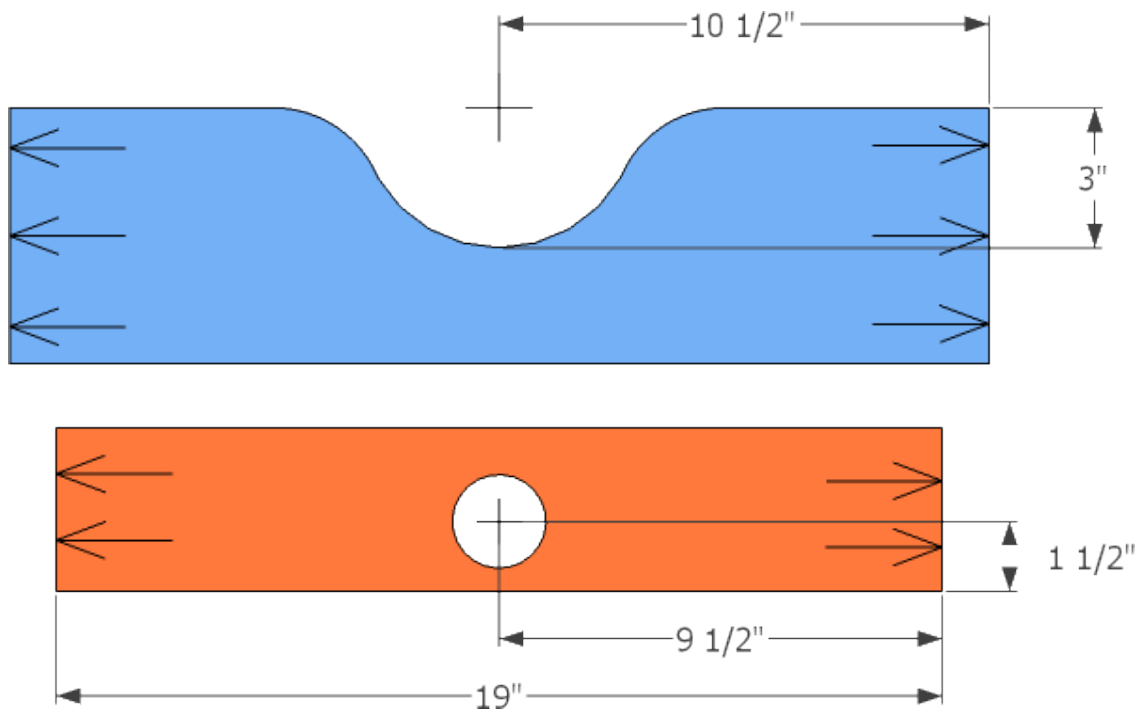

1

Use wood glue in every joint in this project. Use 1-1/4" pocket hole screws to assemble the large frame with the pocket holes on the inside. The large gap should be 44-1/2". You can use the long board from step 2 for spacing.

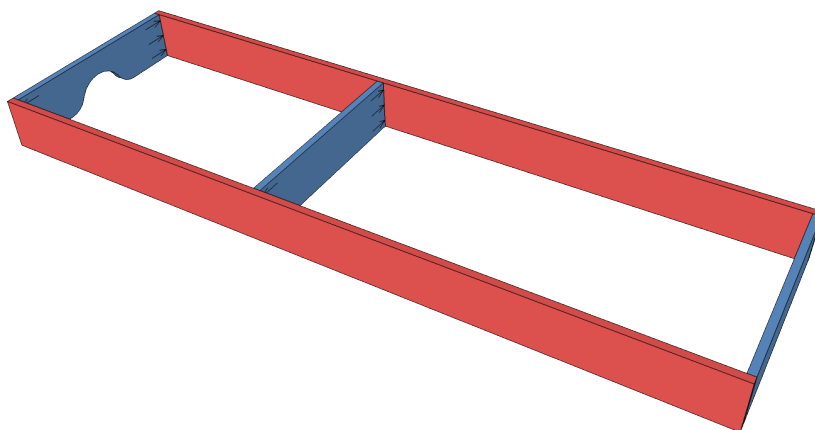

2

Both frames will be built upside down. First evenly space all of the seat slats and secure them with 1-1/4" pocket hole screws. Then add the center brace on top of with 1-1/4" pocket hole screws.

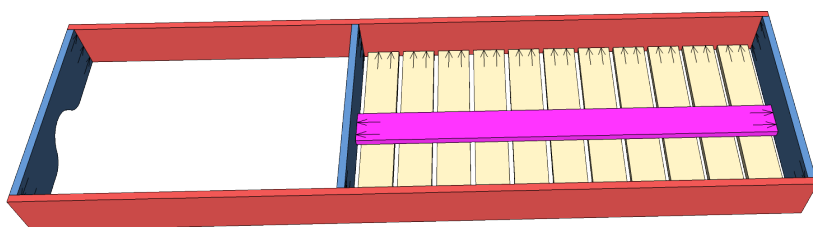

3

First drill a 2" hole centered left to right and 1-1/2" from the edge of one of the short frame pieces. Assemble the back frame with 1-1/4" pocket hole screws making sure the pocket holes are on the inside.

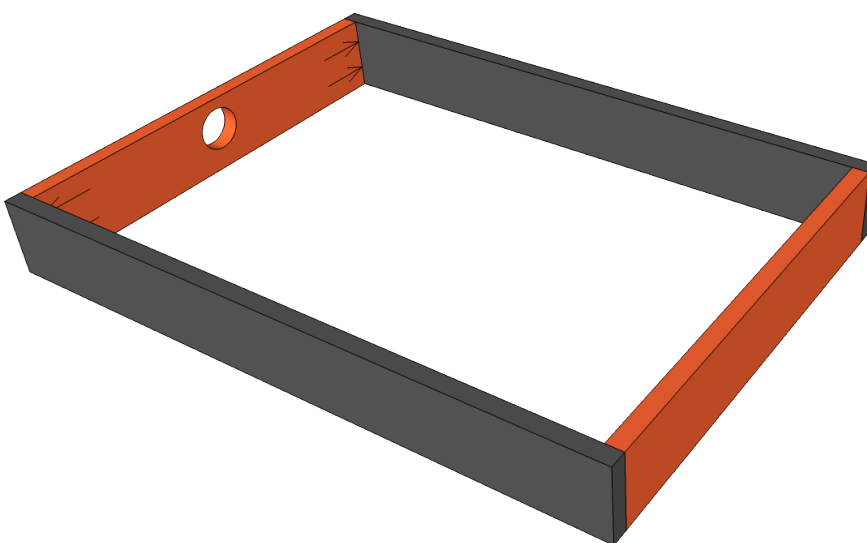

4

Add the back slats to the inside of the smaller frame with even spacing between boards. Make sure the hole in the frame is closest to the edge without the slats.

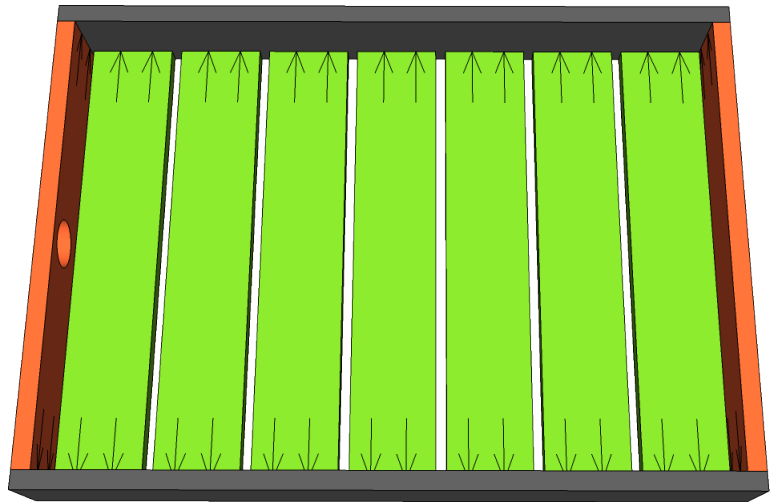

5

Assemble the back frame brace with wood glue and a couple 1-1/4" wood screws through the sides of the 1 x 3 boards. Pre-drill to prevent splitting.

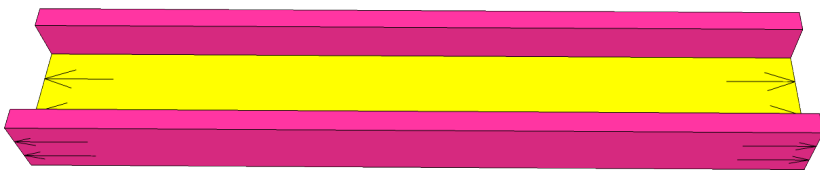

6

Attach the back brace to the inside of the frame touching the back of the back slats and secure it with 1-1/4" pocket hole screws into the frame where possible.

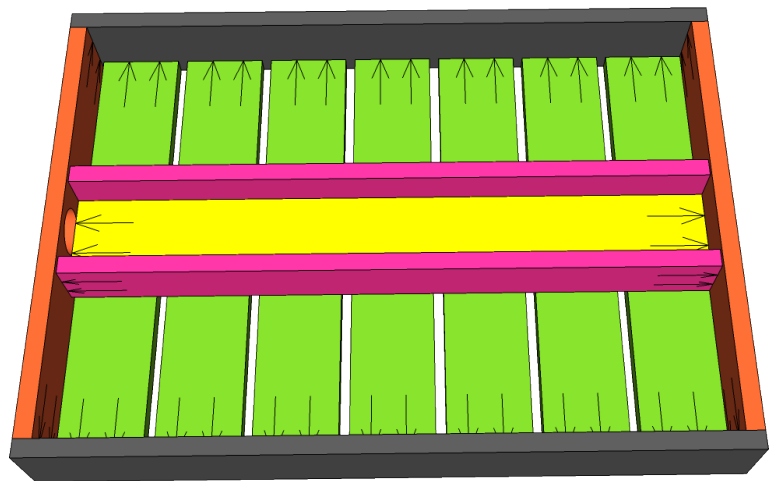



Pre-drill and add a couple stop blocks to the back of the back brace closer to the side with the hole with just a couple 1-1/4" wood screws. No glue just yet.

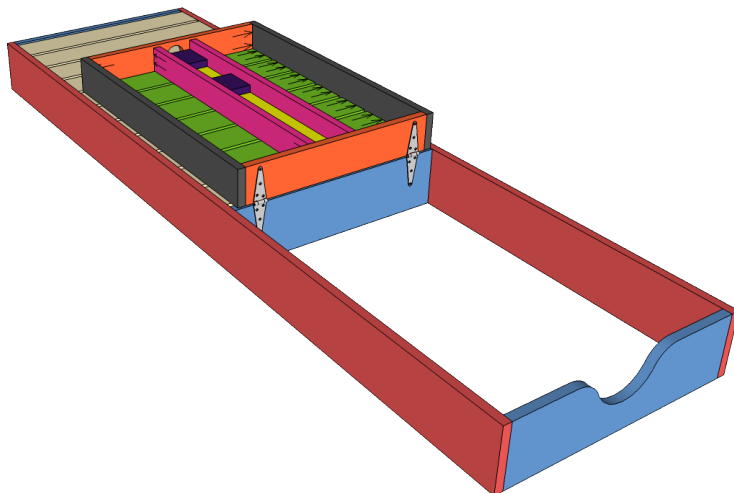
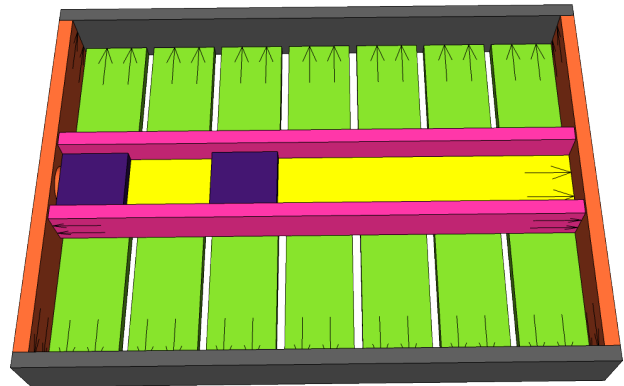

Place the back frame upside down on top of the large frame with the hinge sides touching each other. Install whichever hinges you chose to use making sure the center axis of the hinge is in between the two frame assemblies.

9

Cut a 45 degree miter on the end of the top 1 x 3 board as shown. Glue and screw it to a shorter 1 x 3 board. With the pocket holes on the 2x4 board facing down attach a hinge to the top of these boards.

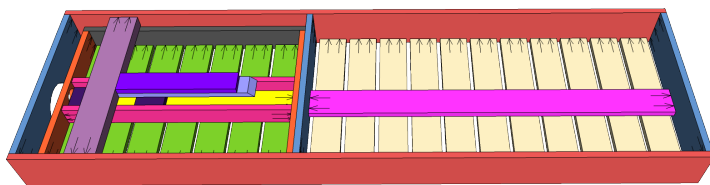
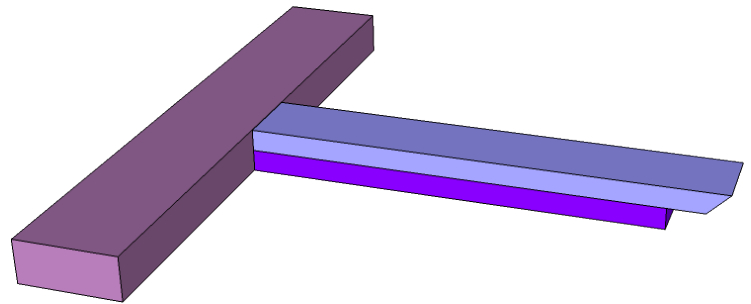

10

Flip the assembly over and attach the 2x4 board with the pocket holes facing up. Make sure the 2x4 board is resting on top of the back frame and about 5" from the end when securing it.

11

Flip the assembly back over and test the position of your back stops. Unscrew them and reposition as necessary. Once you find the spacing you prefer use wood glue and screws to permanently hold them in place.

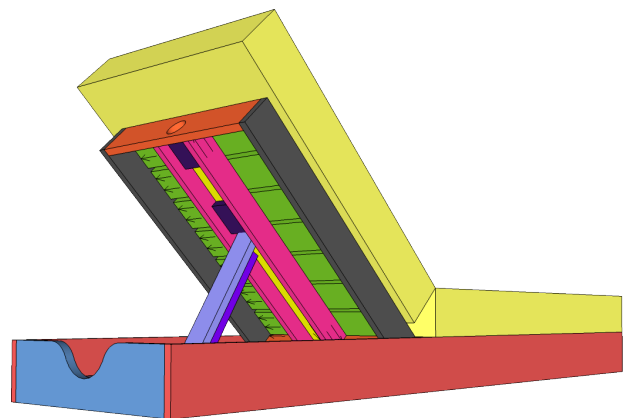

12

Finally sand and finish the lounger as you wish! As always, if you make one of these be sure to show it off in the Submit Your Project section on our website!!

