



©2016 WWW.SHANTY-2-CHIC.COM



BLANKET LADDER



SUPPLY LIST

Item	Quantity	Description
1x2x10	1	Pine
1x2x8	1	Pine
Washers	5	
Hex Screws	5	
1 1/4" brad nails		
wood glue		

Remember!

Many of these cuts are best made as you go. If you have questions, check out the tutorial on our site!



CUT LIST



1

First, make all of your cuts. Then, lay the two side pieces on the ground and lay the longest rung on top of the side pieces. The rung should be 5" from the bottom of the side pieces. The bottom corners of the rung should be flush with the outside of the side pieces and the top corners should overhang $\frac{1}{8}$ ". Doing this will give the ladder the triangle shape. Attach the rung with $1 \frac{1}{4}$ " brad nails and wood glue.

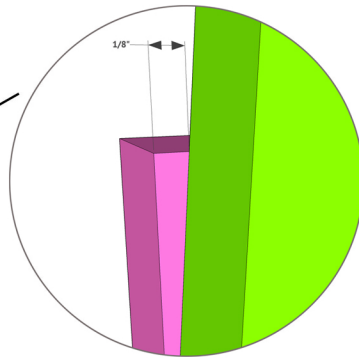
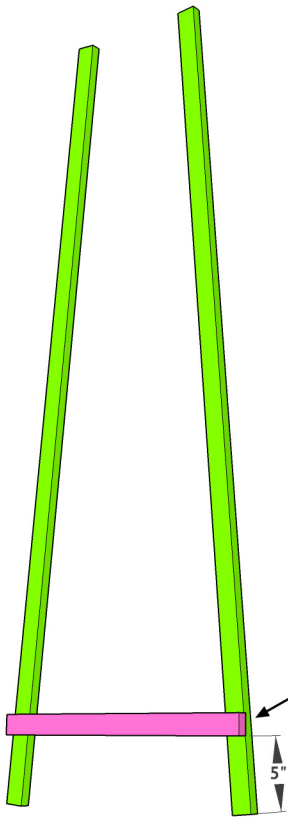

2

Now, attach the second rung, the same exact way as you attached the first rung.

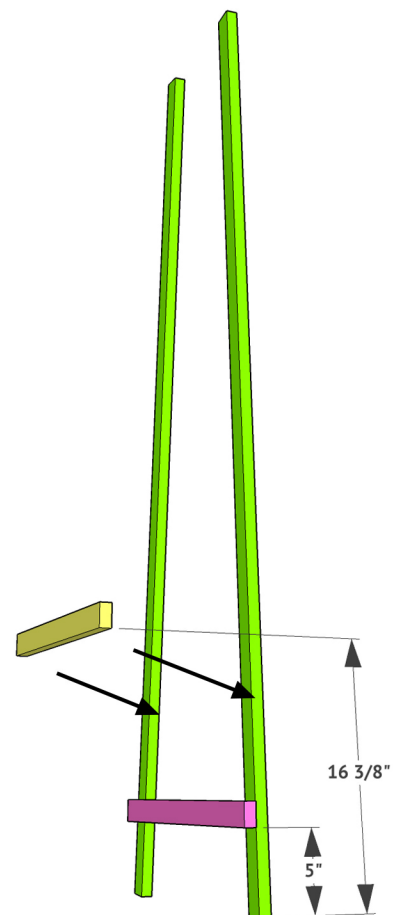

3

Attach the remaining rungs the same way. Note the placement in this image.

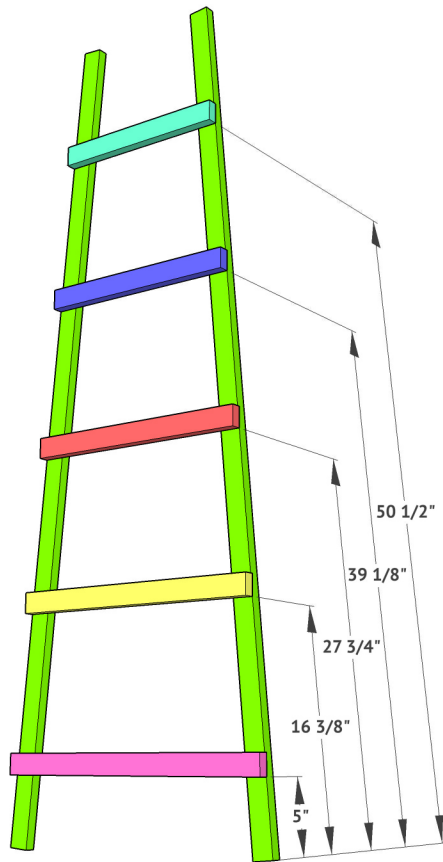

4

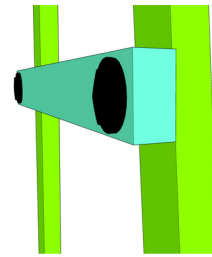

Now, using your drill, attach a washer and hex screw to the ends of each rung. You can spray paint them or leave them silver.

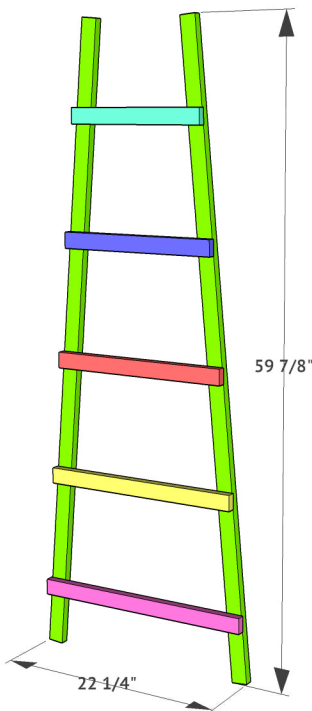

All finished! Now you can paint or stain it to get the look you want. Be sure to send us pictures of your new builds or share them on social and use #shanty2chic so we can share them too!