



©2016 WWW.SHANTY-2-CHIC.COM



# RUSTIC CENTERPIECE CRATE

## SUPPLY LIST

Item	Quantity	Description
1x8x6	1	pine or whitewood
1x2x8	1	pine or whitewood
1x2x6	1	pine or whitewood
1/2" dowel	4"	
wood glue		
1.25" brad nails		

*Remember!*

Many of these cuts are best made as you go. If you have questions, check out the tutorial on our site!



## CUT LIST

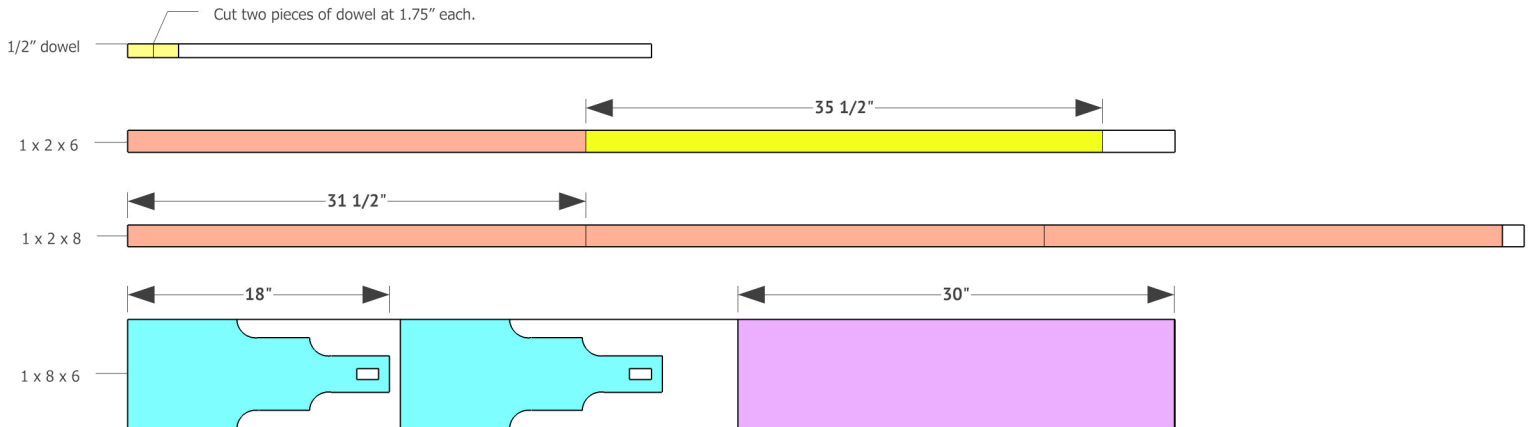

**x2**

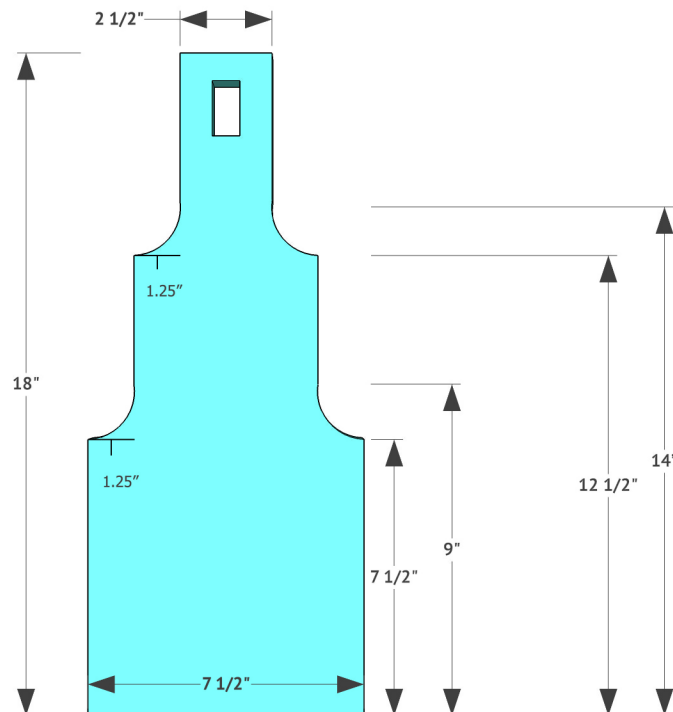

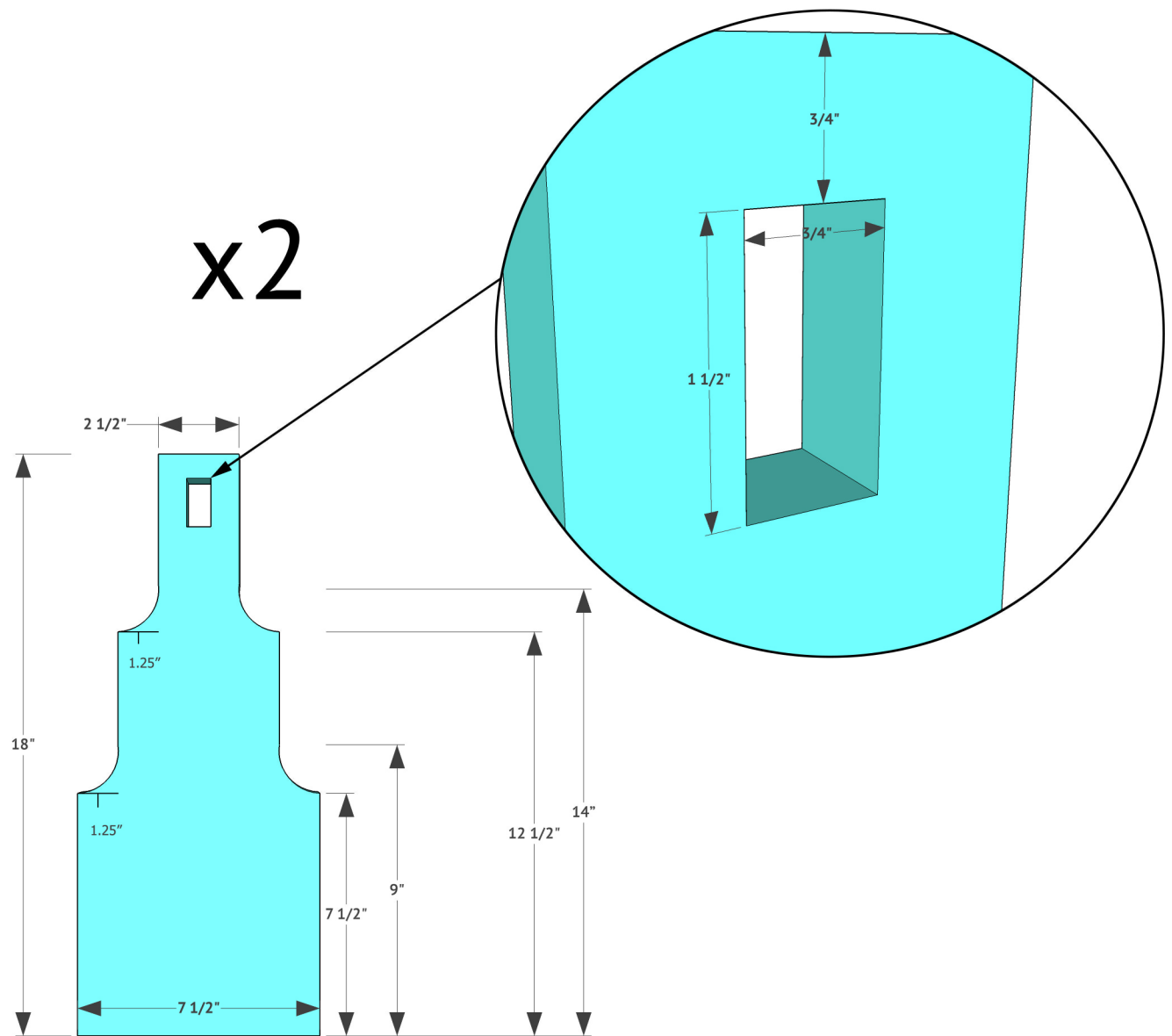

1

You will make 2 sides like the one above. This is a reference guide to help you trace your sides. We suggest tracing and cutting one side and then using that side to trace and cut your next side.

2

Now attach the first side to the bottom board. Attach the bottom of the side to the side of the bottom board using wood glue and 1.25" brad nails.

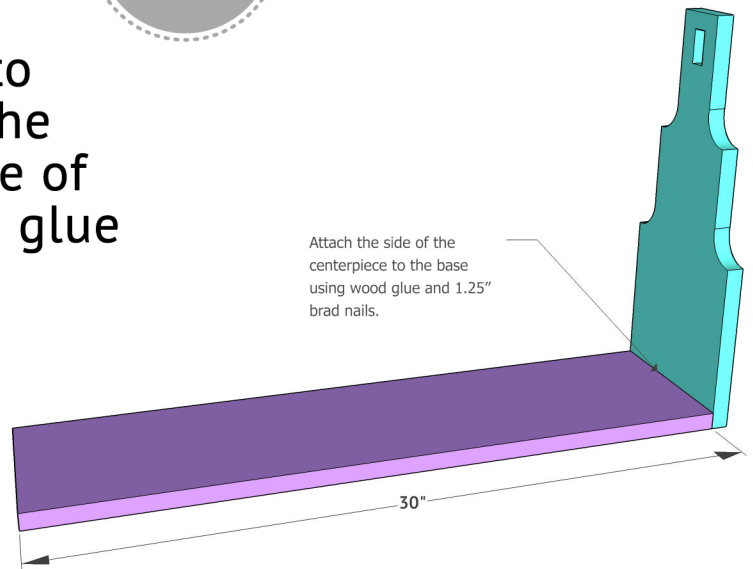

3

Attach the other side using wood glue and 1.25" nails.

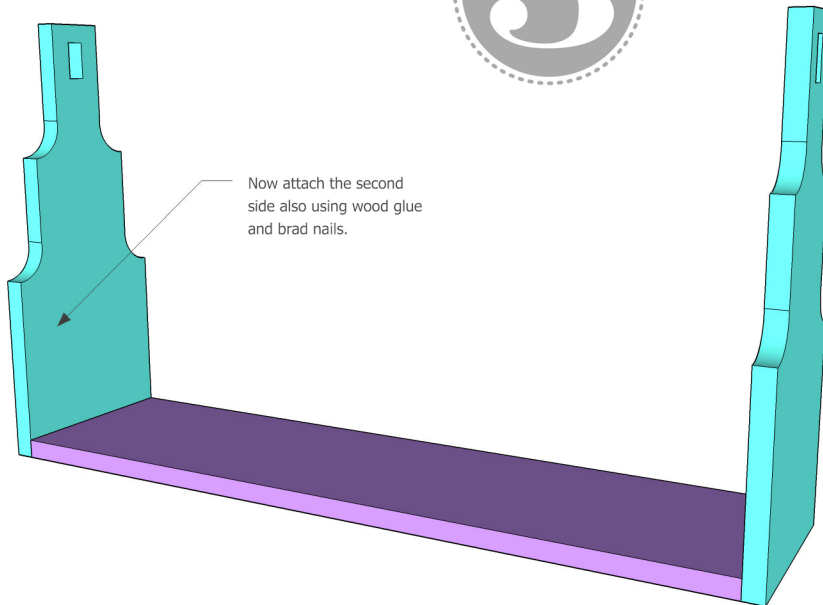

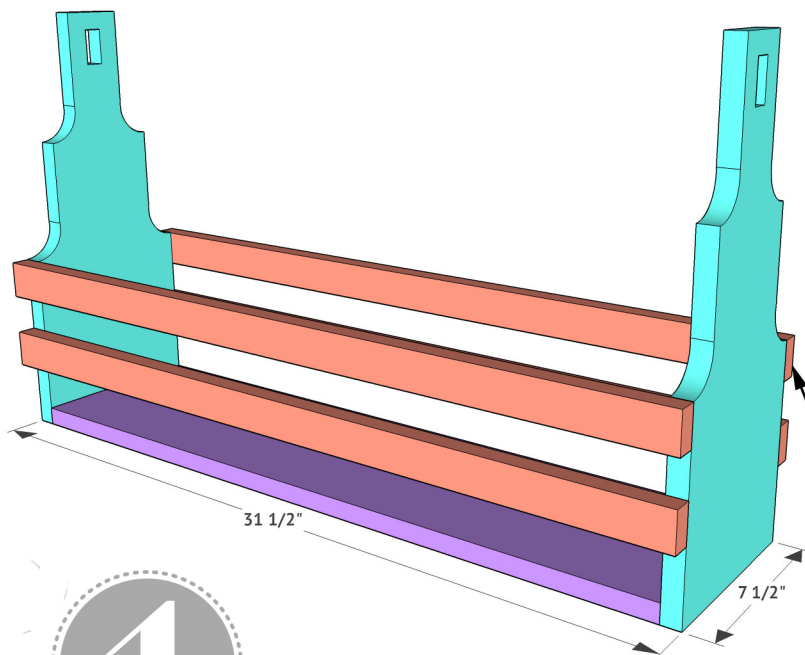

4

Use wood glue and 1.25" brad nails to attach the 1x2 boards to the sides of your centerpiece.

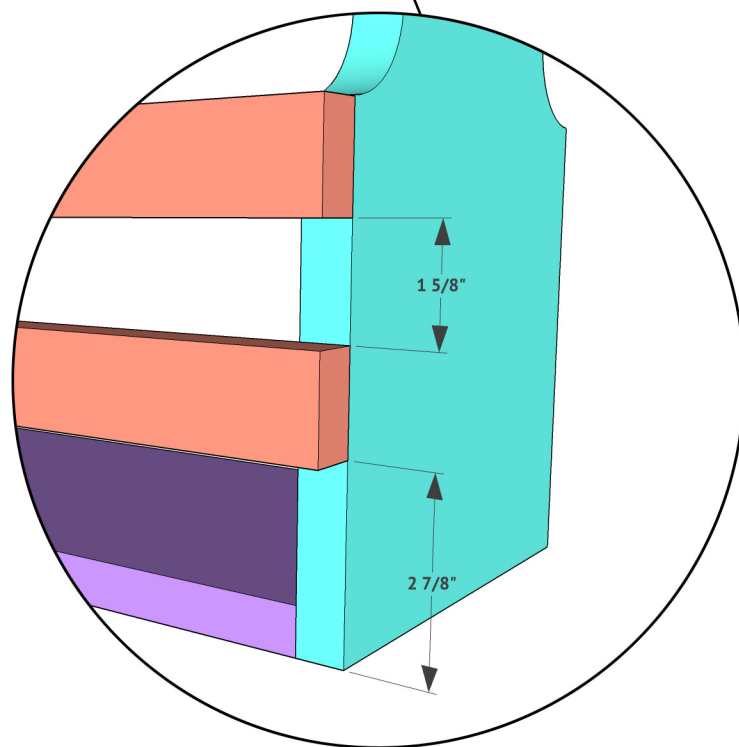

Final step is to run the 1x2 board through the holes that were cut at the top of the side boards. Once that board is through both sides, push the small dowel pieces into place to hold the handle on.

5

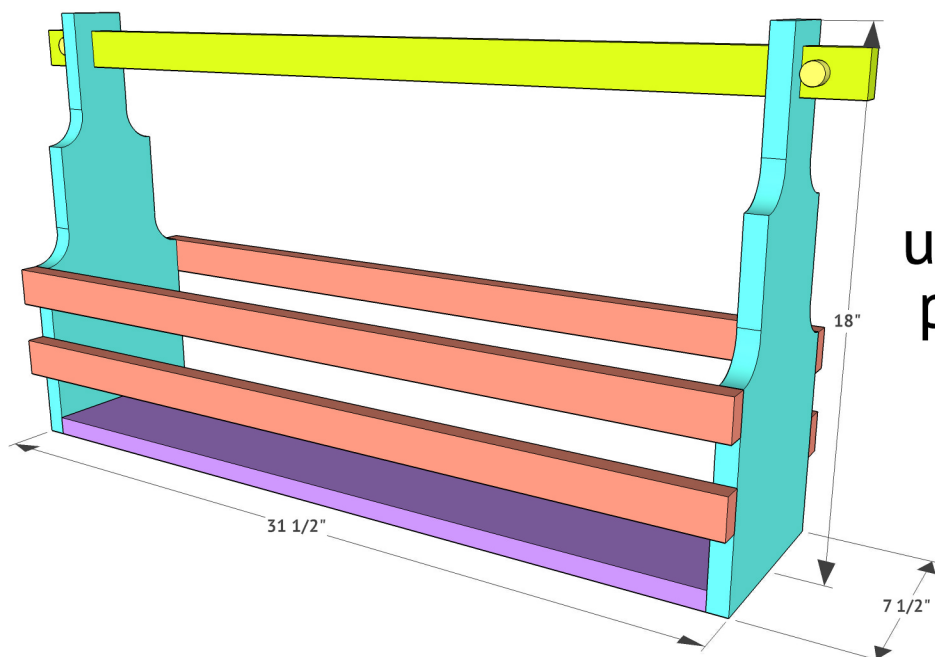
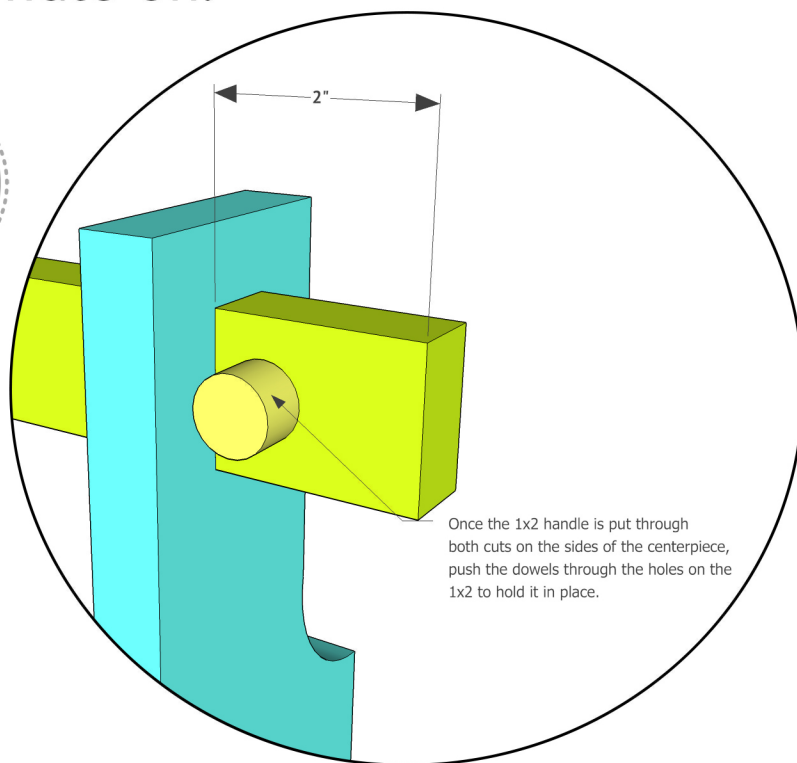

Be sure to tag us on your finished projects! We love seeing and sharing them!