



©2017 WWW.SHANTY-2-CHIC.COM

BIG KID PLAY KITCHEN



BUILD STEPS

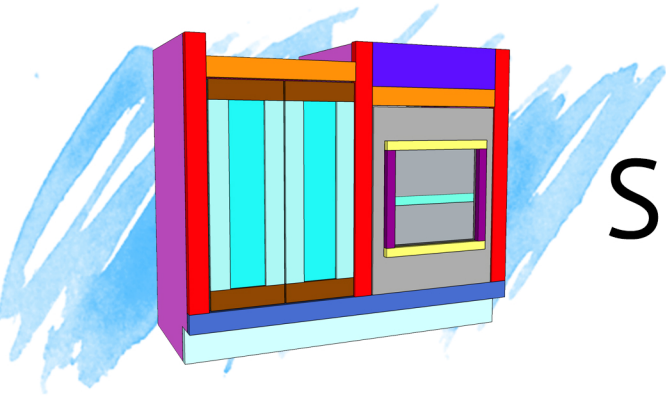

Sink and Oven Build

1

Cut the side pieces and shelves to size. Drill $\frac{3}{4}$ " pocket holes into both sides of the shelves. Attach the shelves to one side, then the middle and finally the other side. Use $1\frac{1}{4}$ " pocket hole screws and wood glue.

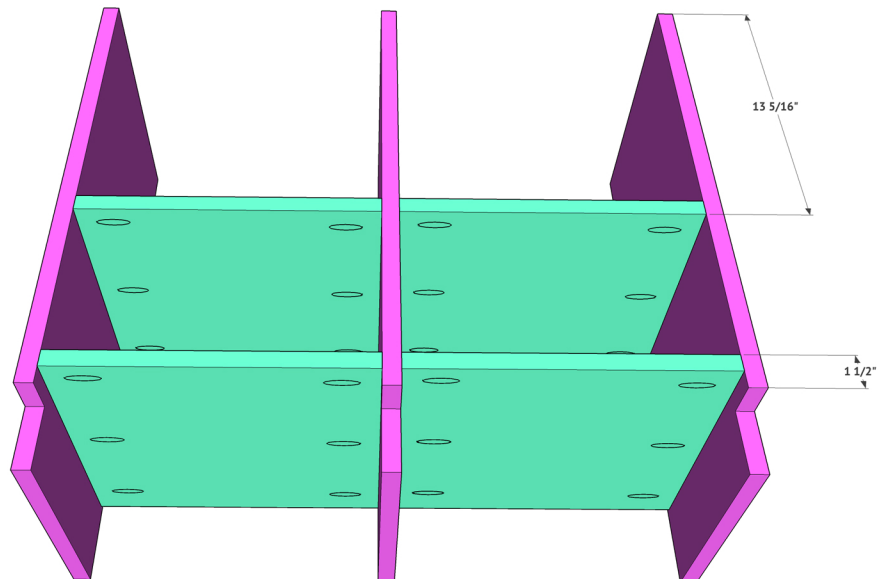
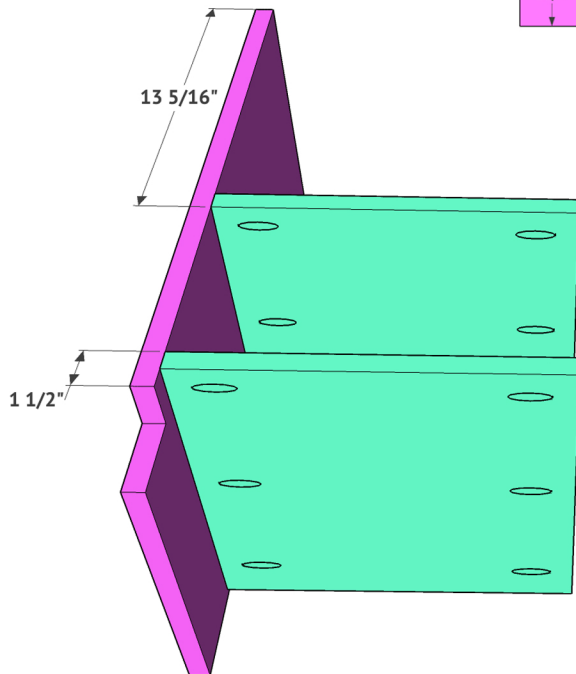

2

Cut the bottom, base frame pieces to size and drill $\frac{3}{4}$ " pocket holes into both ends. Attach them to the side and middle cabinet pieces with $1 \frac{1}{4}$ " pocket hole screws and wood glue.

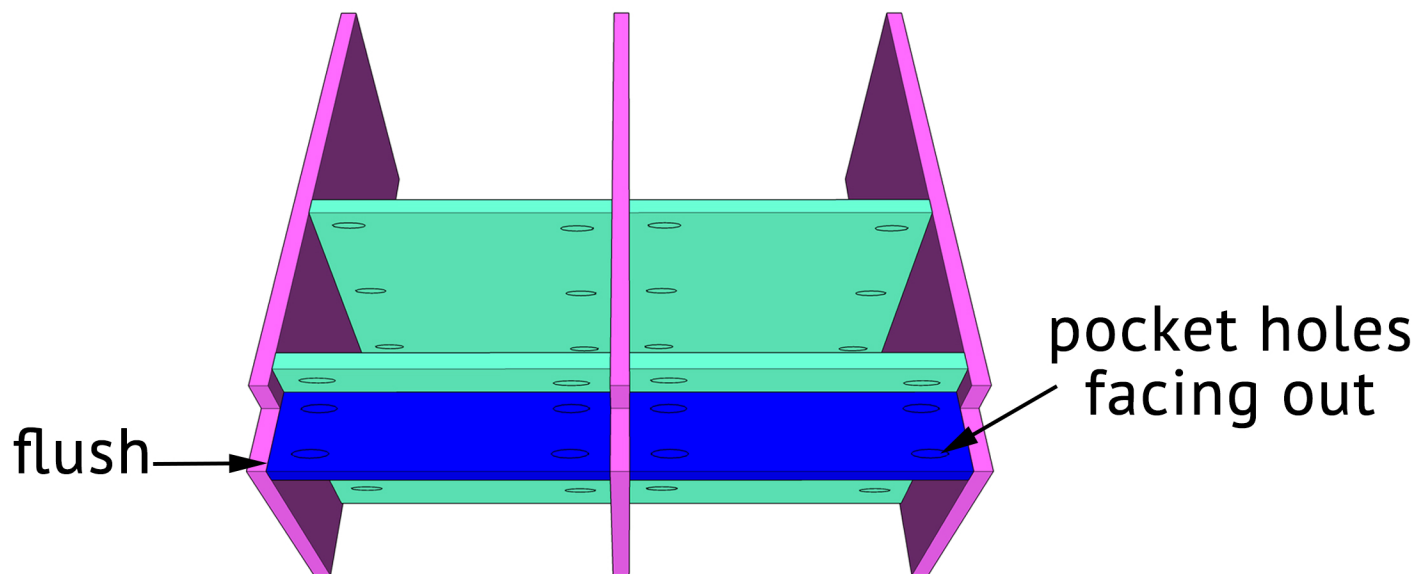

3

Cut the toe kick to size and notch out $\frac{3}{4}$ "x $\frac{3}{4}$ " squares to allow for the side and middle cabinet pieces. Attach the toe kick to the base frame with $1 \frac{1}{4}$ " brad nails and wood glue.

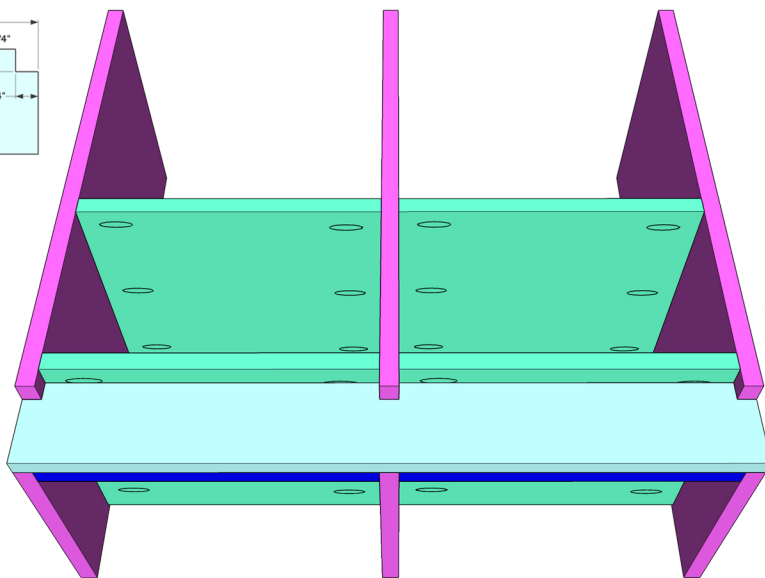
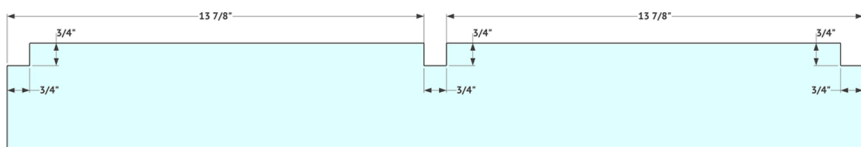

4

Cut the face frame pieces to size. Drill $\frac{3}{4}$ " pocket holes at one end of each vertical piece and both ends of the top and middle pieces. Attach them together with $1\frac{1}{4}$ " pocket hole screws and wood glue. Cut the oven door closure block to size, center it on the face frame and attach it with $1\frac{1}{4}$ " brad nails and wood glue.

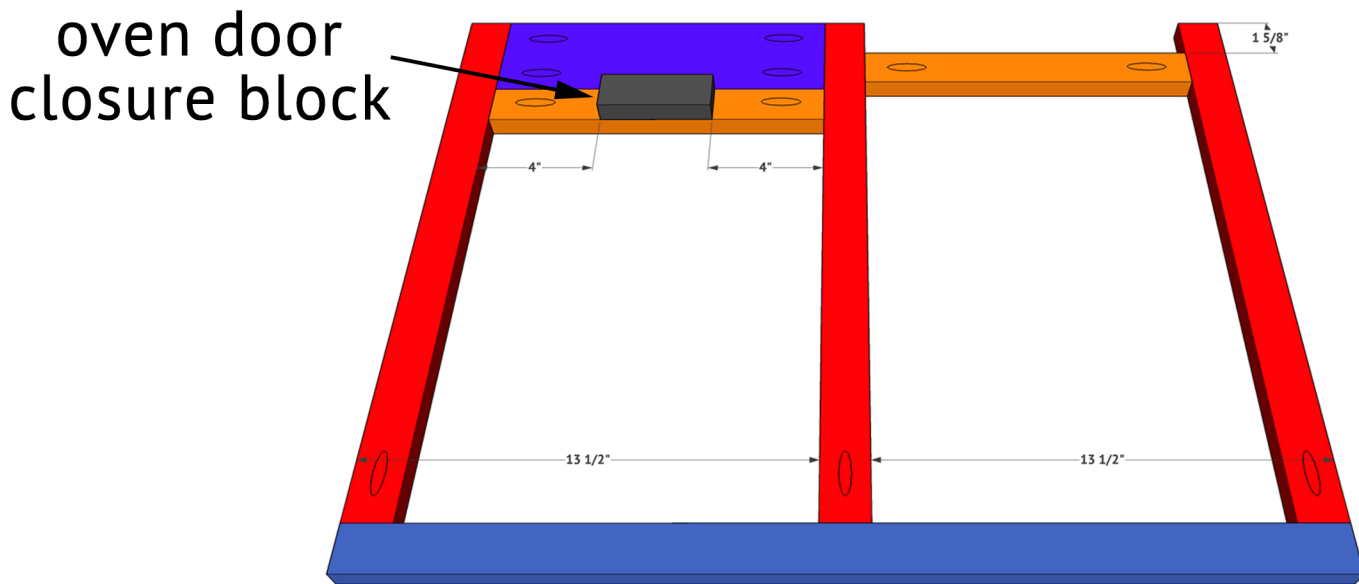

5

Attach the face frame to the front of the cabinet with $1\frac{1}{4}$ " brad nails and wood glue. The top of the face frame should be flush with the top of the cabinet.

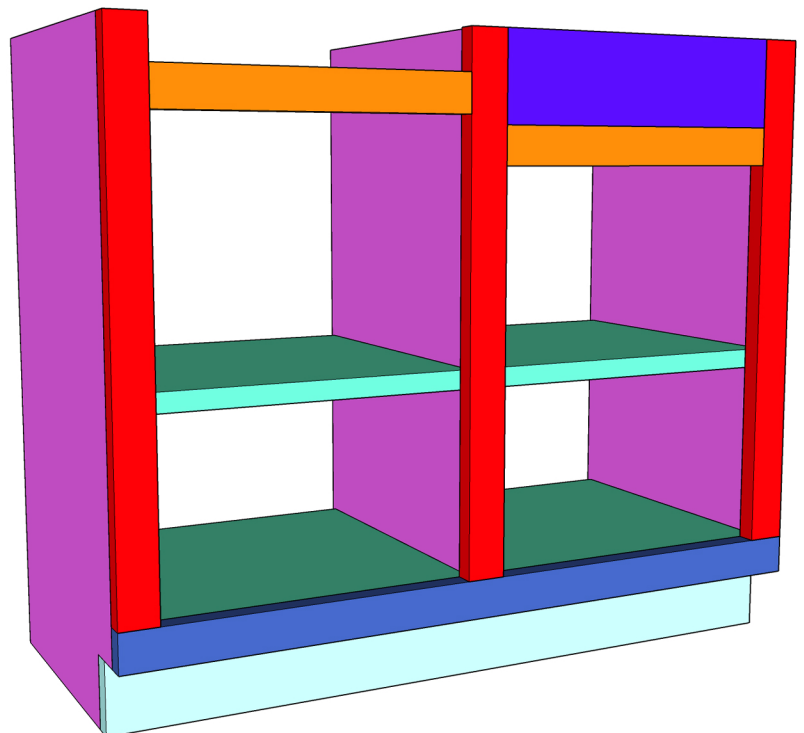



Cut the back support pieces to size and drill $\frac{3}{4}$ " pocket holes at both ends of each piece.

Attach them $\frac{1}{4}$ " from the back of the cabinet to allow for the backing. Attach them with $1 \frac{1}{4}$ " pocket hole screws. The support on the sink side should be attached $1 \frac{1}{2}$ " from the top of the cabinet to allow for the faucet. *Note: Do not use wood glue on the sink back support until after you attach the faucet.*

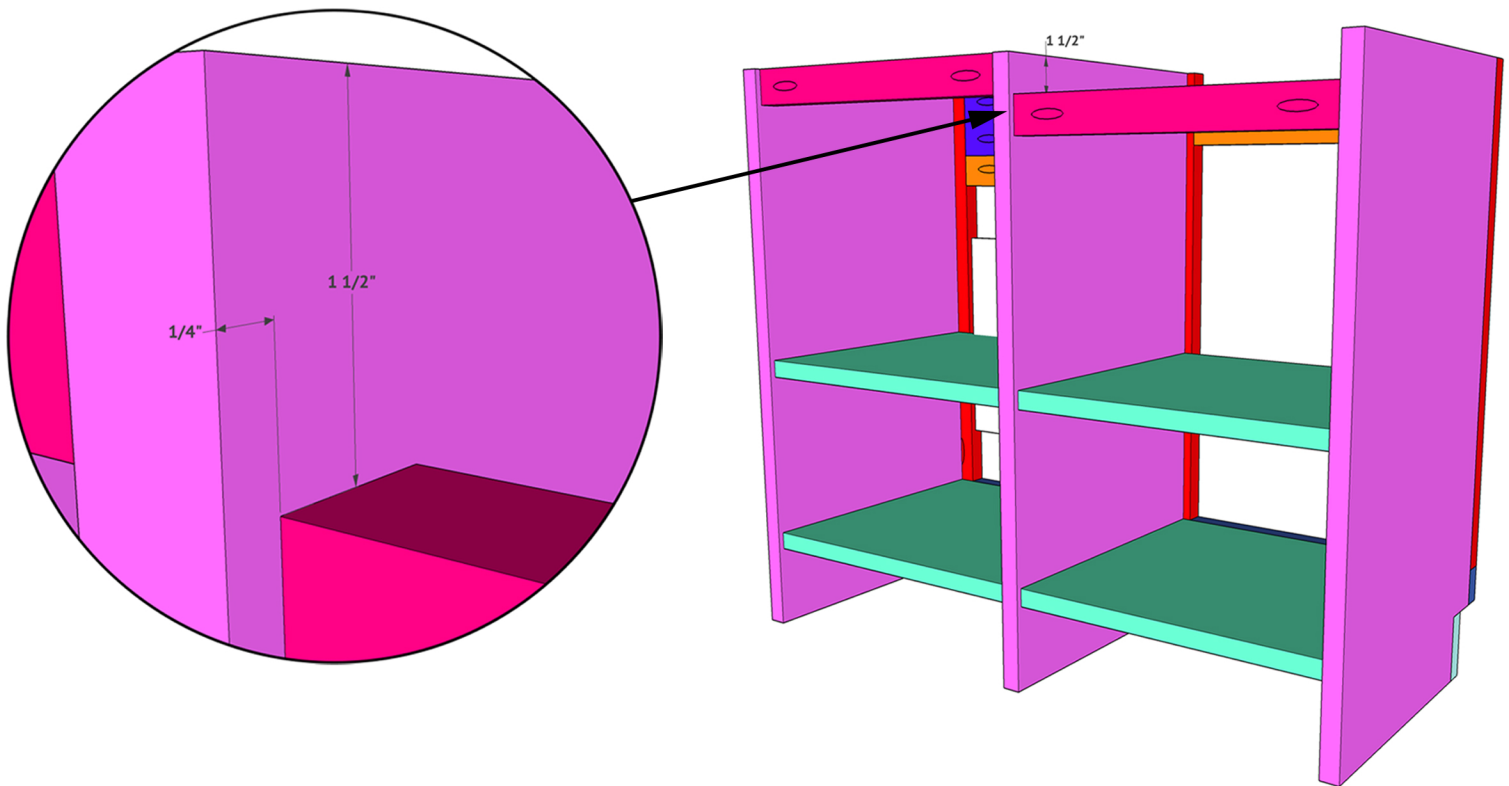



Cut the sink support to size and drill $\frac{3}{4}$ " pocket holes at each end. Attach it to the sink side of the cabinet with $1\frac{1}{4}$ " pocket hole screws and wood glue. It should sit 7" from the front of the cabinet panel, 2" from the back and $1\frac{5}{8}$ " from the top.

front

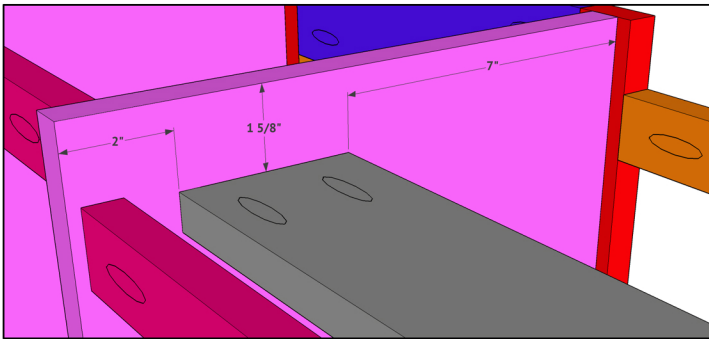

back

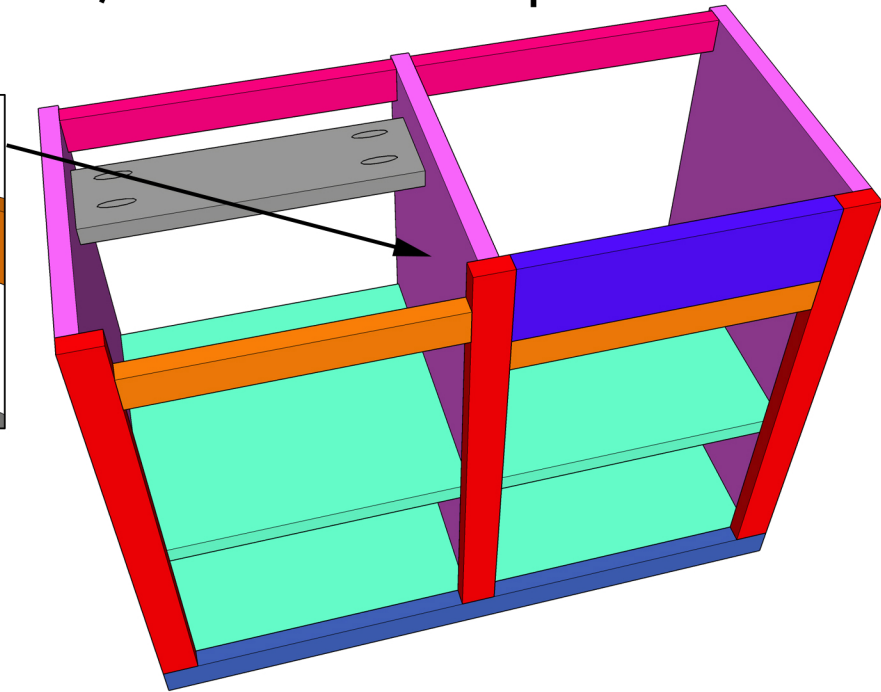

Cut the sink door planks to size. Then, measure and cut the $\frac{1}{4}$ " trim to size. Attach the trim to the plywood planks with $\frac{5}{8}$ " pin or brad nails and wood glue. Build two doors.

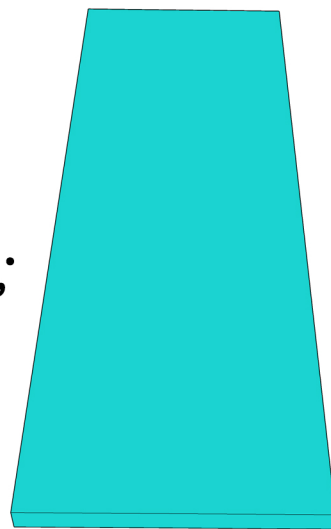

x2

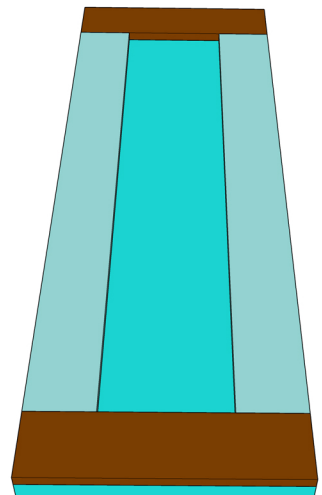

9

Cut the oven door to size and cut out a 9"x8" square with a jig saw. Cut the plexiglass, with a miter saw, to size and attach it to the back of the oven door with 3/4" multi-use screws in each corner. Cut the oven door trim to size. Attach the vertical pieces to the horizontal pieces with 7/8" brad nails. Center the trim assembly over the front of the door, so that the trim covers the jigsaw cuts. Attach to the door with 7/8" brad nails and wood glue.

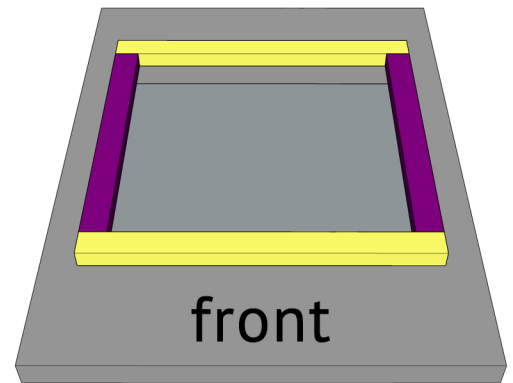
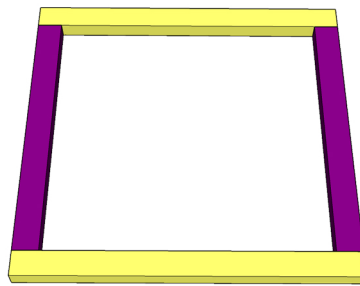
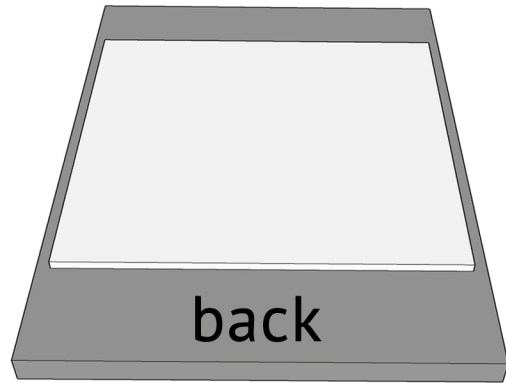

10

Attach the sink and oven doors to the cabinet with hinges.

Note: I waited to attach the doors after I painted.

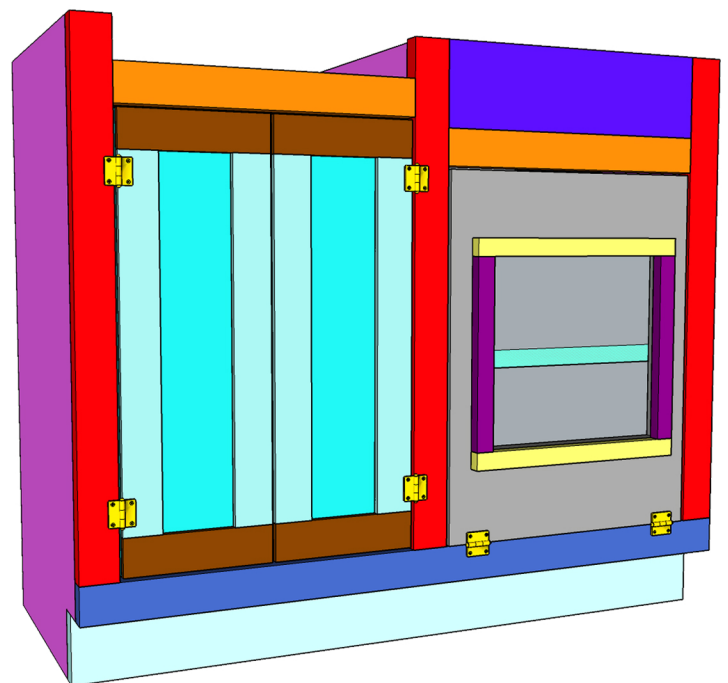

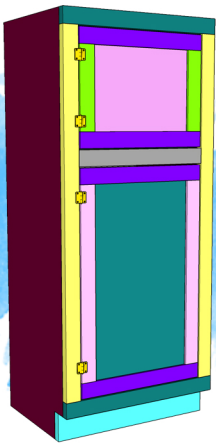

Refrigerator Build



Cut the refrigerator sides and shelves to size. Drill $\frac{3}{4}$ " pocket holes into the sides of each shelf. Attach the shelves to the refrigerator sides with $1 \frac{1}{4}$ " pocket hole screws and wood glue.



notch out with
jigsaw

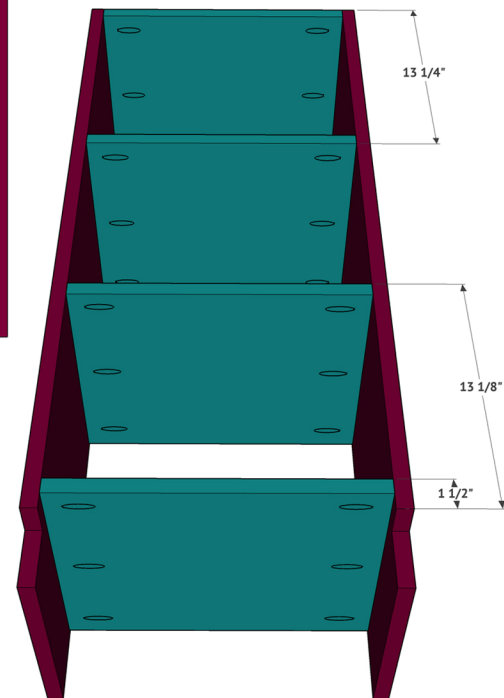

2

Cut the refrigerator base, frame piece to size and drill $\frac{3}{4}$ " pocket holes into each end. Attach the base piece to the refrigerator sides with $1\frac{1}{4}$ " pocket hole screws and wood glue.

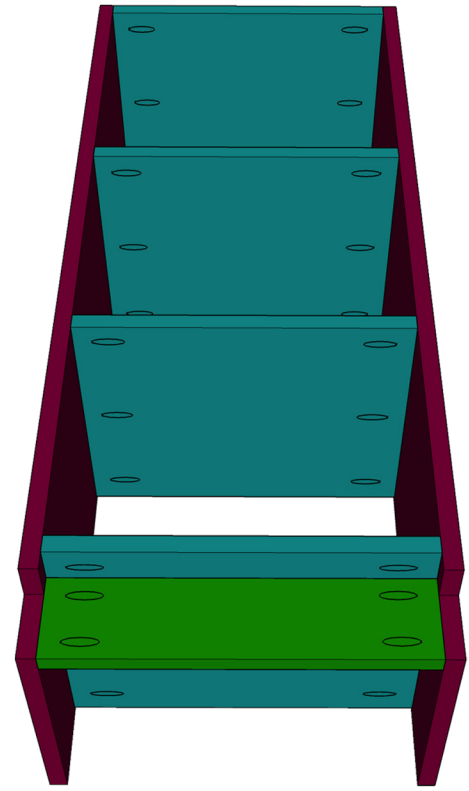

3

Cut the refrigerator toe kick to size and cut out $\frac{3}{4}$ " notches at each corner. Attach the toe kick piece to the refrigerator base frame with $1\frac{1}{4}$ " brad nails and wood glue.

notch with a jigsaw

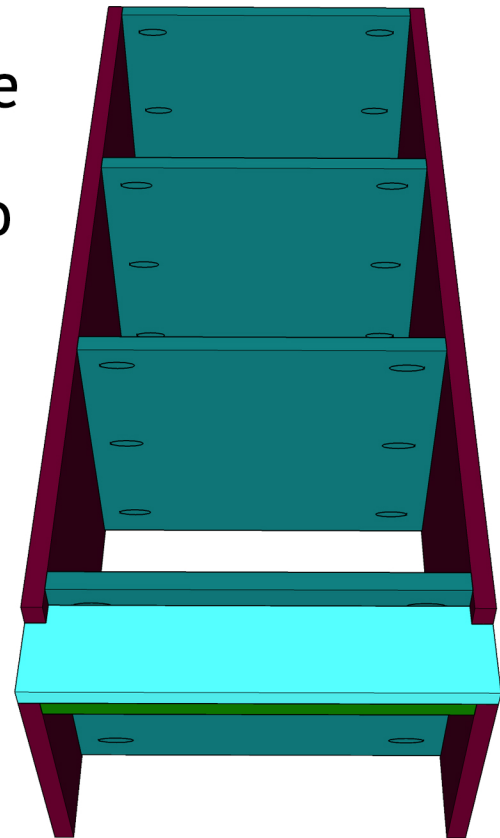

4

Cut the refrigerator face frame pieces to size and drill $\frac{3}{4}$ " pocket holes at each end of the vertical pieces and each end of the middle piece. Attach them together with $1\frac{1}{4}$ " pocket hole screws and wood glue.

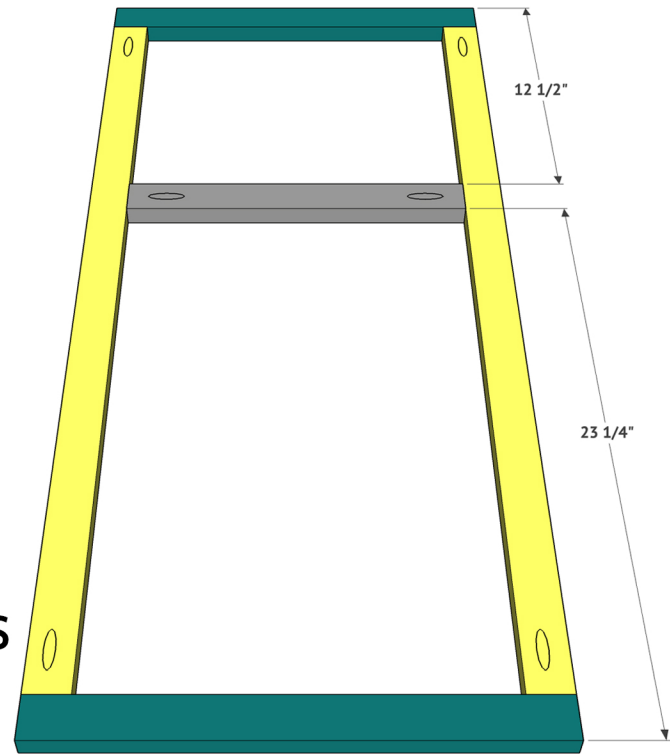

5

Attach the face frame to the cabinet with $1\frac{1}{4}$ " brad nails and wood glue. The face frame should be flush with all edges of the cabinet.

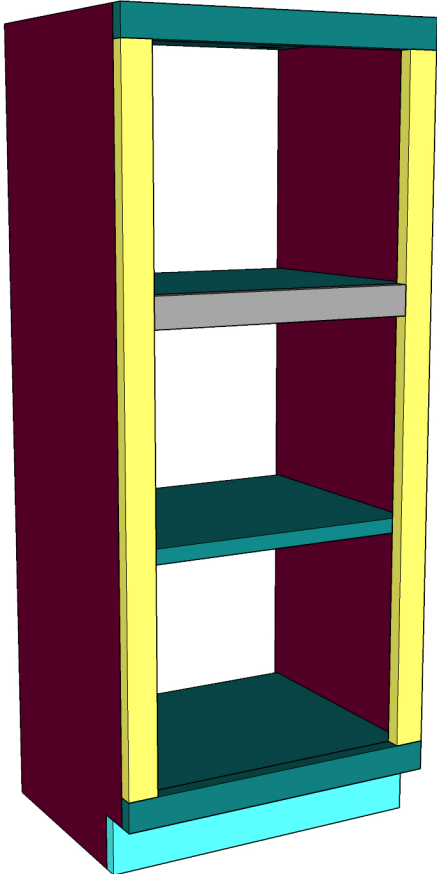



Cut the refrigerator doors to size. Then, measure and cut the trim to fit. Attach the trim to the doors with 5/8" pin or finish nails and wood glue.

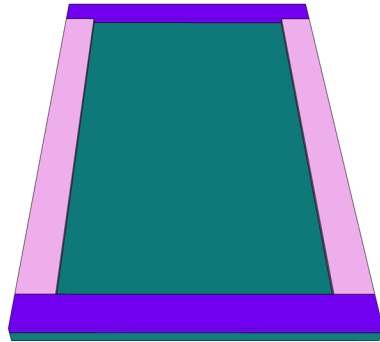
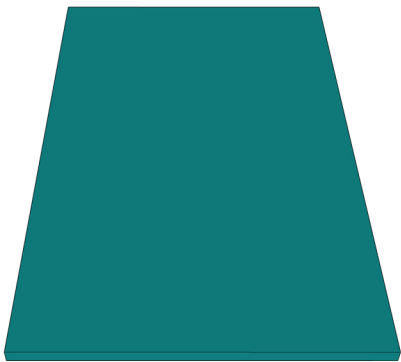

bottom door

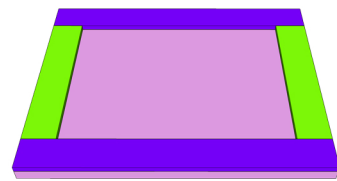

top door



Attach the doors to the refrigerator with hinges.

Note: I attached the doors after painting.

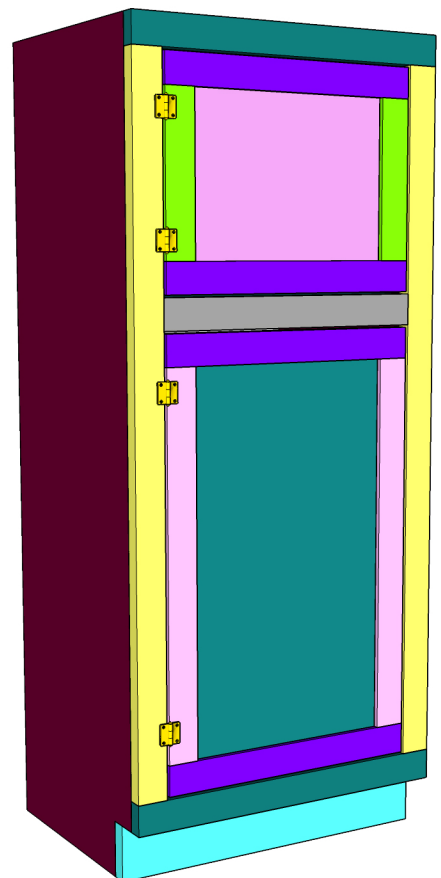

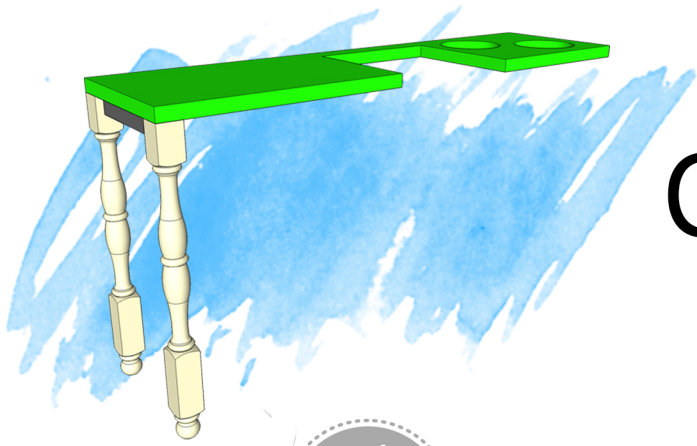

Countertop Build

1

Cut the legs and the apron piece down to size. Drill $\frac{3}{4}$ " pocket holes in each end of the apron piece. Center the apron piece on each leg and attach it to the legs with $1 \frac{1}{4}$ " pocket hole screws and wood glue.

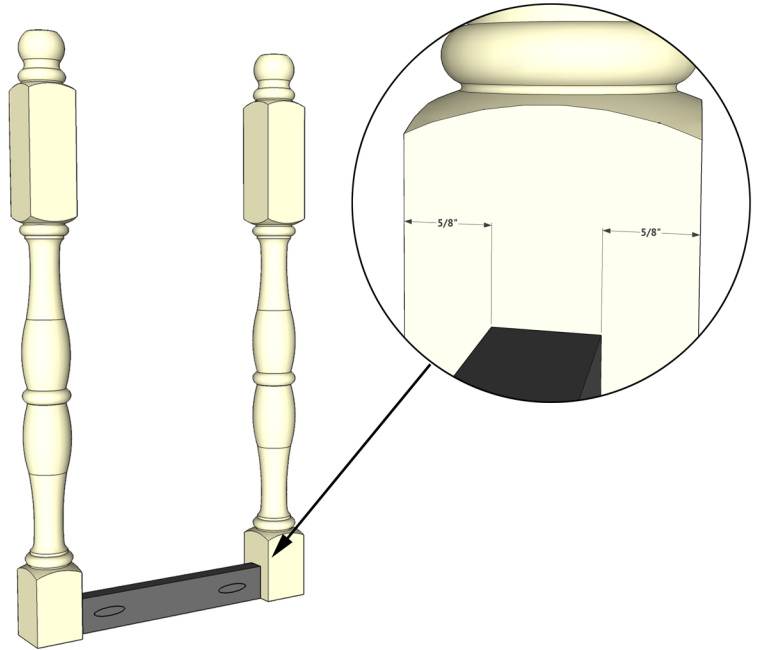

2

Cut the countertop to size and cut out a spot for each burner and the sink with a jig saw. Attach the leg assembly to the countertop with $2 \frac{1}{2}$ " wood screws, from the top of the countertop and into the legs.

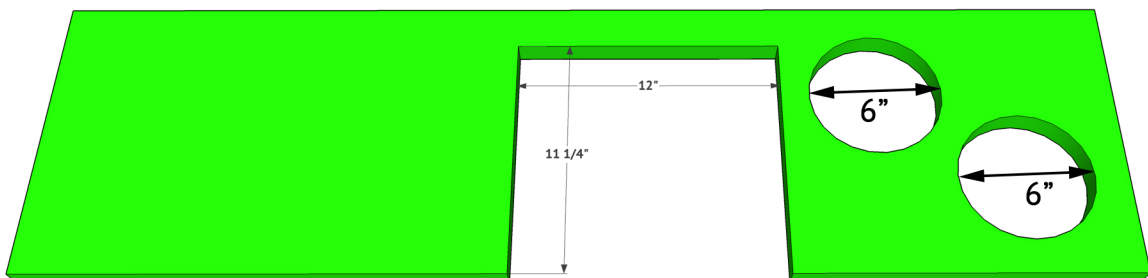

3

Attach the countertop to the sink base with 1 1/4" brad nails.

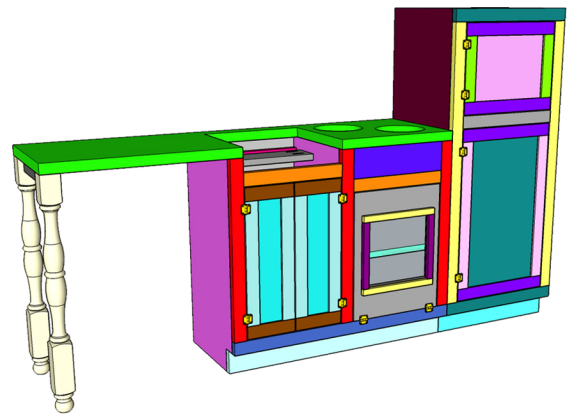

4

Add a finish, then attach the sink burners, knobs and pulls! When all of the accessories are attached, attach the back panels with 3/4" staples and wood glue, from the back panels and into the shelves and back supports.

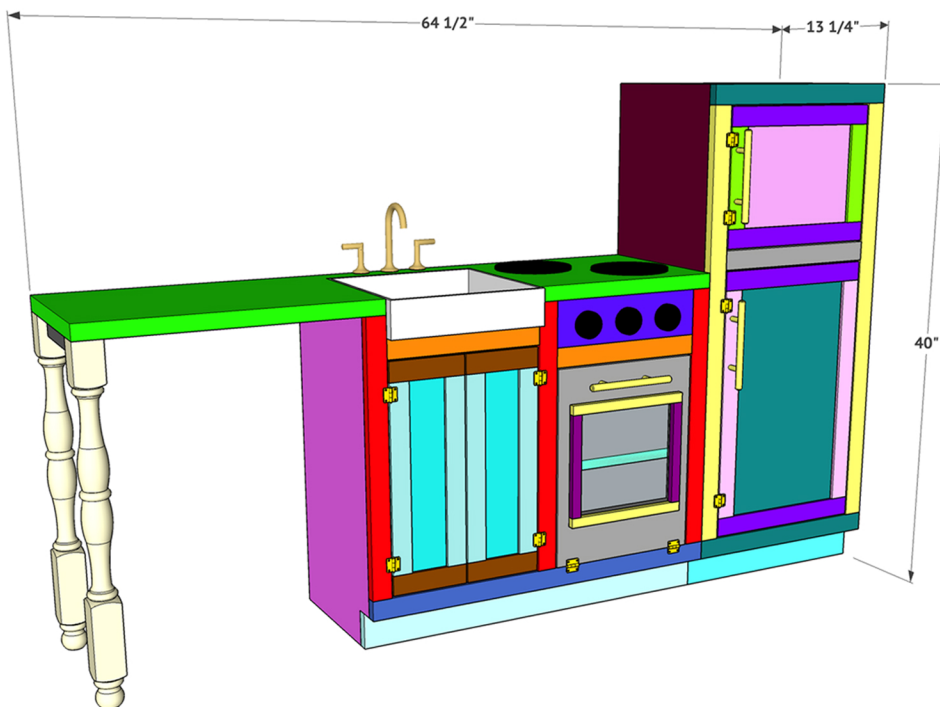
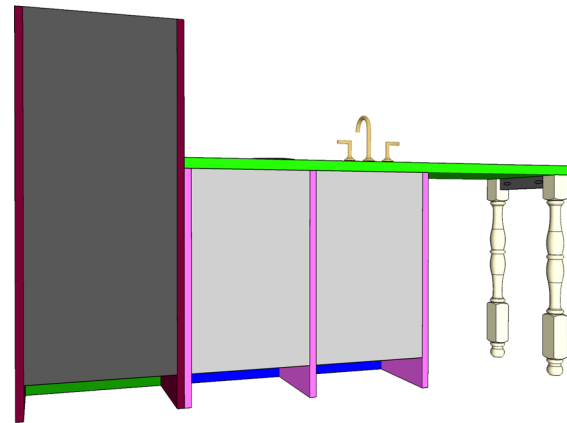

You can get all of the details on how we added the final touches on our site!

Share your builds with us on social media and use #shanty2chic so we can share them too!

Happy Building!