



©2018 WWW.SHANTY-2-CHIC.COM



6 Drawer Dresser

Supply List

Item	Quantity	Description
2 x 4 x 8	5	4 ripped at 3" & 1 ripped at 2.25"
2 x 2 x 8	3	framing lumber
4' x 8' hardwood plywood - 3/4" thick	1	oak or birch
4' x 8' hardwood plywood - 1/2" thick	1	oak, birch or maple
4' x 8' hardwood plywood - 1/4" thick	1	oak, birch or maple
2' x 4' hardwood plywood - 1/4" thick	1	oak, birch or maple
1 x 4 x 6	1	pine or white wood
1 x 3 x 6	1	pine or white wood
wood glue		
drawer slides	6 pair	check website for details
drawer pulls	6	check website for details
1 1/4" Kreg Pocket Hole Screws	several	
1 1/2" Kreg Pocket Hole Screws	several	
Project Panel	1	Pine laminated panel cut to size

Remember!

Many of these cuts are best made as you go. If you have questions, check out the tutorial on our site!

CUT LIST

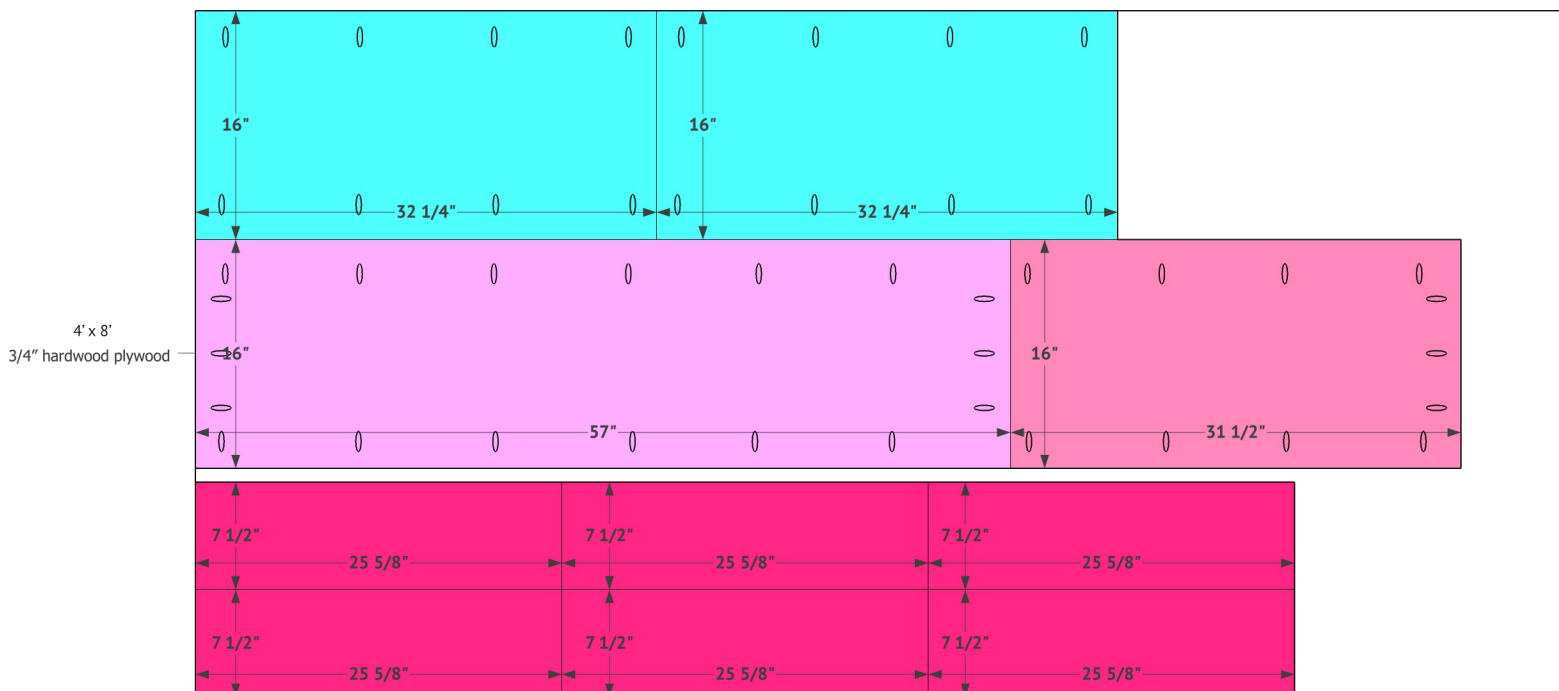
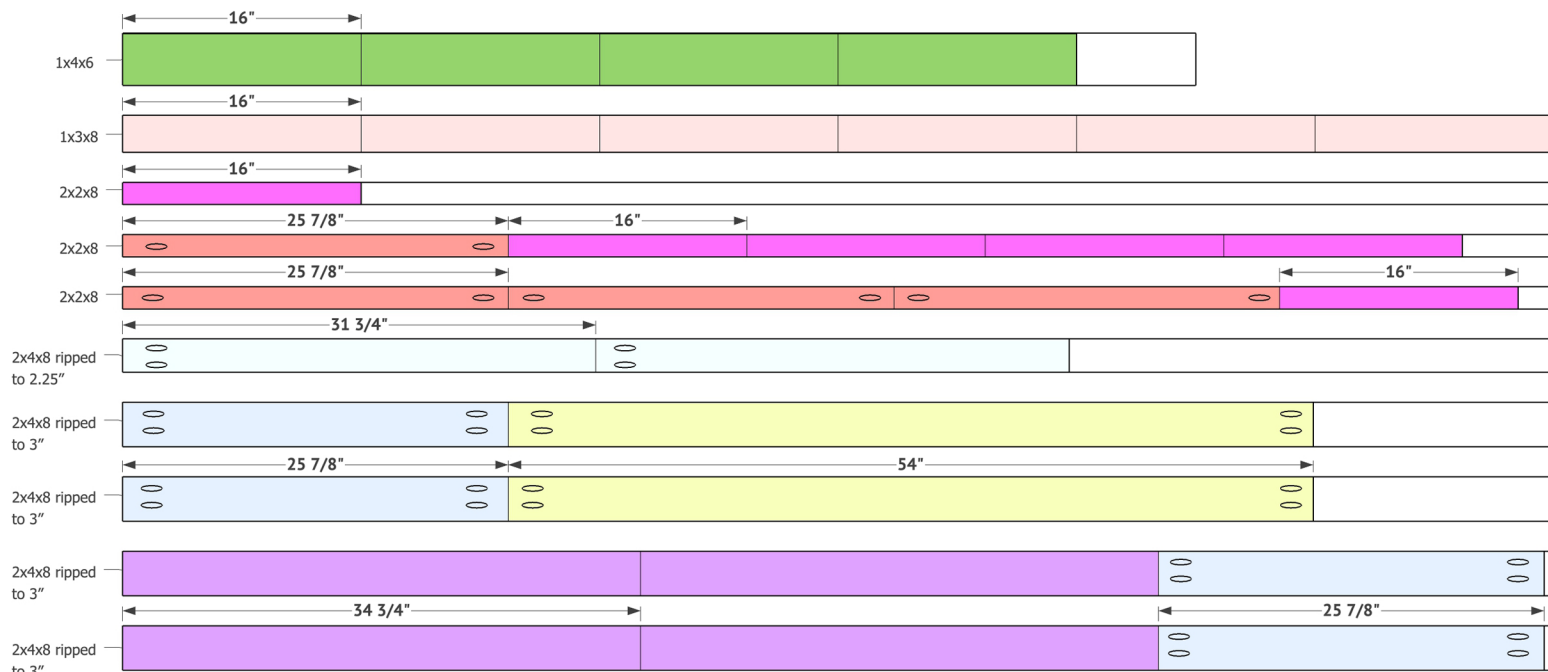

Remember!

Many of these cuts are best made as you go. If you have questions, check out the tutorial on our site!

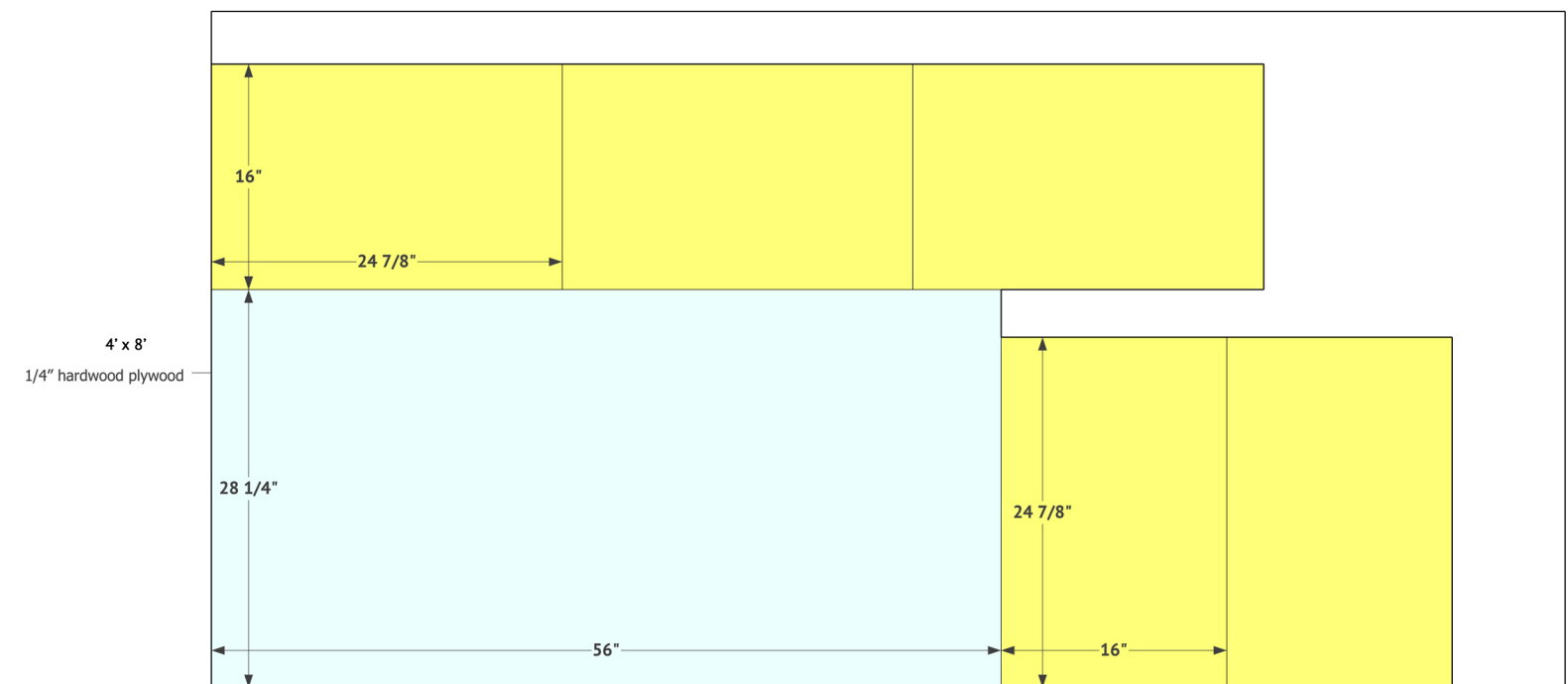
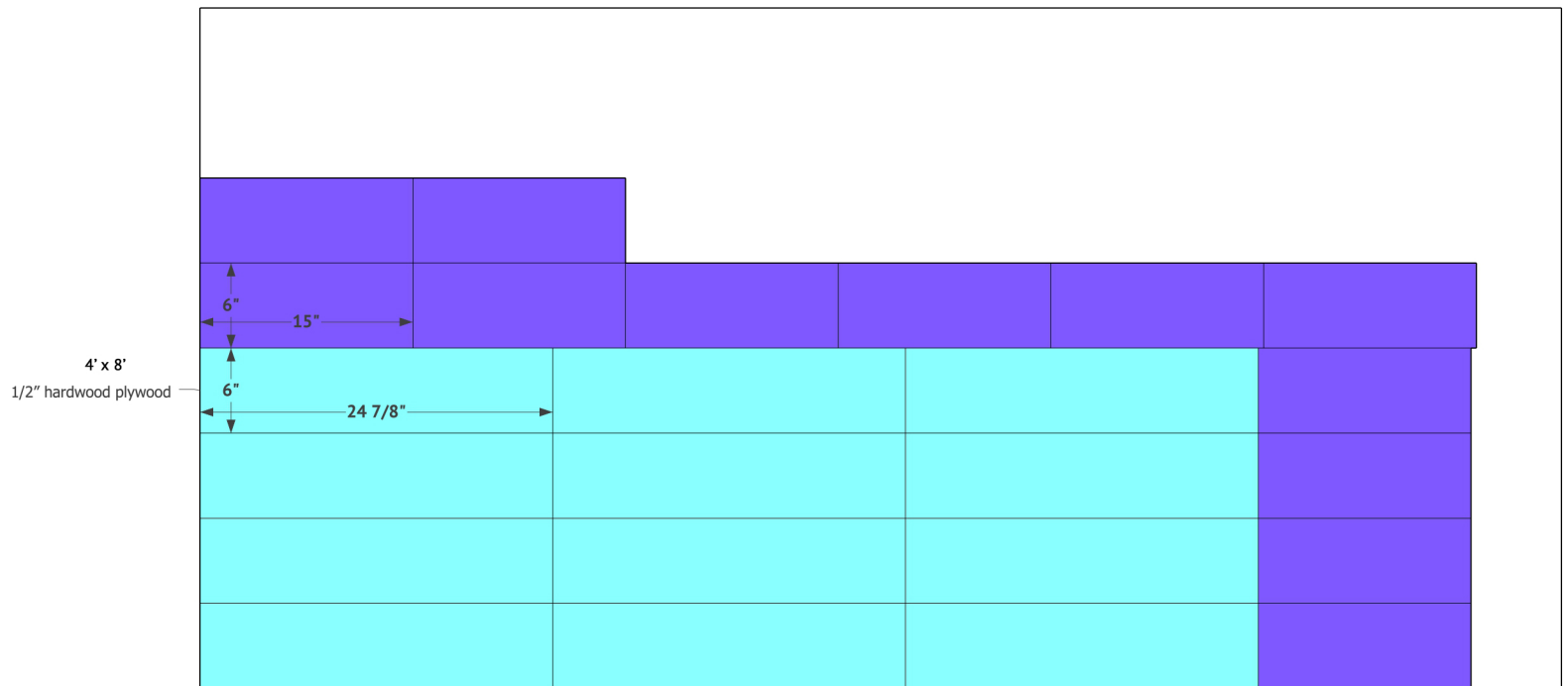

Remember!

Many of these cuts are best made as you go. If you have questions, check out the tutorial on our site!

pine project panel
cut to this size

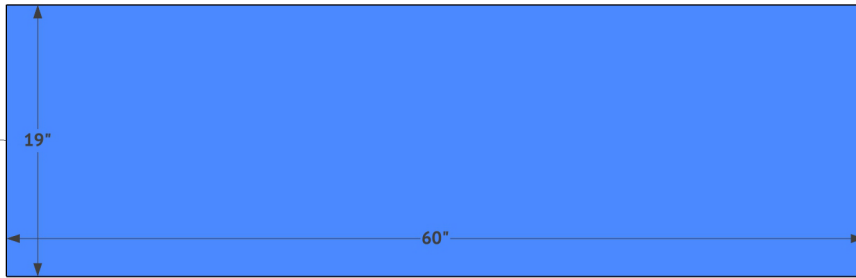

2' x 4'
1/4" hardwood plywood

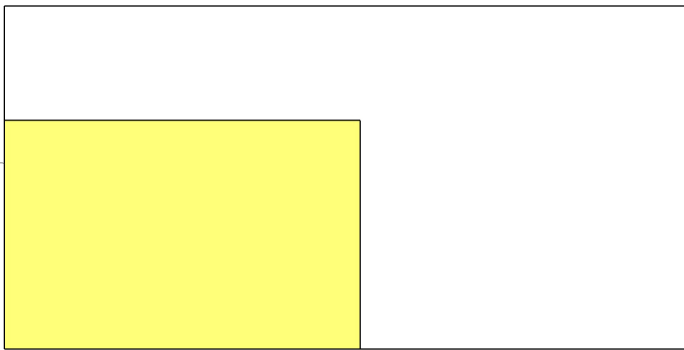

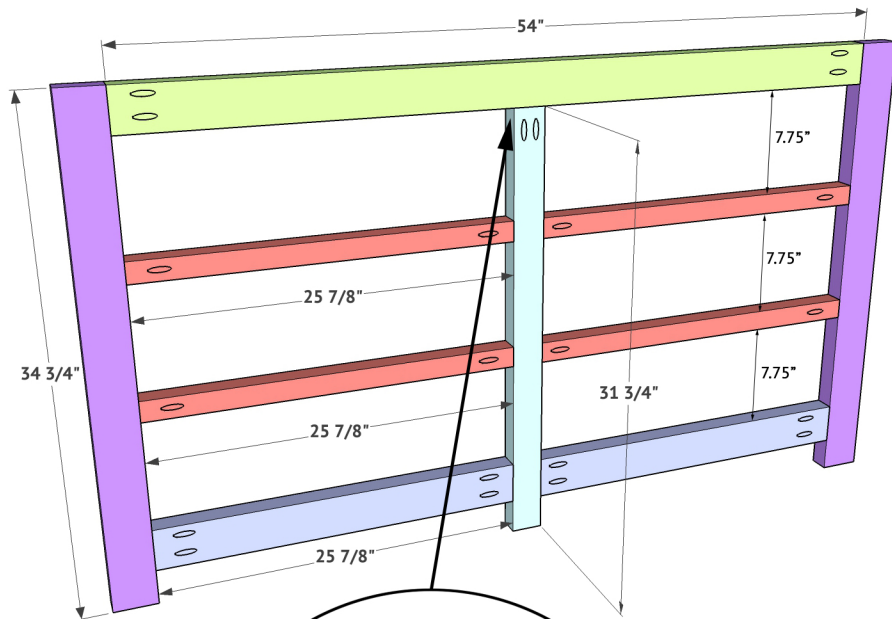

1

The first step is building your face frames. The front face frame uses 2x4 boards that we ripped to 3" wide for the top and bottom boards as well as the two side legs. The middle leg will be ripped to 2.25" wide which is important for the spacing of the drawers. The drawer dividers on this step are 2x2 boards. We like to create our 2x2 boards by ripping down 2x4 boards as well. It's inexpensive, and it gives you the same straight edge. Attach everything on this step using wood glue and 2.5" Kreg pocket hole screws through 1.5" pocket holes.

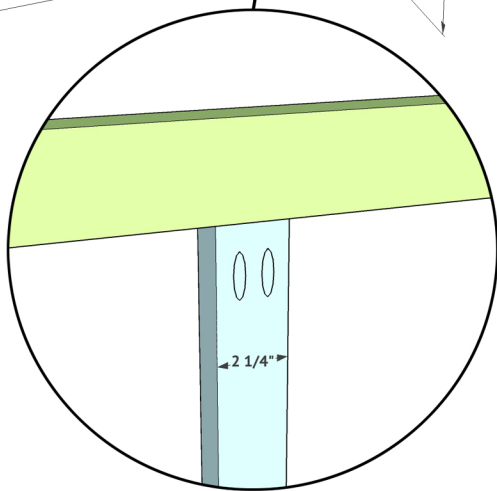

The back face frame is identical to the front, but it has no drawer dividers. Attach all boards the same on this part using wood glue and 2.5" pocket hole screws through 1.5" pocket holes.

2

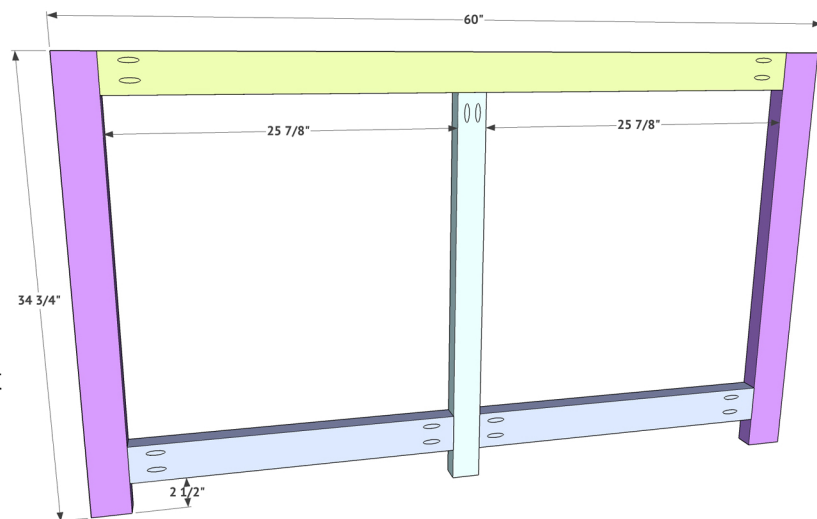

x2

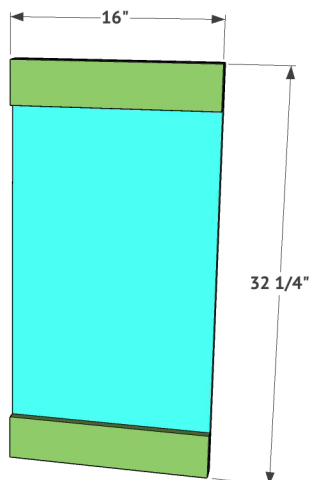

Build the two side frames next. These are 3/4" hardwood plywood. I used birch for mine. The trim pieces are 1x4 boards cut to size. Add 3/4" pocket holes down both long sides of these boards first. Then, attach the trim pieces using wood glue and 1.25" brad nails through the back of the plywood and into the trim pieces.

3

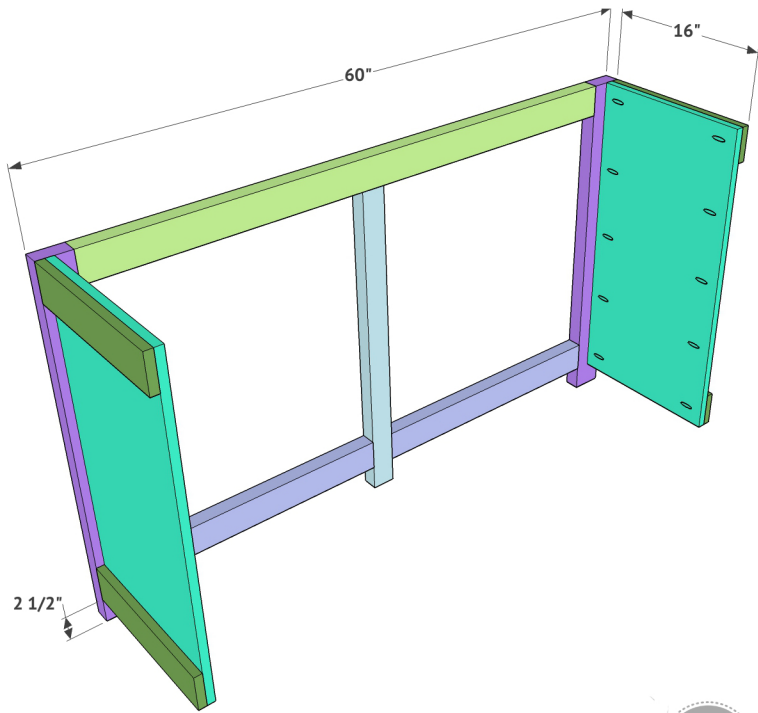

4

Now attach the two side frames to the back face frame using wood glue and 1.5" Kreg pocket hole screws. You want the top of the side frames to be flush with the top of the back face frame which will leave a 2.5" space below the bottom of the side frames. You also want the outside of the trim boards to be flush with the outside edge of the face frame.

5

The base of this dresser is also 3/4" hardwood plywood. Add 3/4" pocket holes with the Kreg Jig along all 4 sides of this piece. Then, attach it to the back face frame and side frames using wood glue and 1.5" pocket hole screws.

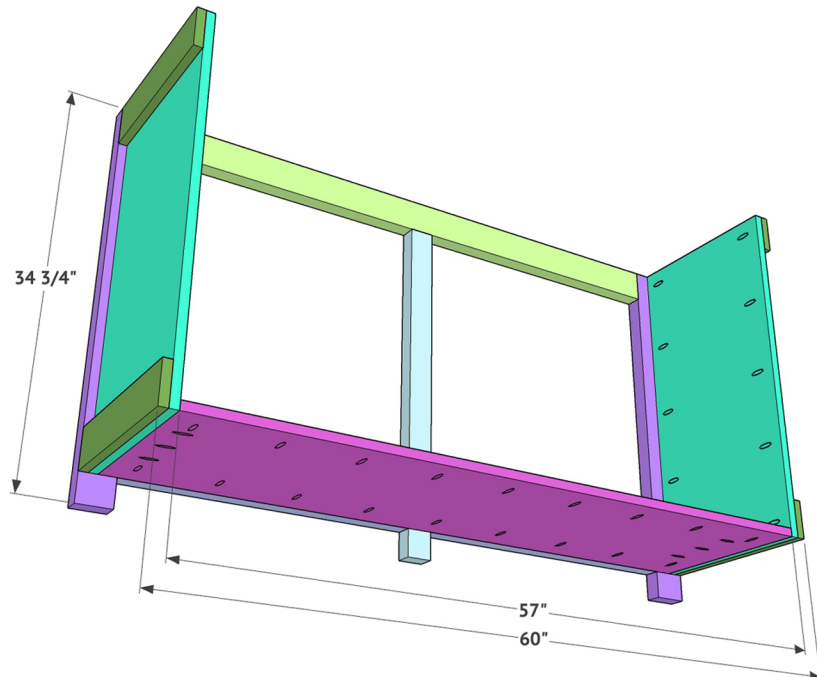

6

Attach the middle divider next. This is also 3/4" hardwood plywood cut slightly shorter than the side frames. Add pocket holes down both long sides and the bottom of one side of this board. Attach it to the base of the dresser and the middle leg of the face frame using wood glue and 1.25" pocket hole screws for the bottom and 1.5" pocket hole screws for the longer sides. Don't forget to use wood glue too!

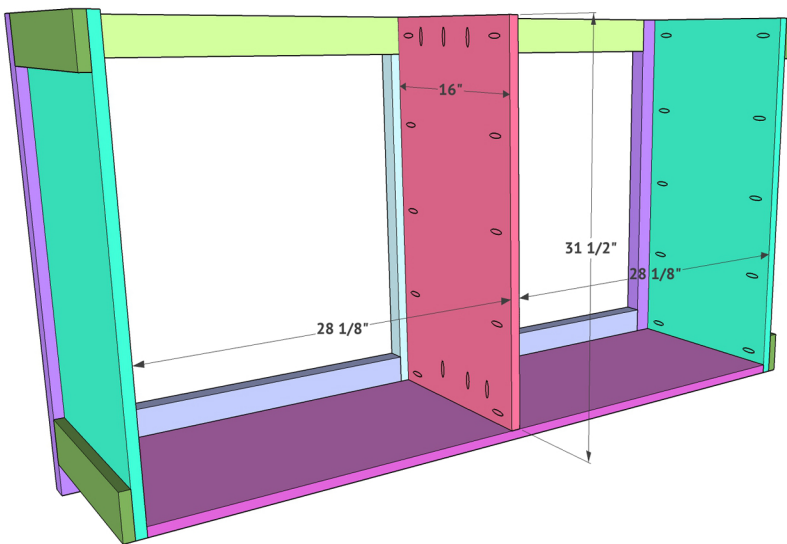

Now you can attach the boards that will support your drawer slides. The outside boards that attach to the outside face frame are 2x2 boards, and the inside boards that attach to the center divider are 1x3 boards. Attach the 2x2 boards using wood glue and 2" nails or screws. Attach the 1x3 boards using wood glue and 1.25" screws or brad nails.

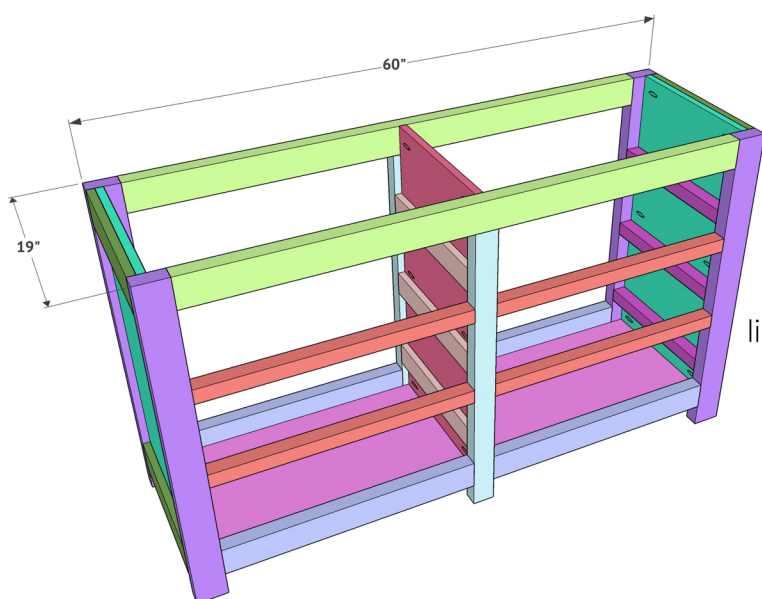
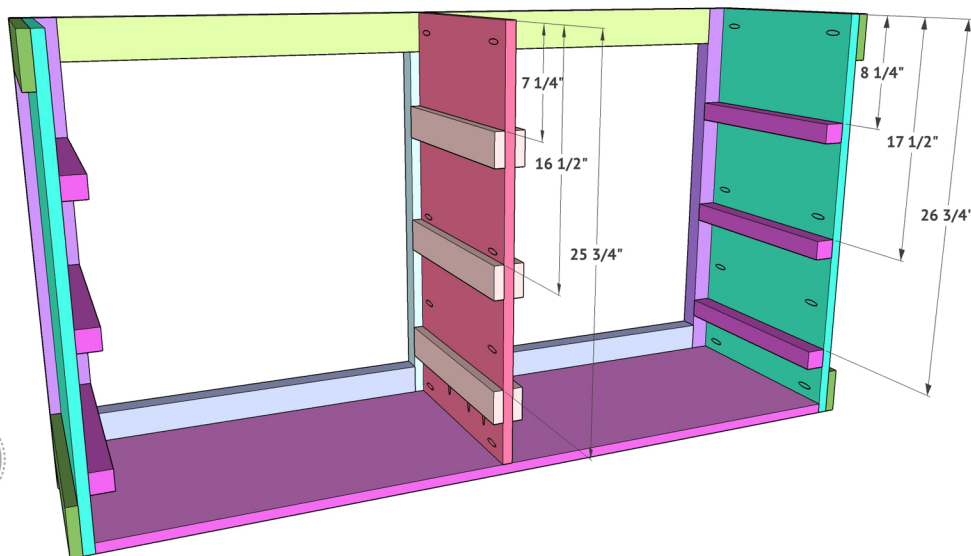

Attach the front face frame next! Use wood glue and 1.5" Kreg pocket hole screws to go through the side frames and center divider and into the face frame. Just like the back face frame, you want the outsides and top flush with the outside edges of the face frame.



Time for the top!
The top of this dresser is a pine project panel. I believe my original size was 24" x 72" and I used my table saw to cut it to size. You can also have the guys at the hardware store cut yours for you. Glue and clamp the panel to the top of the dresser and attach using 3.5" wood screws through the face frame top boards and into the panel. You can also nail the panel to the dresser base and fill the holes... Your call!

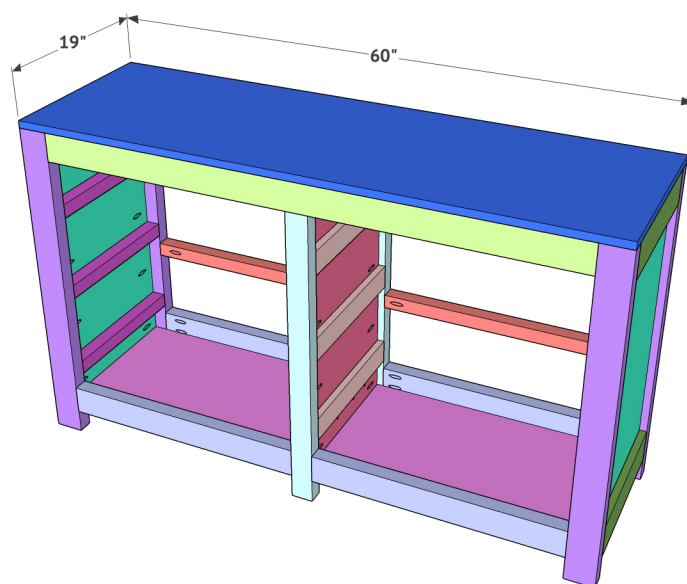

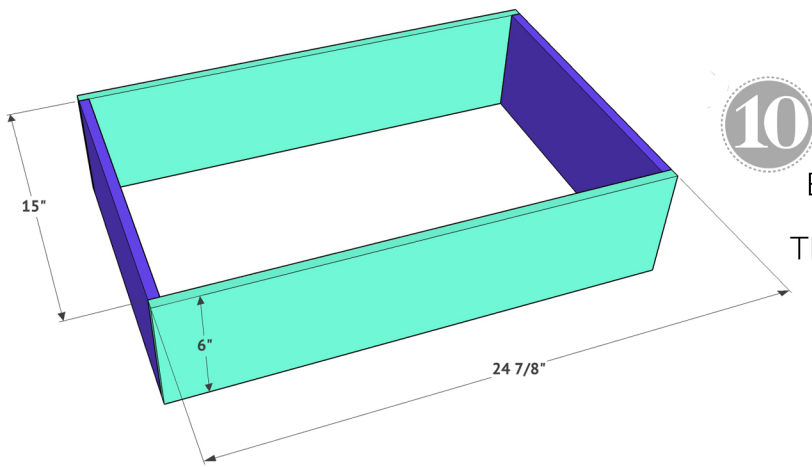

10

Build the drawers next. Be sure to measure each of your openings to get the best fit! The frame of these drawers are built with 1/2" hardwood plywood. Rip the plywood to 6" wide and then make your cross cuts. Attach the pieces together at the corners using wood glue and 1.25" brad nails.

The bottom of the drawers are 1/4" hardwood plywood. Cut each to size, and then attach to the frame using wood glue and 1" staples or 1.25" brad nails. Staples are good on this part to hold that in place because it is a thinner material.

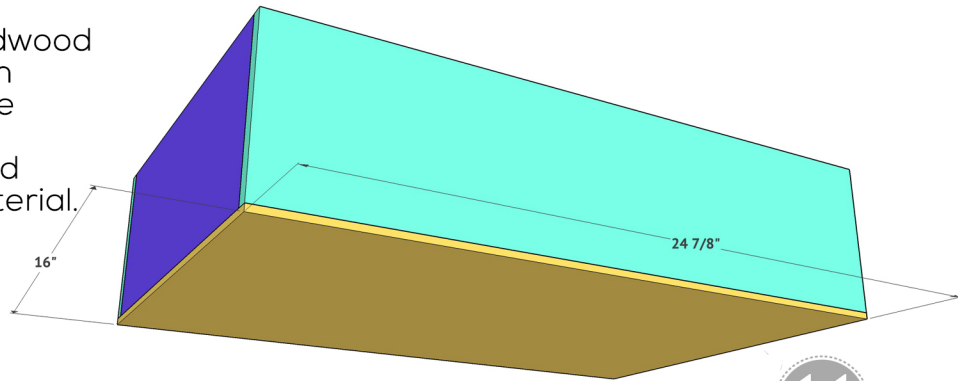

11

Attach the 6 drawers into place. Check out our website for details on how I attached mine. I left 1/2" spacing on the sides of the drawers for my slides, but make sure you leave the width suggested by the slides you use. I also link to the ones I use and love!

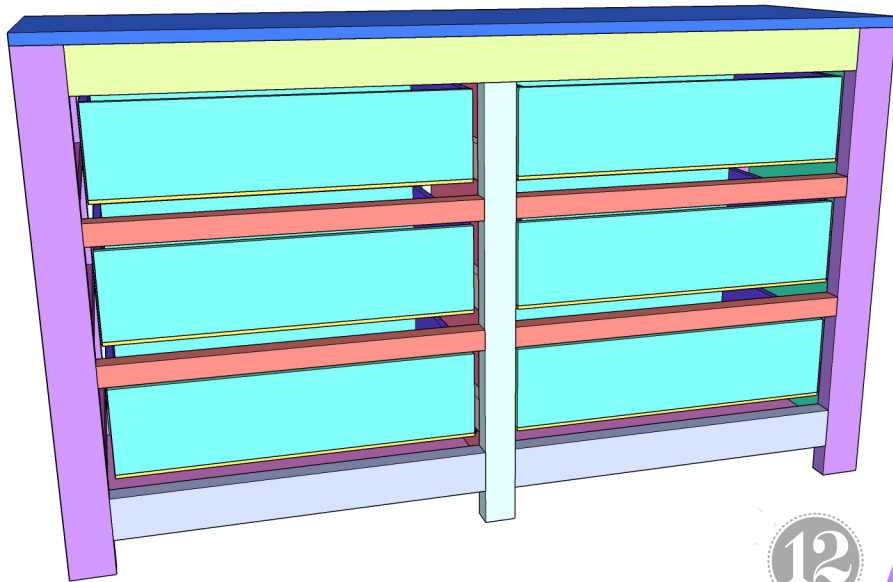

12

Finally, cut the drawer fronts. I made these plans so you are able to use 1x8 for this part, but I chose to use hardwood plywood again. I love the way that it stains and how straight the boards are to work with especially when building drawers. Cut each to size and use playing cards or other types of spacers to line each drawer up in place. I like to nail them in place from the front 2 times and then open the drawer and use screws from the inside of the drawer and into each face frame. Don't forget to use wood glue as well!

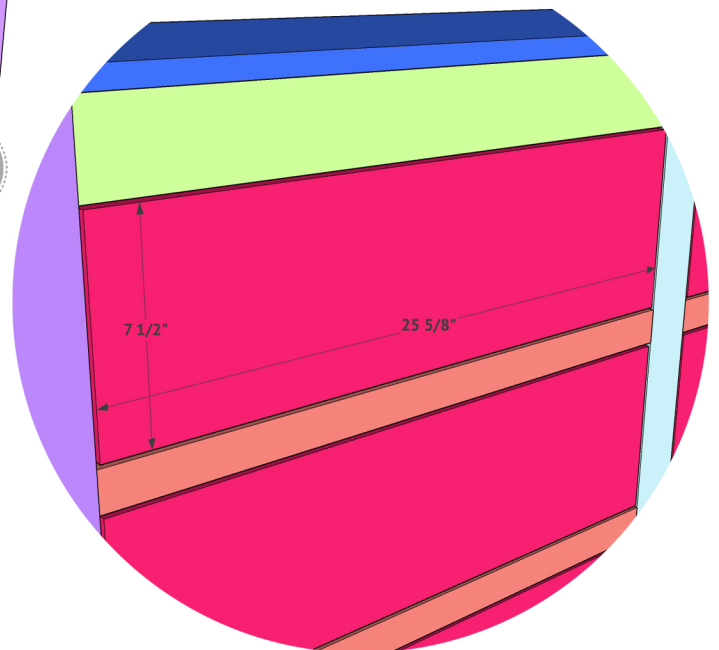

13

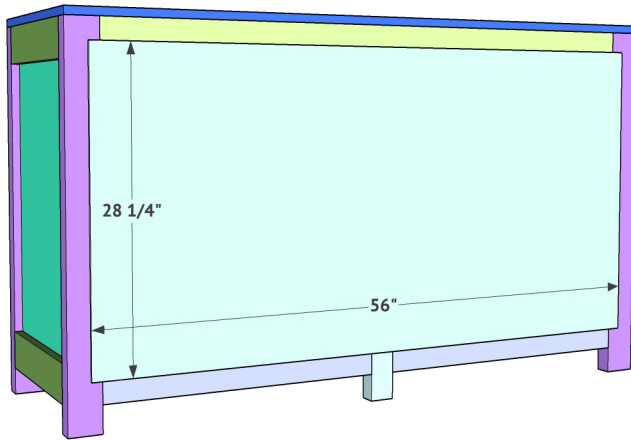

Final step is adding your back!
This is just 1/4" hardwood plywood
cut to size.
Attach it to the back of the dresser
using wood glue and 1" staples or
nails.



Now for the fun part! Make it your own!
Check out our website for details on how
I finished this one and the hardware I used.
Be sure to share your projects with us
using #shanty2chic so we can see and share them!
Happy Building!