



©2019 WWW.SHANTY-2-CHIC.COM



Barn Door Dog Crate

Supply List

Item	Quantity	Description
2 x 6 x 8	6	framing lumber
2 x 4 x 8	4	framing lumber
1 x 2 x 8	1	pine or white wood
3/4" hardwood plywood	1	48' x 48"
1/2" hardwood plywood	1	at least 15" x 22"
barn door hardware		Refer to website for details
wood glue		
pocket hole screws	several	1.25", 2" and 2.5"
finish nails	several	2"
wood screws	several	2.5"

Remember!

Many of these cuts are best made as you go. If you have questions, check out the tutorial on our site!

CUT LIST

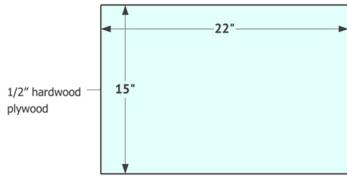
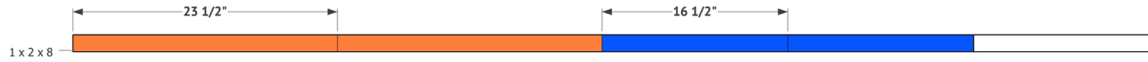

****All 2x boards have been ripped to different widths. If you choose to not do so, please adjust the plans to fit your measurements.**

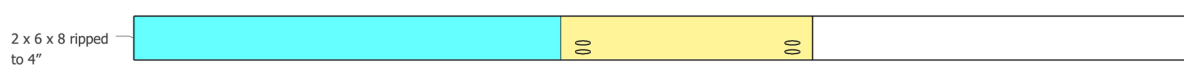
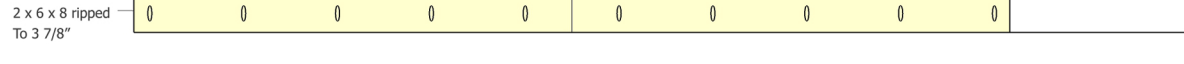
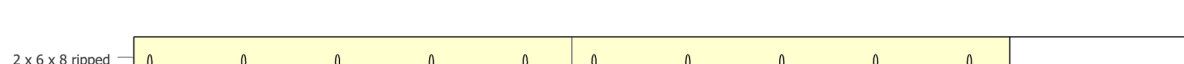
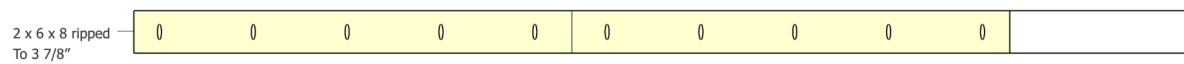
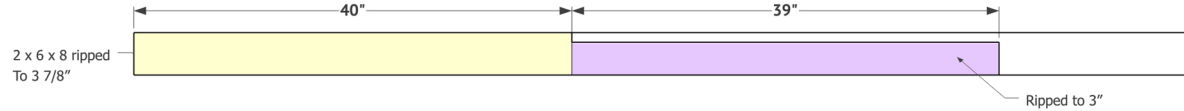
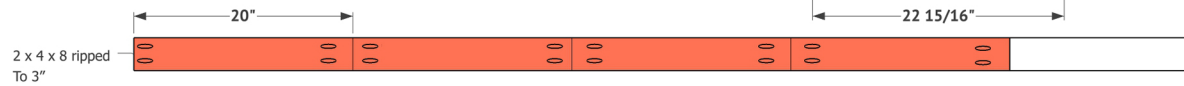
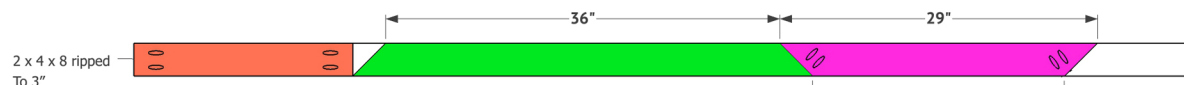
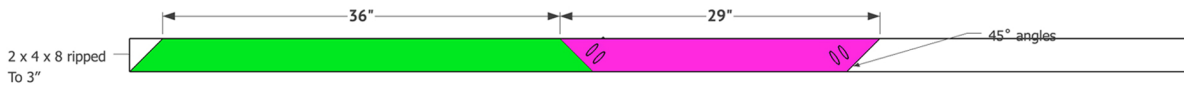
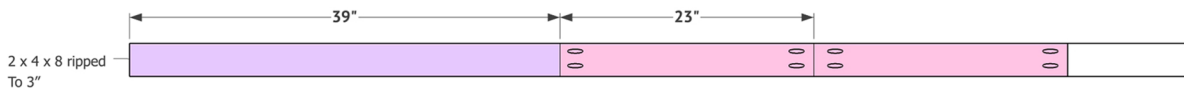
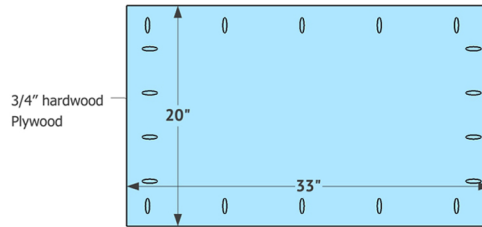
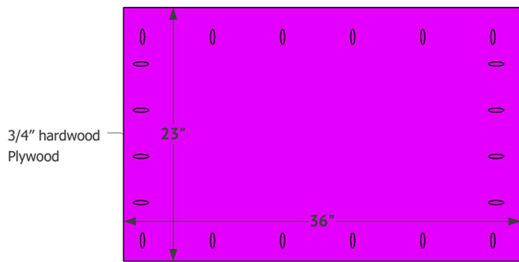

Build the base first. Attach the 2x3 sides to the plywood using wood glue and 1.25" pocket hole screws through the 3/4" pocket holes on the plywood. Then, attach the corners with 2" pocket hole screws through the angled pocket holes.

1

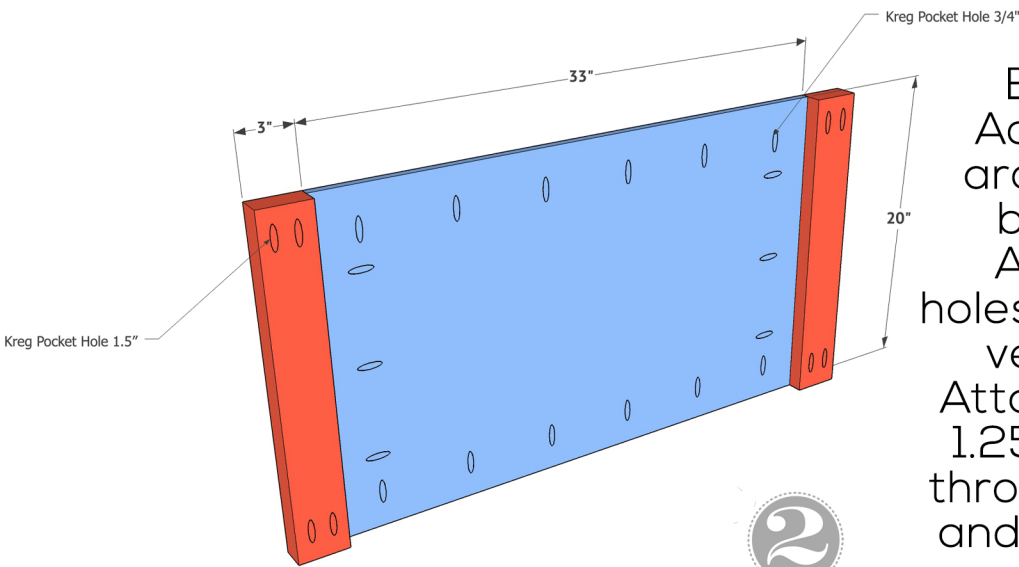
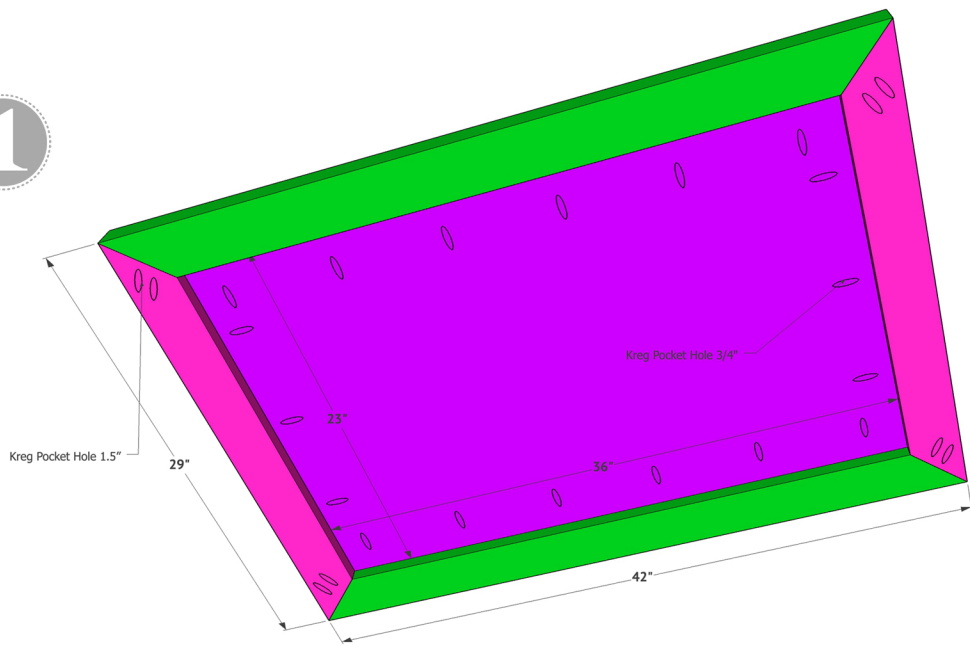

Build the back next. Add 3/4" pocket holes around all edges of the back plywood panel. Also, add 1.5" pocket holes on both ends of each vertical frame board. Attach these boards with 1.25" pocket hole screws through the plywood sides and into the boards using wood glue between both.

2

Then, attach the top and bottom boards of the frame. Attach first with 1.25" pocket hole screws and wood glue through the plywood panel, and then using 2.5" pocket hole screws through the side frame boards and into the top and bottom of the frame. Be sure to use wood glue between these boards as well.

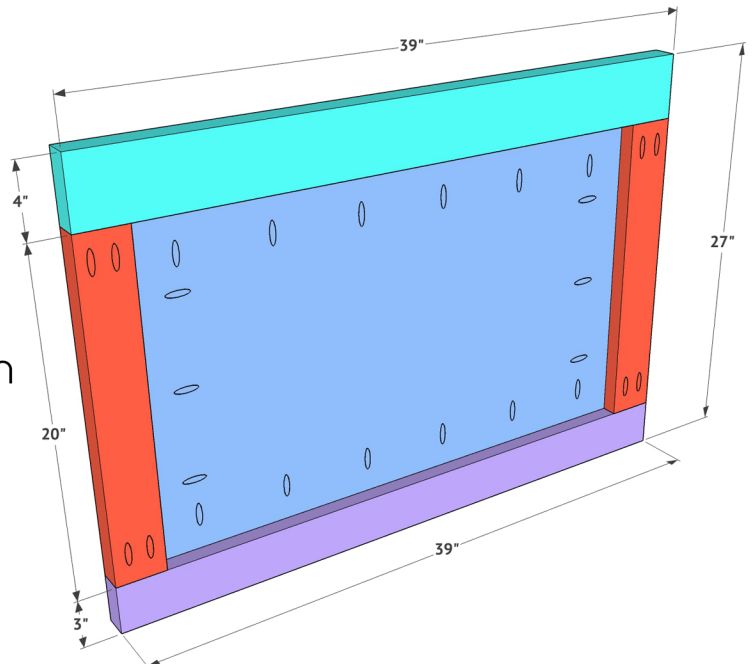

Build the front frame next.

Add 1.5" pocket holes on both ends of all vertical boards, and attach them to both the top and bottom frame boards using wood glue and 2.5" pocket hole screws. The outside vertical boards will be flush with the ends of the top and bottom frame boards, and the middle board will line up in the center of both.

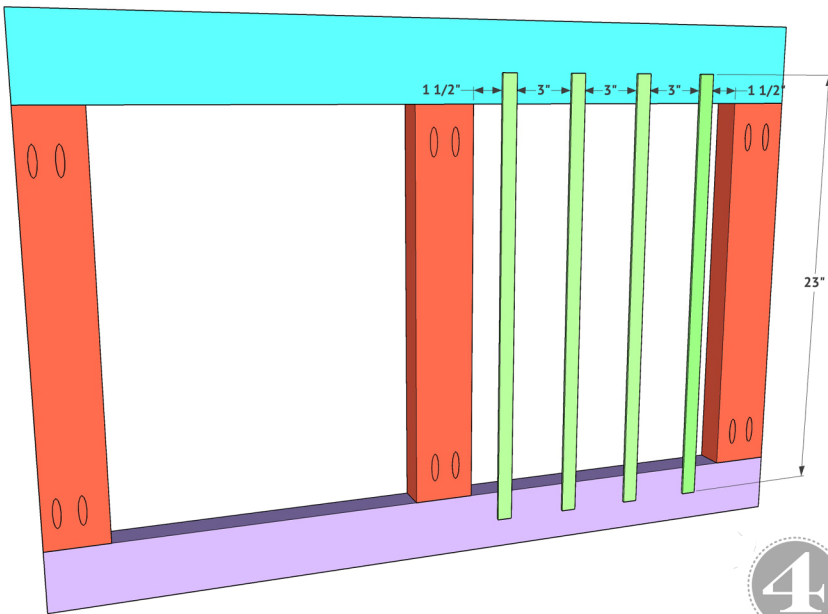
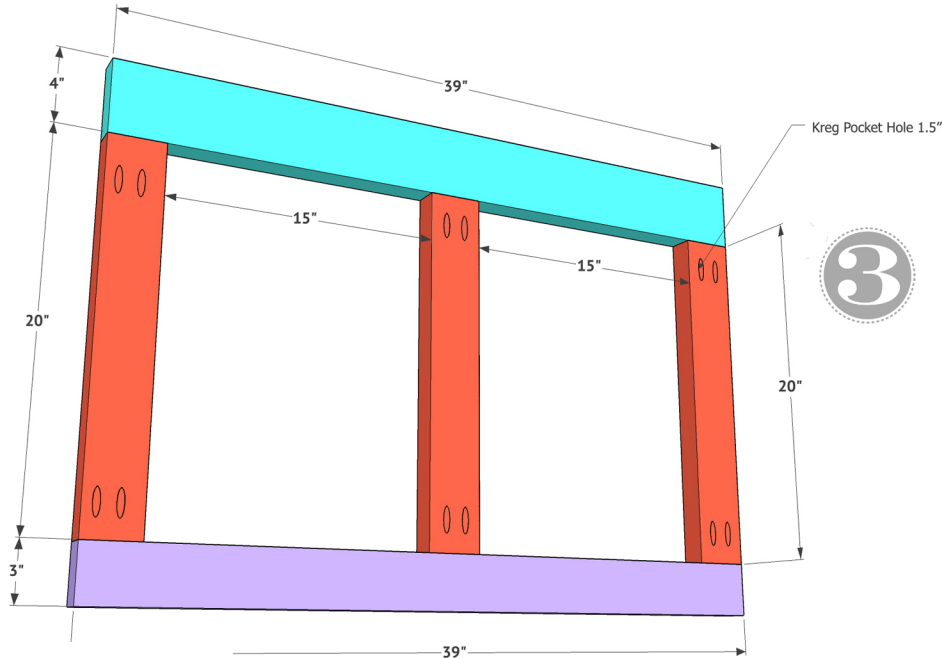

Paint all wood parts before attaching metal bars. I used aluminum flat bar for mine. These come 3/4" x 48" long. I used my jig saw with a metal blade to cut 14 bars at 23" each. I painted each bar with satin black spray paint and added holes 1" from each end using a cobalt drill bit. Then attach them to the front crate assembly using this spacing. If you have a smaller dog, you can adjust the spacing as needed.

4

5

Now you will build both side assemblies. Before attaching the metal bars, add 1.5" pocket holes to each board. Note the location of the pocket holes to help avoid covering them with the bars.

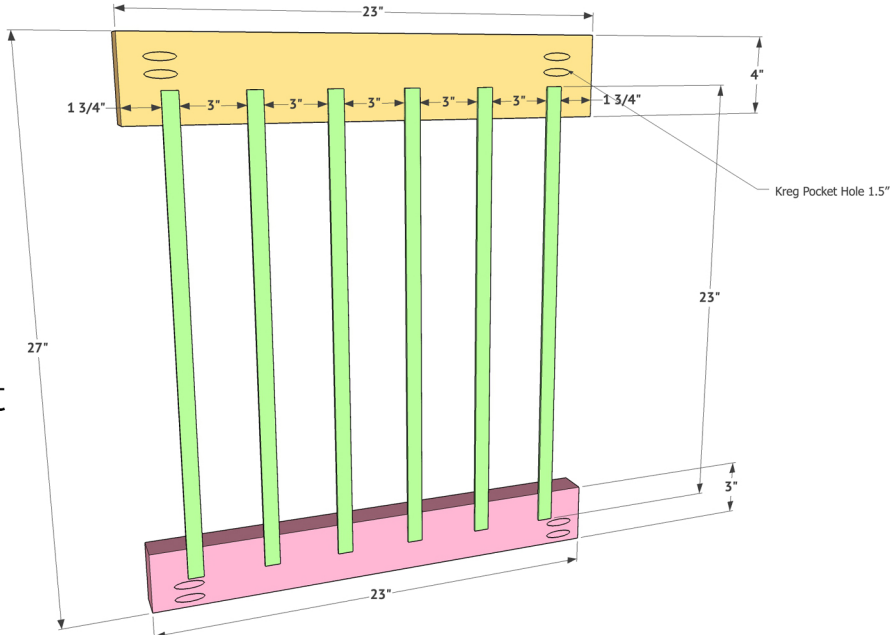

6

Now attach both side assemblies to the front of the crate using wood glue and 2.5" pocket hole screws through the pocket holes on the sides and into the front. You want the edges of the sides to be flush with the sides of the front assembly.

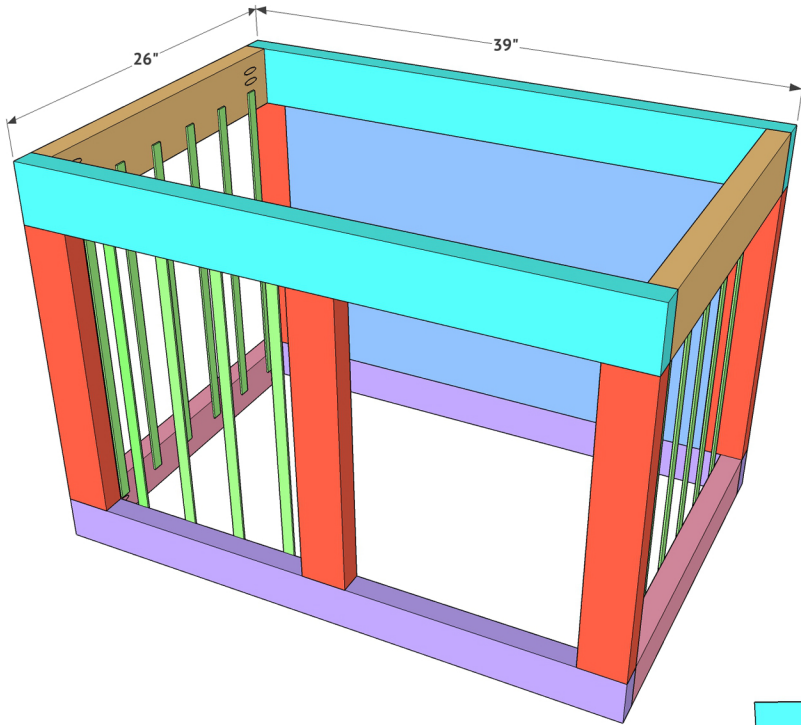
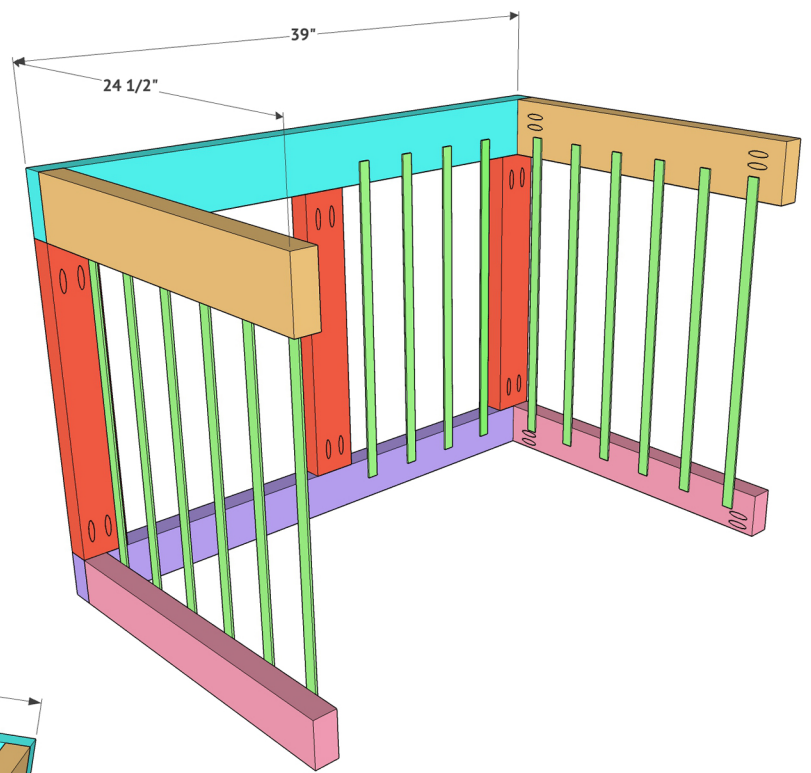

7

Attach the back assembly next. You will attach this the same way you did the front, through the pocket holes on the side assemblies. Make sure to use glue between joints as well.

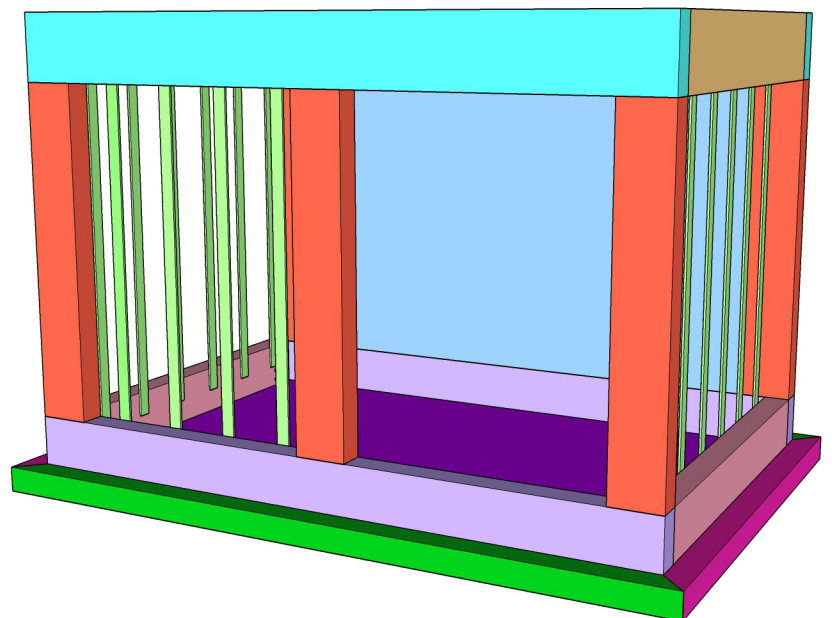

8

Turn the crate upside-down and attach the base by placing it face down on the crate and use 2.5" wood screws through the base and into the crate assembly. Use wood glue between both on this part as well.

Time for the top!
Cut the plank boards to size, and add 1.5" pocket holes to 6 of the 7 boards. Lay them side by side and attach them using 2.5" pocket hole screws.

Kreg Pocket Hole 1.5"

9

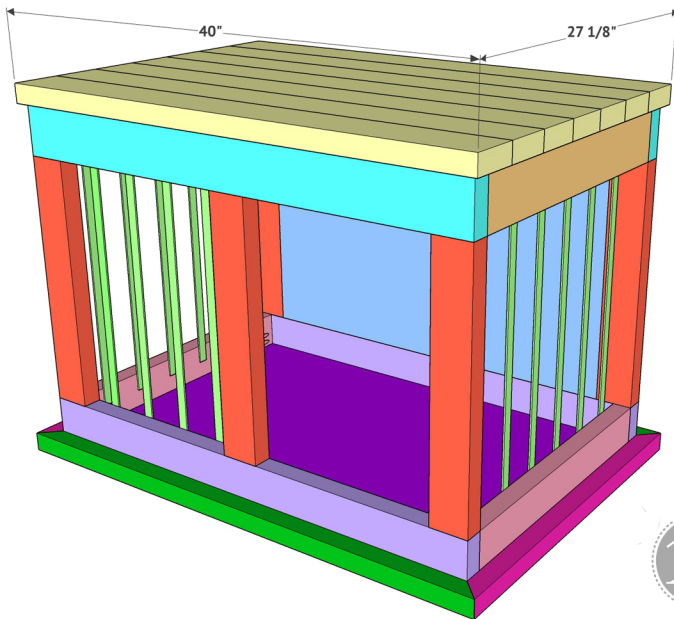
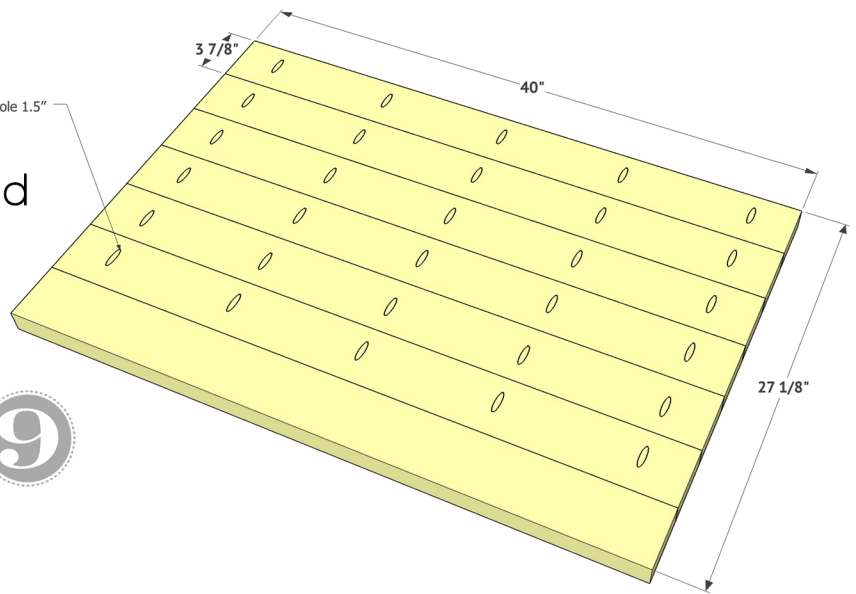

10

Run a line of wood glue along the top of the crate, and place the top assembly on top of the crate. Use clamps to hold the top down and attach it to the crate using 2" finish nails.

The final step is building the door. I used 1/2" hardwood plywood and planked it with barn wood. Have fun with this part! You can totally modify to it fit your own style. I ripped 1/2 boards down to 1" to create the frame around the edge of the door with 45° mitered corners. Be sure to check our website for more details on the hardware we used and how we attached it!

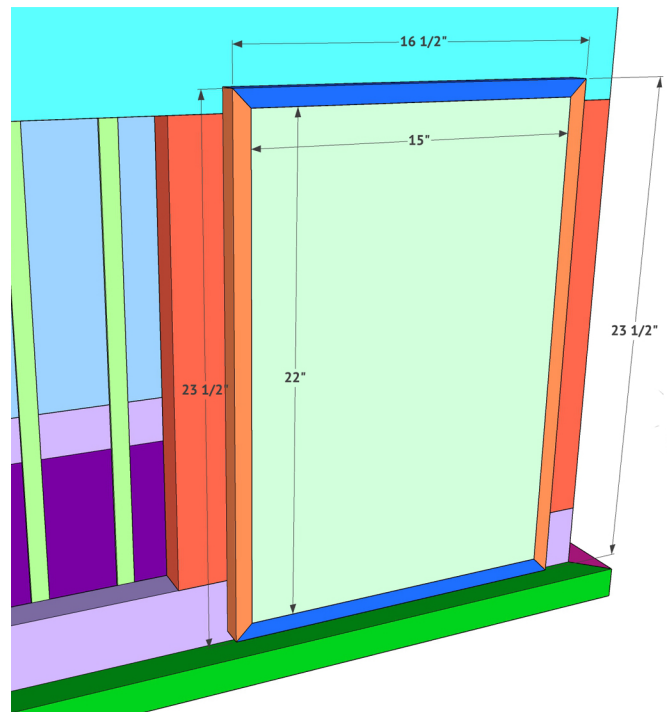

11