



©2020 WWW.SHANTY-2-CHIC.COM



# DIY Pantry Cabinet

## Supply List

| Item                  | Quantity | Description   |
|-----------------------|----------|---|
| 1 x 3 x 8             | 1        | pine or whitewood                                   |
| 1 x 3 x 6             | 1        | pine or whitewood                                   |
| 1 x 4 x 6             | 1        | pine or whitewood                                   |
| 3/4" hardwood plywood | 1        | 48" x 96"   |
| 3/4" hardwood plywood | 1        | 24" x 48"   |
| 1/2" hardwood plywood | 1        | 48" X 96"   |
| 1/2" hardwood plywood | 1        | 48" x 96"   |
| Bender Boards         | 4        | ripped to correct width (can also use craft boards) |
| edge glued panel      | 1        |   |
| wood glue             |          |   |
| 14" drawer slides     | 2 pair   |   |
| door pull             |          | see post for details                                |
| door hinges           | 3        | see post for details                                |

*Remember!*

Many of these cuts are best made as you go. If you have questions, check out the tutorial on our site!

## CUT LIST

1/2" hardwood plywood  
48" x 96"

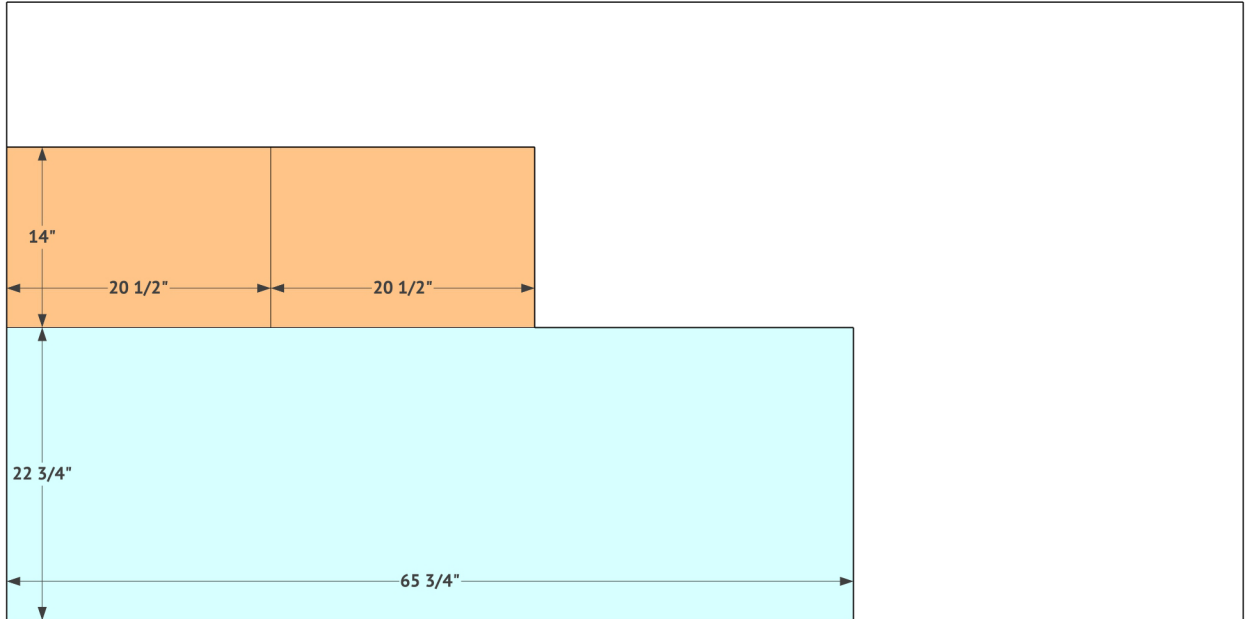

These are all bender boards. You can also use 1/4" thick craft boards. Use table saw to rip to correct width.

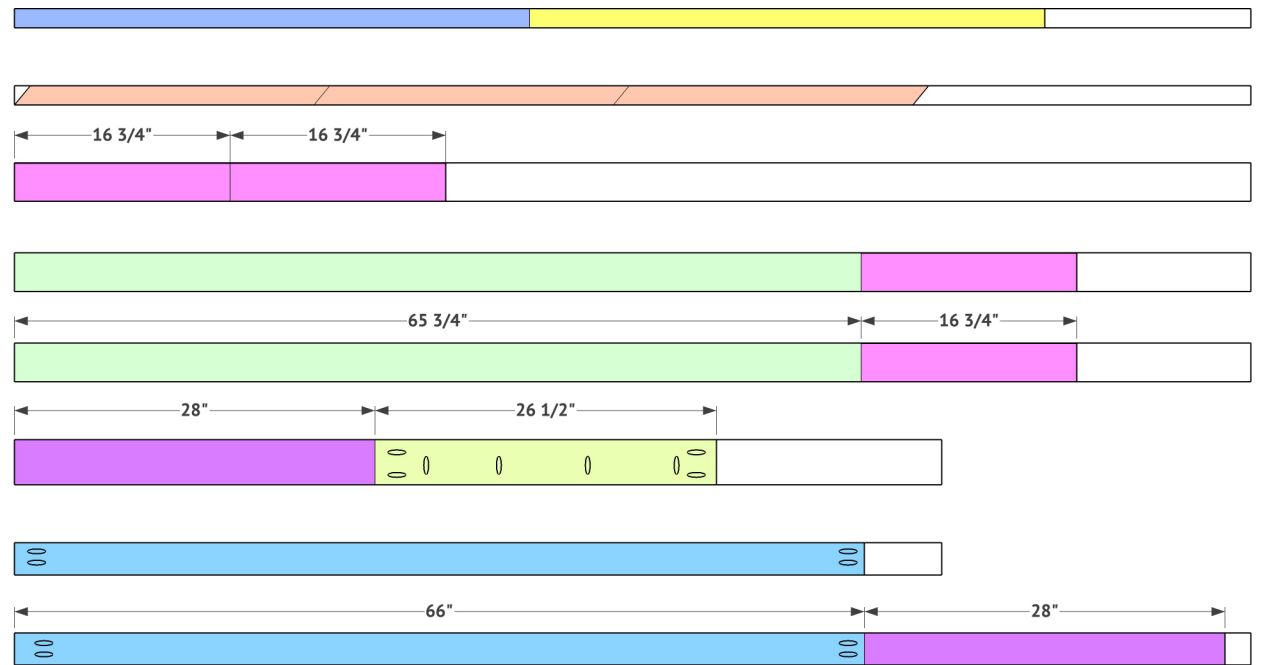

1 x 4 x 6

1 x 3 x 6

1 x 3 x 8

*Remember!*

Many of these cuts are best made as you go. If you have questions, check out the tutorial on our site!

## CUT LIST

1/4" hardwood  
plywood  
48" x 96"  
cut to size

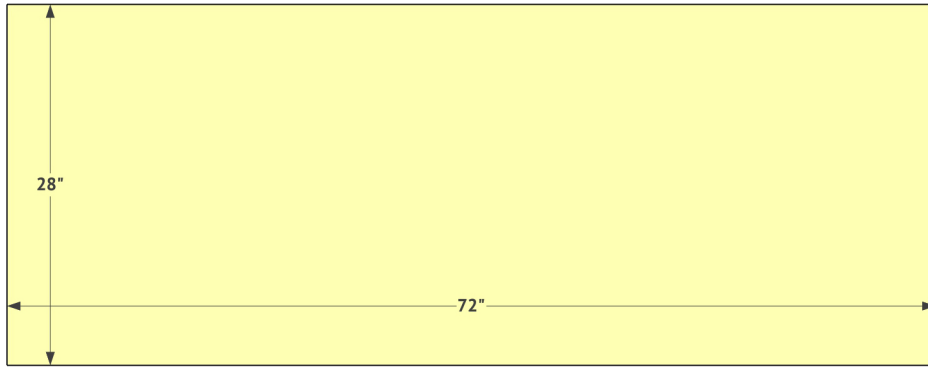

3/4" hardwood  
plywood  
24" x 48"

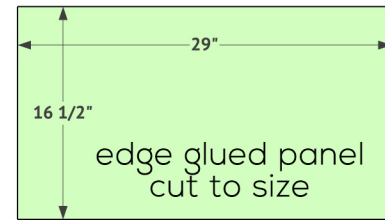
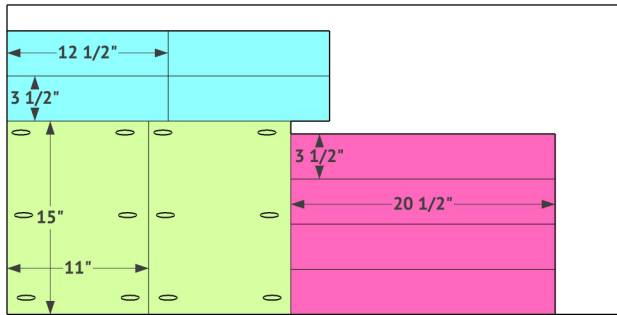

edge glued panel  
cut to size

3/4" hardwood  
plywood  
48" x 96"

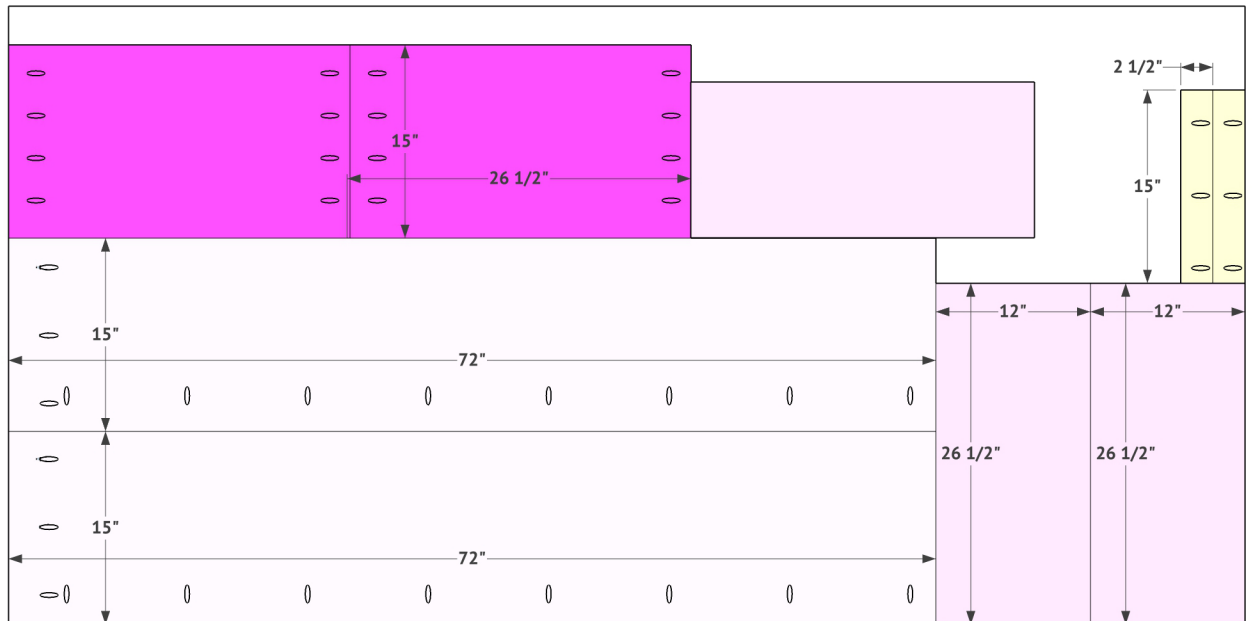

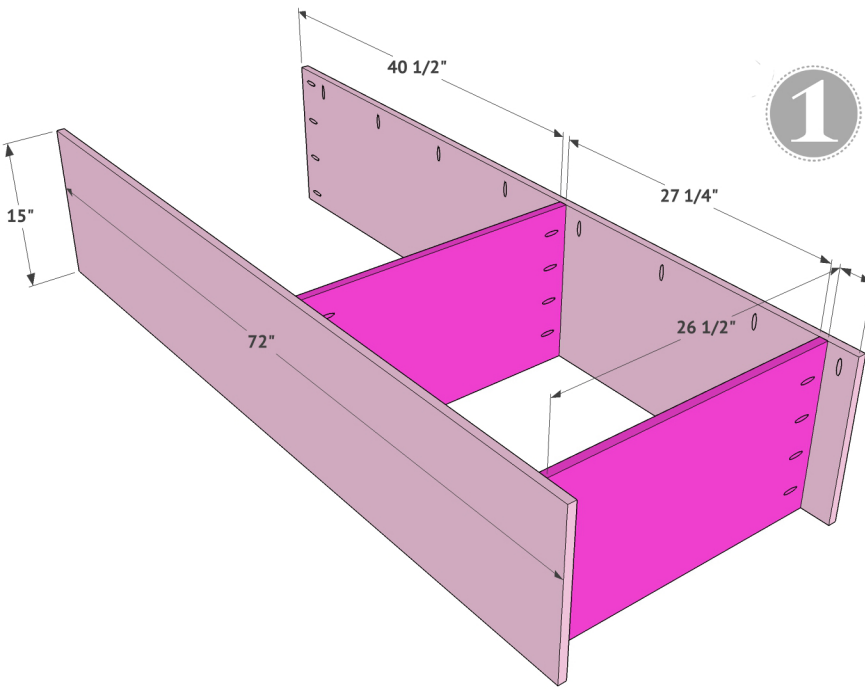

1

The body of this pantry is constructed with 3/4" plywood. Cut each long side as well as the bottom and middle shelves. If you are adding shelf pin holes to your sides, be sure to do that before attaching the shelf boards on this step. You can check out our video for tips on adding shelf pins to your pantry cabinet. Attach the shelf boards to the sides using wood glue and 1.25" pocket hole screws through 3/4" pocket holes.

Now, attach the back support board to the top and back of the cabinet. This board will be used to secure the cabinet to the wall once it's finished. Add 3/4" pocket holes along the top and sides of this board. Attach it to the side boards using wood glue and 1.25" pocket hole screws through the 3/4" pocket holes. The top pocket holes will be used to attach the top in a later step.

2

Kreg Pocket Hole 3/4"

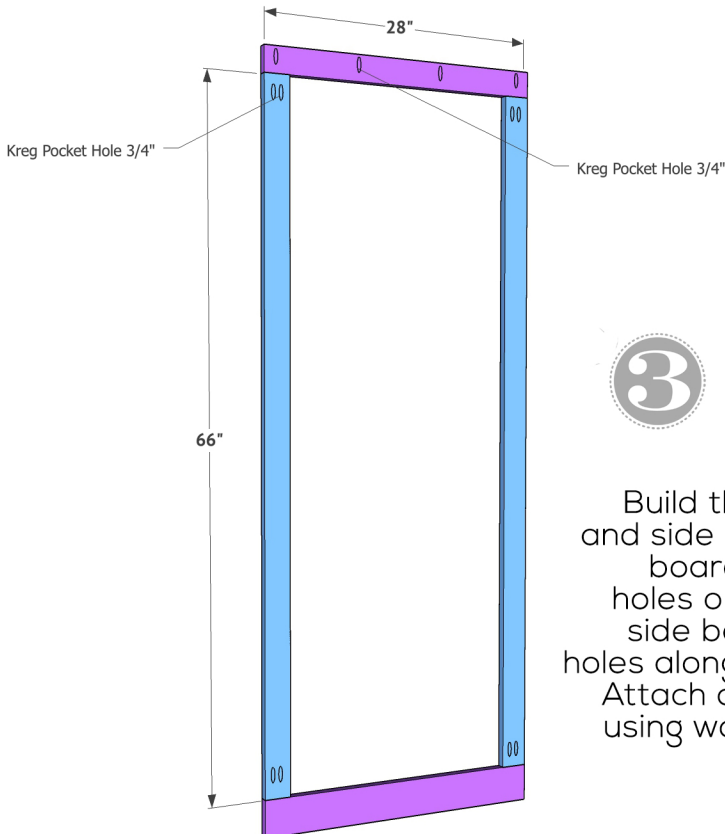
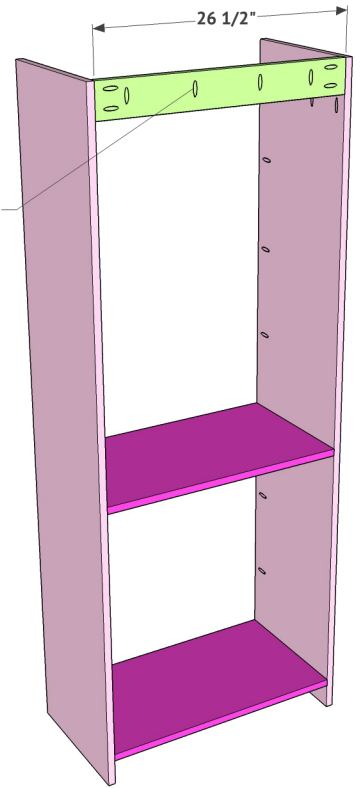

3

Build the face frame next. The top and side boards are 1x3 and the bottom board is a 1x4. Add 3/4" pocket holes on the top and bottoms of the side boards. Also add 3/4" pocket holes along one long side of the top board. Attach all boards to create the frame using wood glue and 1.25" pocket hole screws.



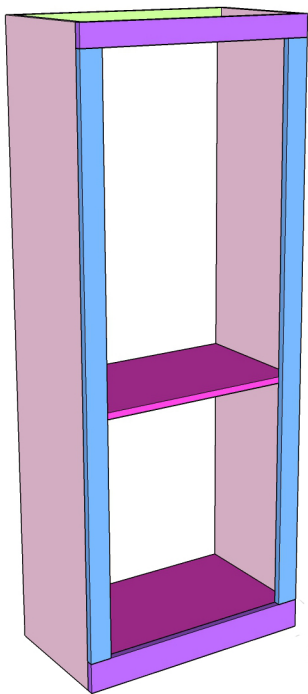

Attach the face frame to the front of the cabinet using wood glue and 1.25" pocket hole screws through the pocket holes on the inside of the cabinet and into the face frame. Make sure the face frame is flush with the top and sides of the cabinet.

4

Now it's time to build the door! The back of the door is 1/2" hardwood plywood. The trim on the front of the door is called bender board. These boards can typically be found in the outdoor landscaping section of the hardware store. If you can't find them, you can also use 1/4" craft boards for the trim part. I used my table saw to rip the vertical and horizontal boards first. Then, I cut each one to size and attached them using wood glue and 5/8" brad nails.

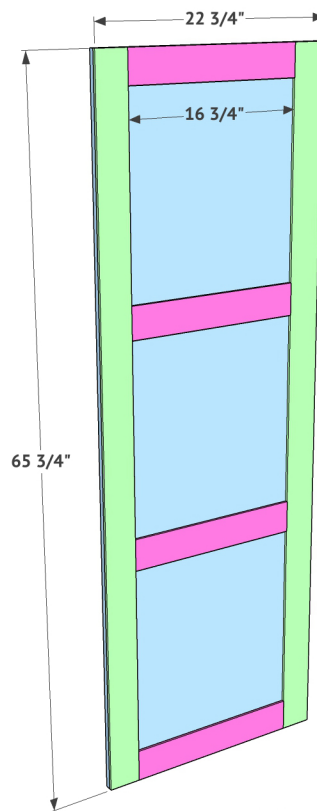

5

The diagonal boards are ripped to 1.5" wide each.

I didn't add dimensions for the diagonal boards because these are easiest to measure by holding in place and marking the cut with a pencil. Attach them the same way using glue and nails.

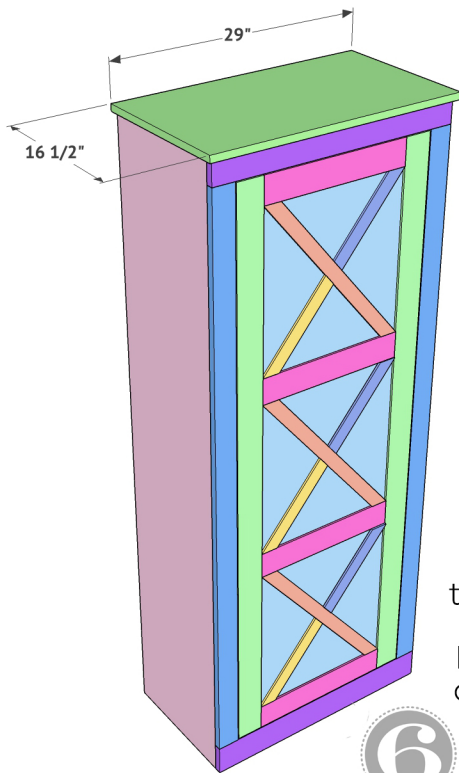

6

The top of the cabinet is a edge glued panel. These come in different sizes and are ready to stain or paint. Attach the top using wood glue and 1.25" pocket hole screws through the pocket holes at the top of the cabinet and into the wood panel.

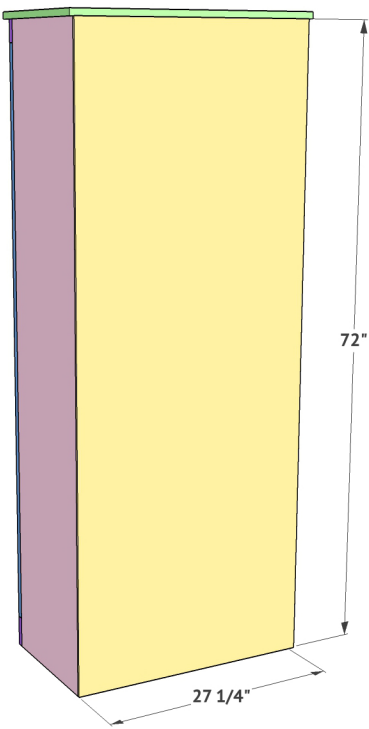

The back of the pantry is 1/4" hardwood plywood. Cut this piece to size and attach it to the back using 3/4" brad nails or staples. You can also add this board after installing your drawers to make that part even easier!

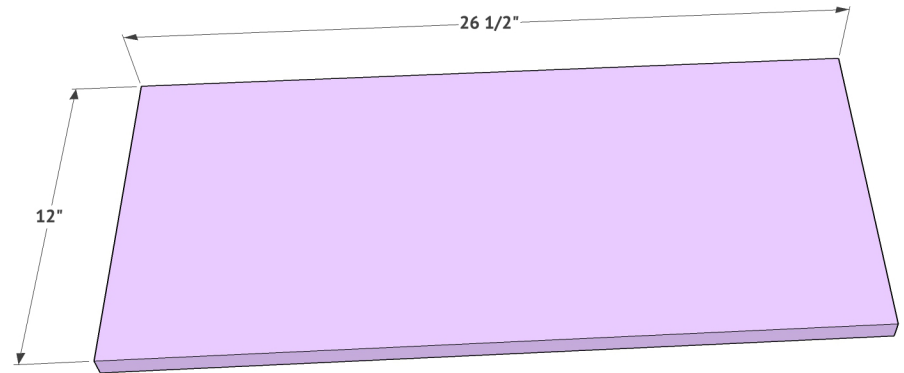

The shelf boards will all be created with 3/4" hardwood plywood. I show 3 in the cut list, but you can make less or more depending on your storage needs. If you did not add shelf pin holes to your cabinet, you can attach the shelves using 1.25" pocket hole screws through 3/4" pocket holes on the bottom of each shelf board. If you did use shelf pin holes, you will want to cut these boards about 1/4" shorter to allow room for the shelf pins on each side.

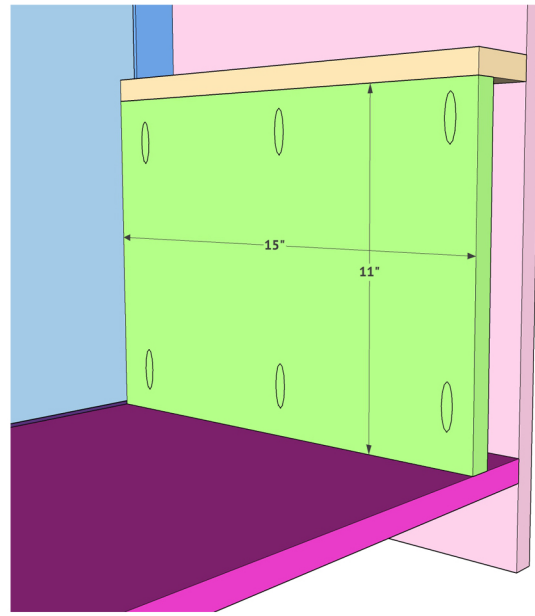
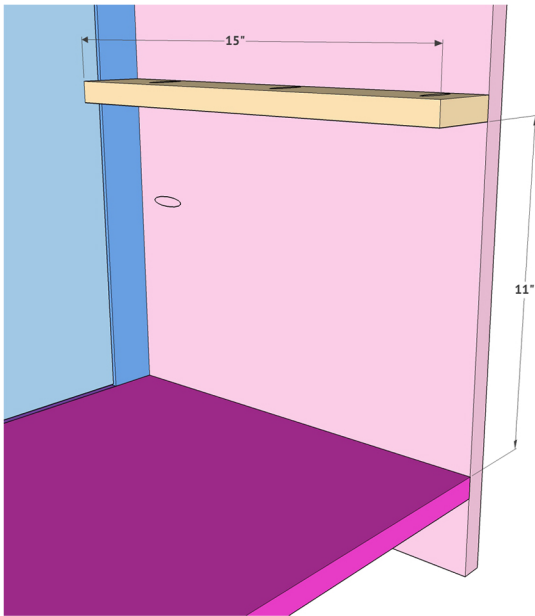

Next, build the supports for the drawers. This is also created with 3/4" plywood. Use a table saw to cut these pieces to size. Add 3/4" pocket holes to the top of the top board first and attach them to the sides using wood glue and 1.25" pocket hole screws. You will repeat this step on the opposite side of the cabinet as well. Add 3/4" pocket holes to the top and bottom of the vertical board and attach it in place using wood glue and 1.25" pocket hole screws. Again, repeat this on the opposite side of the cabinet. These will be the boards your drawer slides attach to.

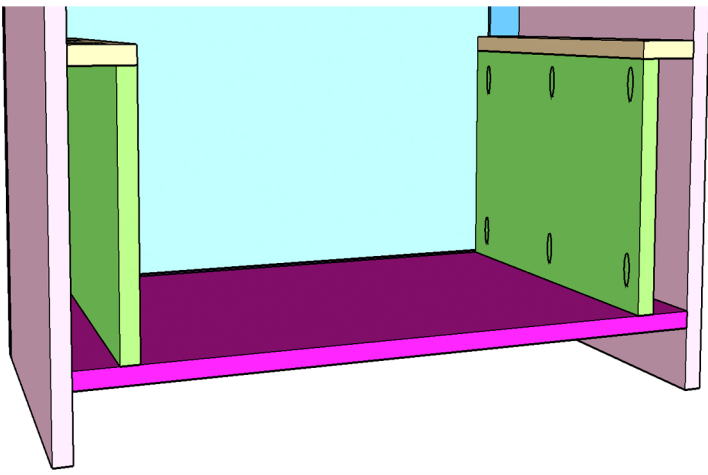

10

The final step is creating your drawers. I used 3/4" plywood for the sides of the drawers. You can also use 1x4 boards. Attach each corner using wood glue and 1.25" brad nails to create the box. The base of each drawer is 1/2" plywood. Attach it to the box using wood glue and 1.25" brad nails. Refer to our video for tips on installing the drawers into the pantry!

