



©2020 WWW.SHANTY-2-CHIC.COM



Farmhouse Storage Cabinet

Supply List

Item	Quantity	Description
48" x 96" 3/4" hardwood plywood sheet	1	Purebond Plywood - poplar or oak
48" x 48" 3/4" hardwood plywood sheet	1	Purebond Plywood - poplar or oak
48" x 96" 1/4" hardwood plywood sheet	1	Purebond Plywood - poplar or oak
48" x 48" 1/4" hardwood plywood sheet	1	Purebond Plywood - poplar or oak
1x3x8	3	pine or whitewood
1x3x4	1	pine or whitewood
1x2x8	10	pine or whitewood
1x2x4	1	pine or whitewood
laminated pine project panel	1	cut to size
metal casters	6	link on website
metal pulls	4	link on website
metal corners	6	link on website
strap hinges	8	link on website

Remember!

Many of these cuts are best made as you go. If you have questions, check out the tutorial on our site!

CUT LIST

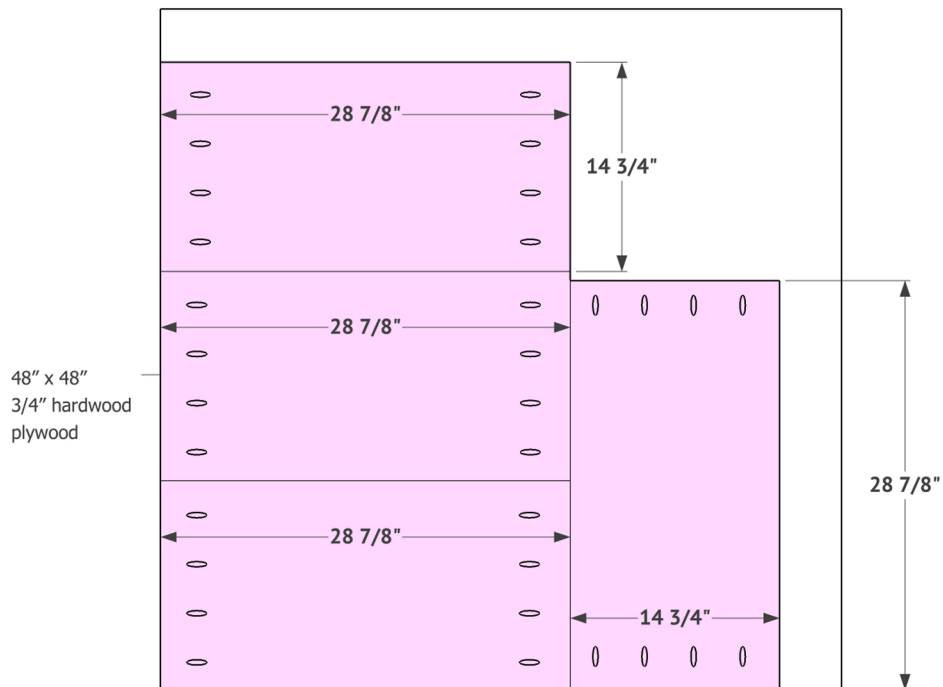
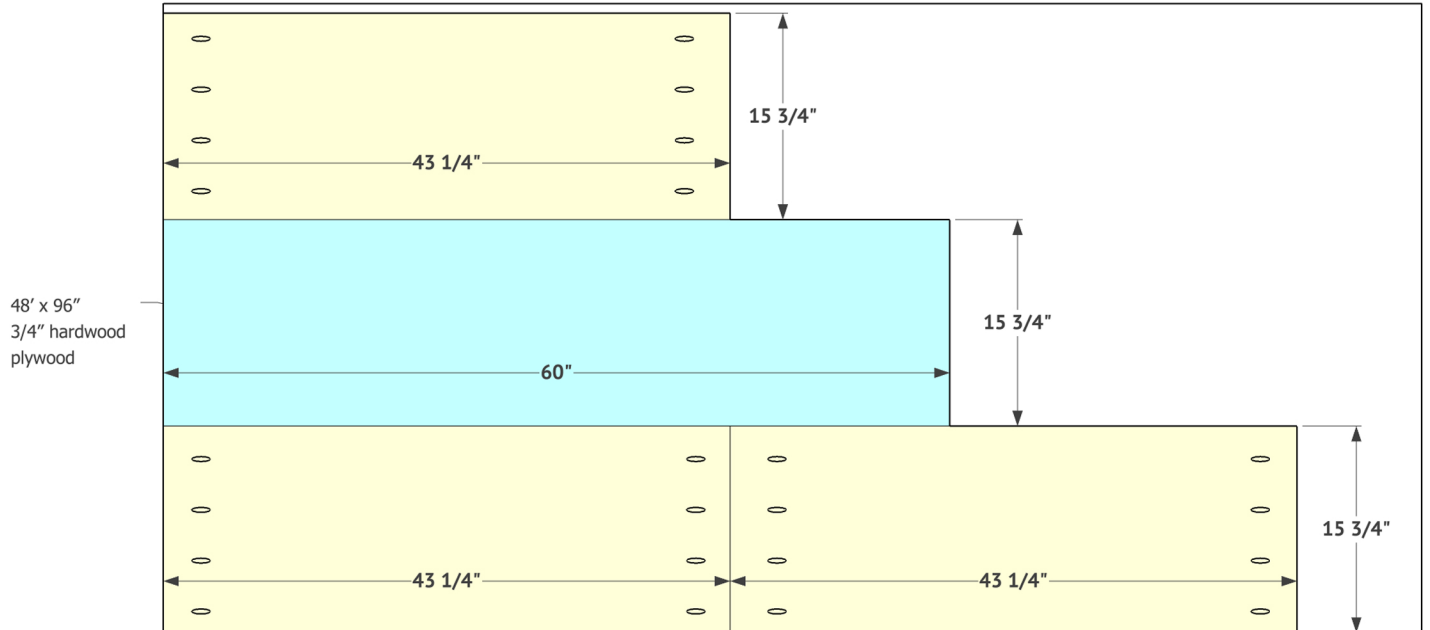

Remember!

Many of these cuts are best made as you go. If you have questions, check out the tutorial on our site!

CUT LIST

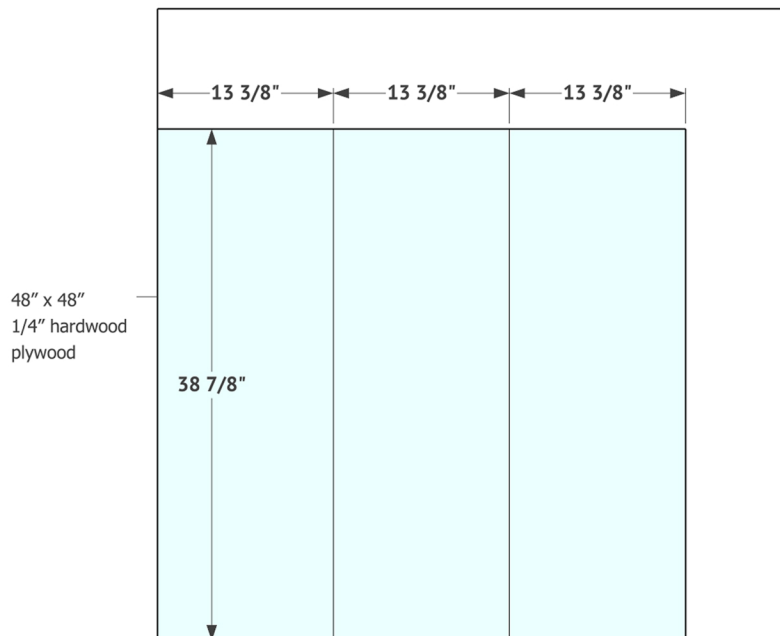
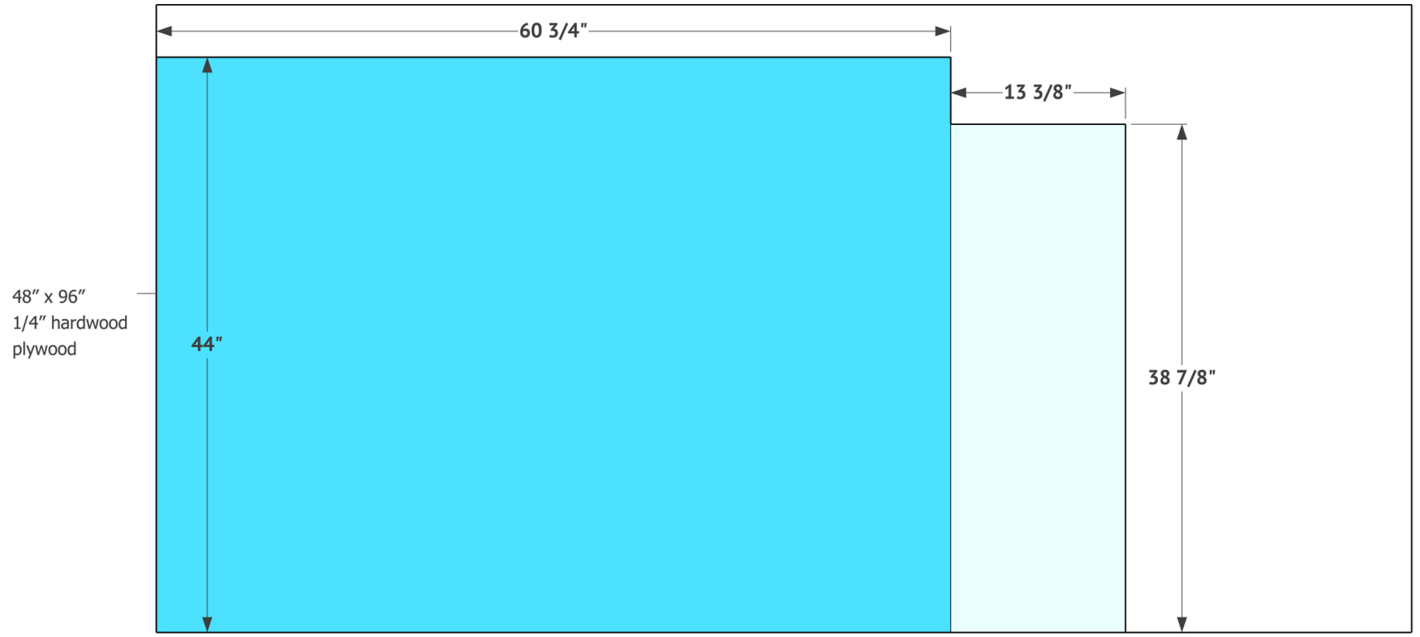

Remember!

Many of these cuts are best made as you go. If you have questions, check out the tutorial on our site!

CUT LIST

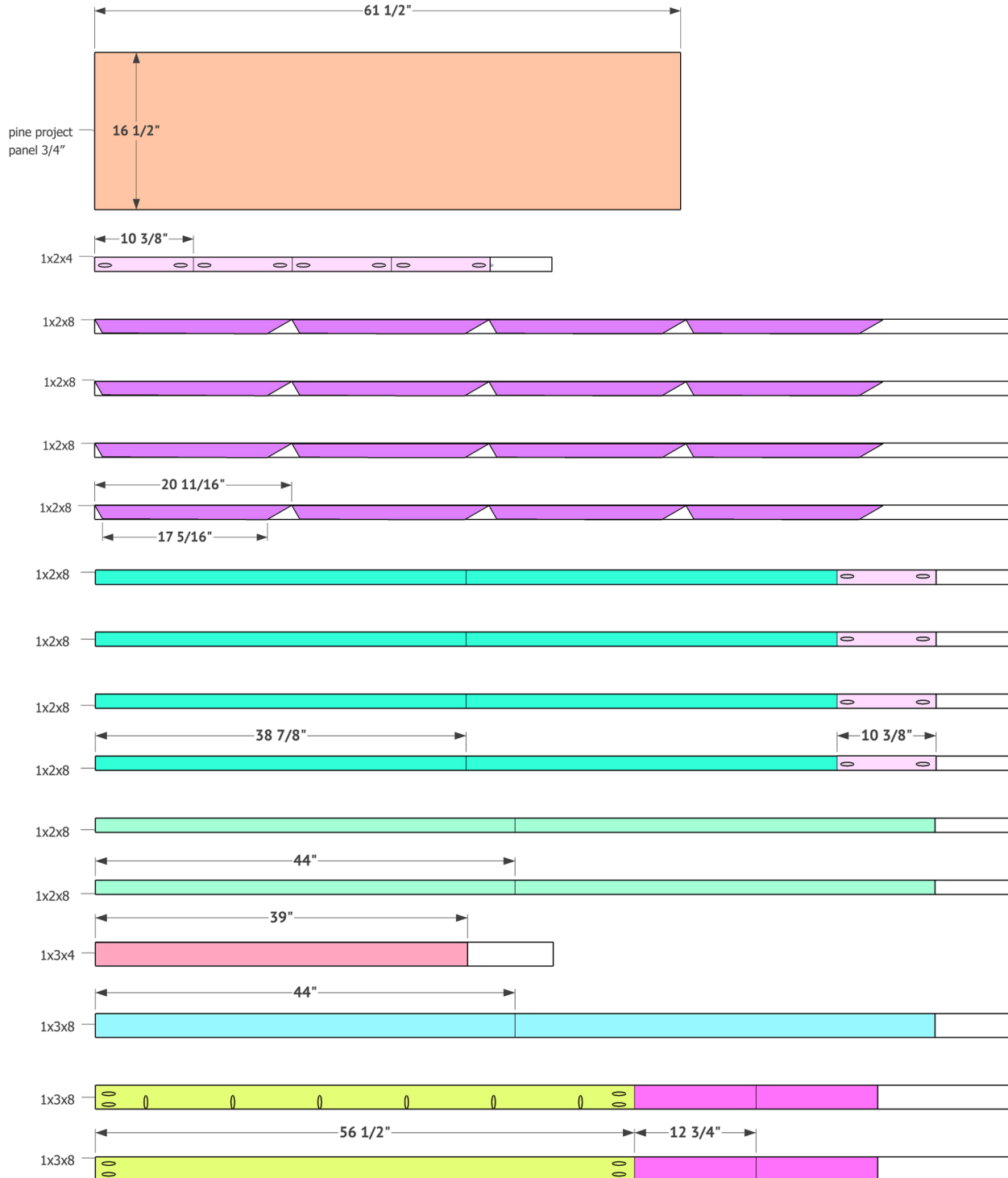

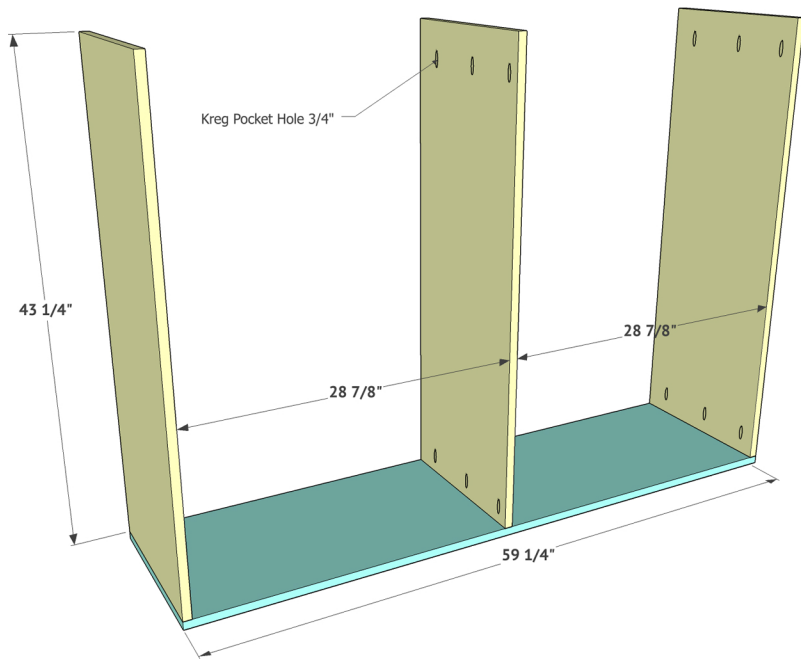

1

First, add 3/4" pocket holes to each end of all three vertical cabinet boards. Attach these boards to the base piece using 1.25" pocket hole screws and wood glue. Make sure the outside 2 boards are flush with the ends of the bottom board.

Next, attach the top project panel. Attach it with wood glue and 1.25" pocket hole screws through the ends of each vertical board and into the top.

2

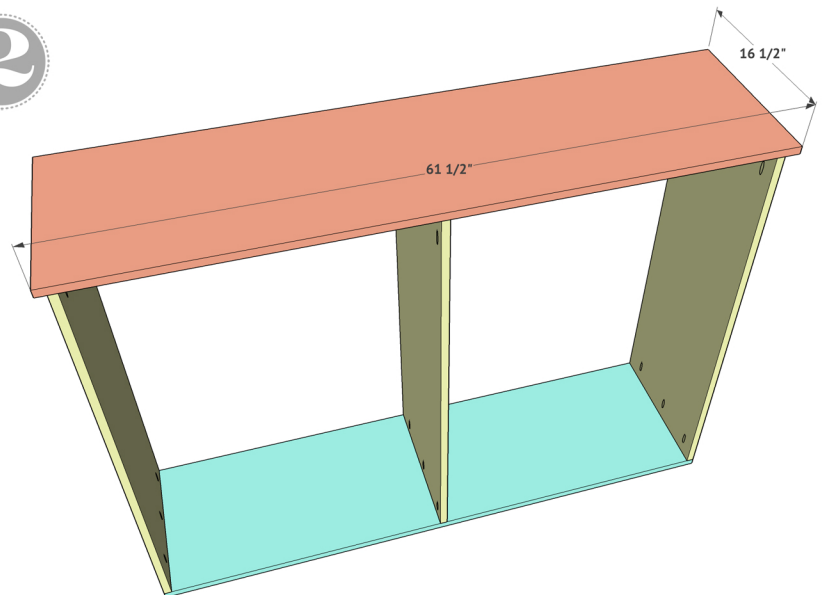

3

This shows you the spacing of the top board from the front of the cabinet. You want the top to overhang by 3/4" on both the front and sides of the side boards.

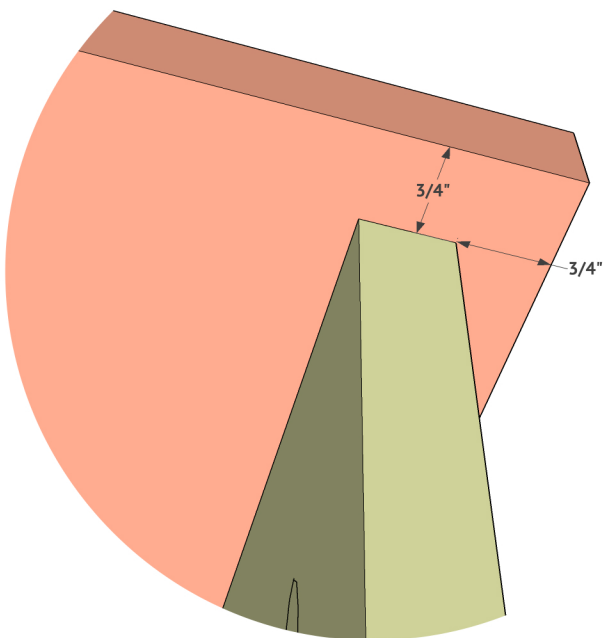

4

Now add the shelves. These will each have 3/4" pocket holes on each end of one side. Attach them to the vertical boards using 1.25" pocket hole screws and wood glue. You can place the shelves where they best fit your storage needs. You can also use the shelf pin jig to create shelf pin holes if you want to be able to move your shelf boards around.

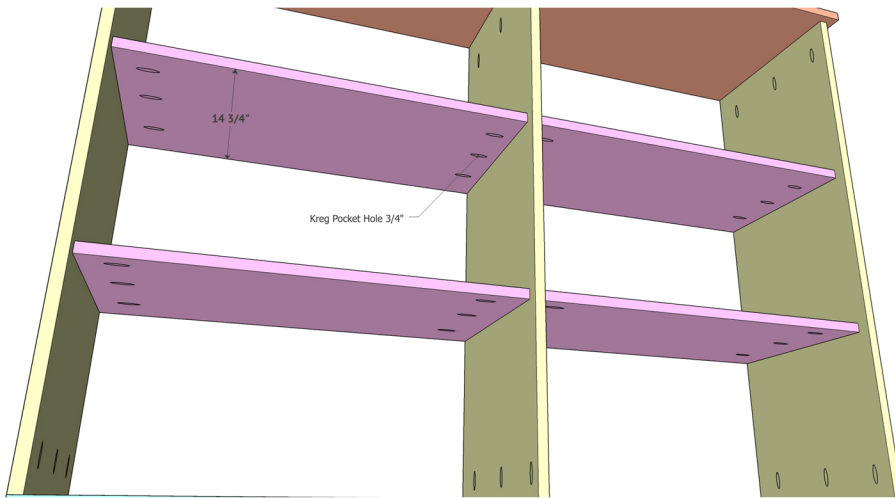
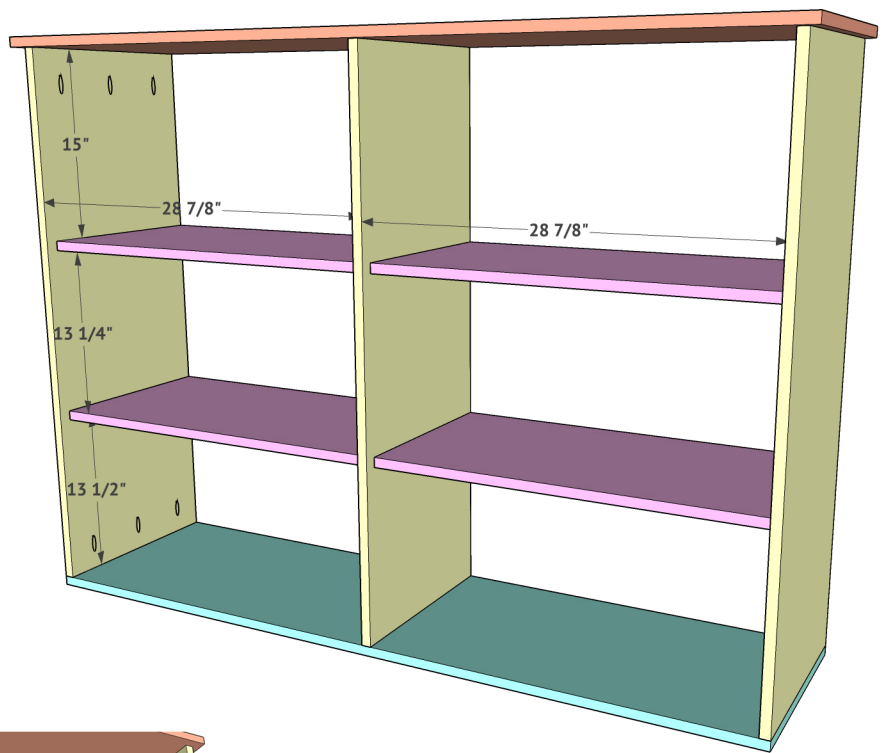

5

Attach the side trim boards next. Use wood glue and 1.25" brad or finish nails to attach them in place. I chose to nail mine from the inside of the cabinet to hide my nail holes. That's entirely optional. Attach the trim pieces on both sides of the cabinet.

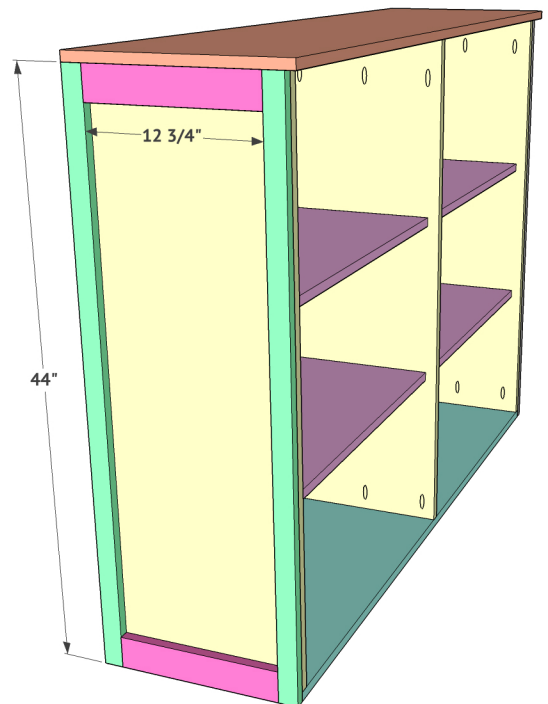

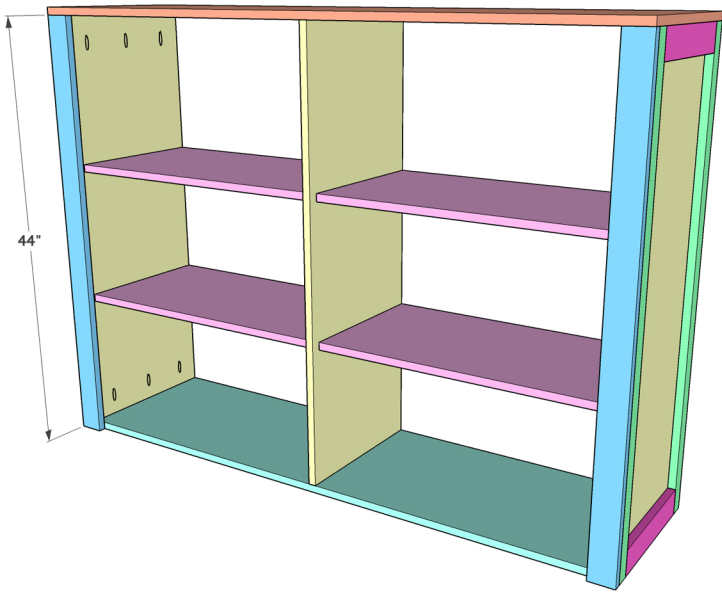

6

Attach the vertical front trim boards next. Line them up flush with the outside of the cabinet and attach them using wood glue and 1.25" brad or finish nails.

7

Now attach the horizontal trim boards. Attach the bottom board with 1.25" brad nails into the base of the cabinet, and attach it to the vertical trim boards using 1.25" pocket hole screws. Don't forget wood glue! The top board will be attached to the top of the cabinet and to the vertical boards using wood glue and 1.25" pocket hole screws.

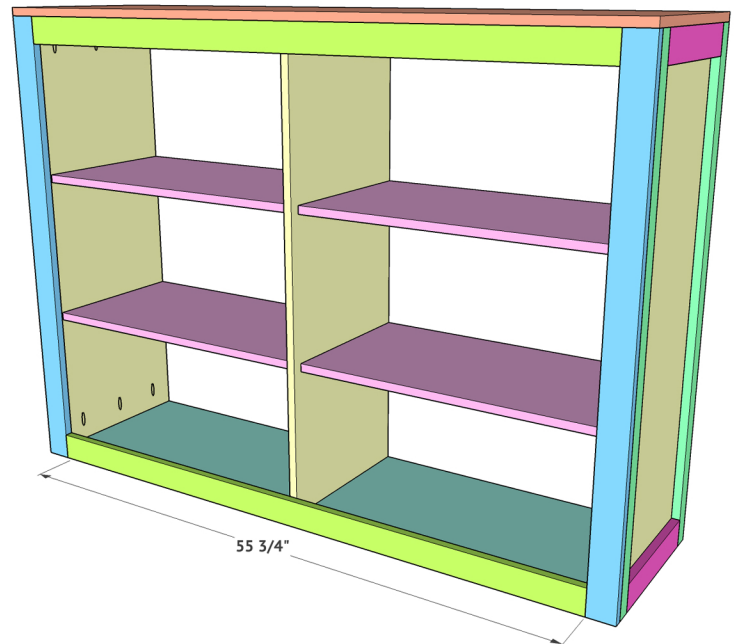

8

Glue and nail the middle divider board into place. Make sure you line this board up in the center of the cabinet.

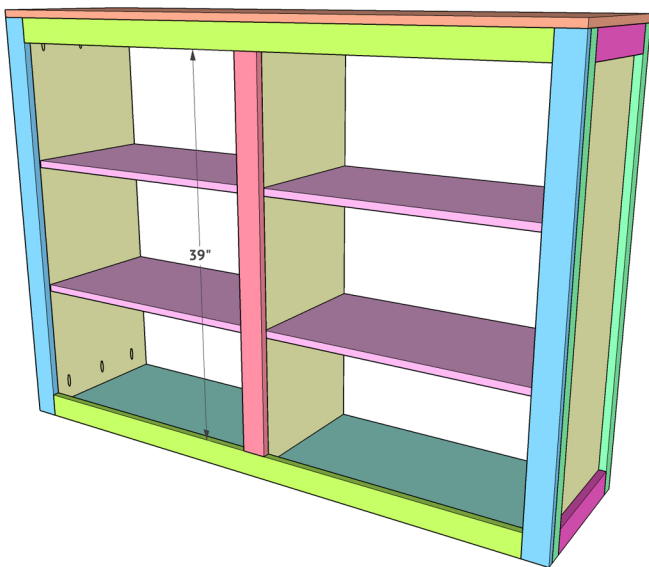

9

Attach the back of the cabinet using 3/4" staples. You can also use brad nails on this part if you don't have a stapler. I had Home Depot make the cut for the back to make it easier to get home.

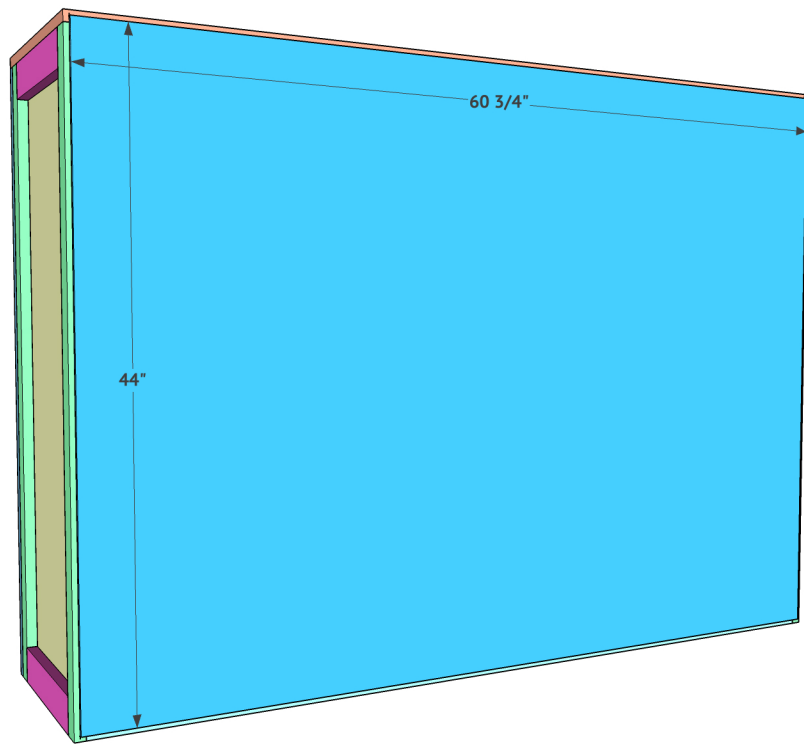

10

Build the door frames first by attaching the shorter boards to the longer boards with wood glue and 1.25" pocket hole screws.

Then, attach the backs of the doors to the back of the frames using wood glue and 3/4" staples or brad nails.

Attach the diagonal trim boards last. Cut these to size! The easiest way to get the best cut is to actually hold the board in place and mark where you need to make the cut.

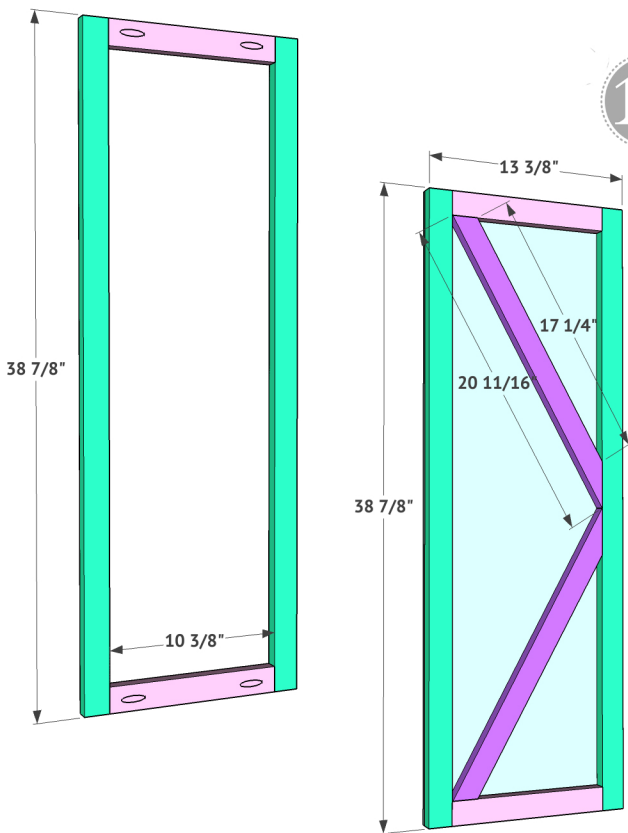

I made the plans for these with 1x2 boards, but I actually used 1/2" craft boards to make my diagonal trim pieces. I know some of you have a hard time finding those, so I did the plans this way. If you decide to use craft boards, just sub them for the 1x2 on the supply list.

