



©2021 WWW.SHANTY-2-CHIC.COM



X Door Storage Cabinet

Supply List

Item	Quantity	Description
3/4" plywood	1	hardwood plywood
1x3x8	1	pine or whitewood
1x4x4	1	pine or whitewood
bender board	2	or craft boards
1/4" hardwood plywood	1	cut to size
edge-glued panel	1	cut to size
1.25" pocket hole screws	several	Kreg Brand
wood glue		
1.25" brad nails		
1/2" brad nails		
hinges	4	refer to post
door pulls	2	refer to post

Remember!

Many of these cuts are best made as you go. If you have questions, check out the tutorial on our site!

CUT LIST

1/4"
hardwood
plywood

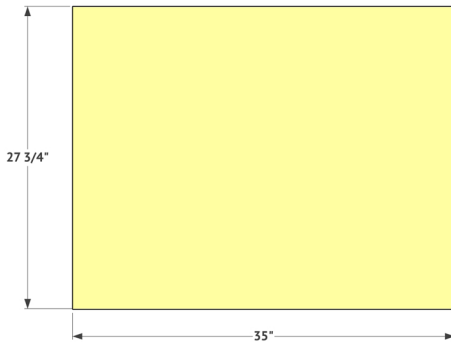

3/4" thick
edge-glued panel

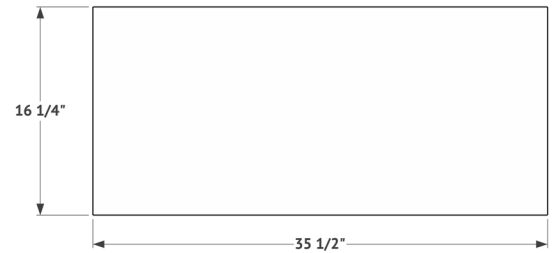

Bender or Craft
Board ripped to
.75" wide



Bender or Craft
Board ripped to
1.5" wide

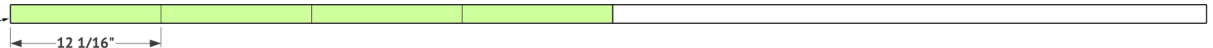

1x4x4

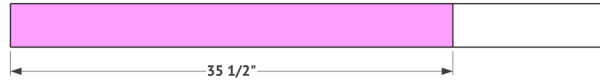

1x3x8

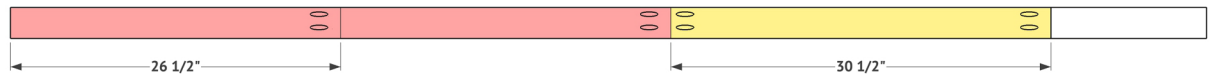

3/4"
hardwood
plywood

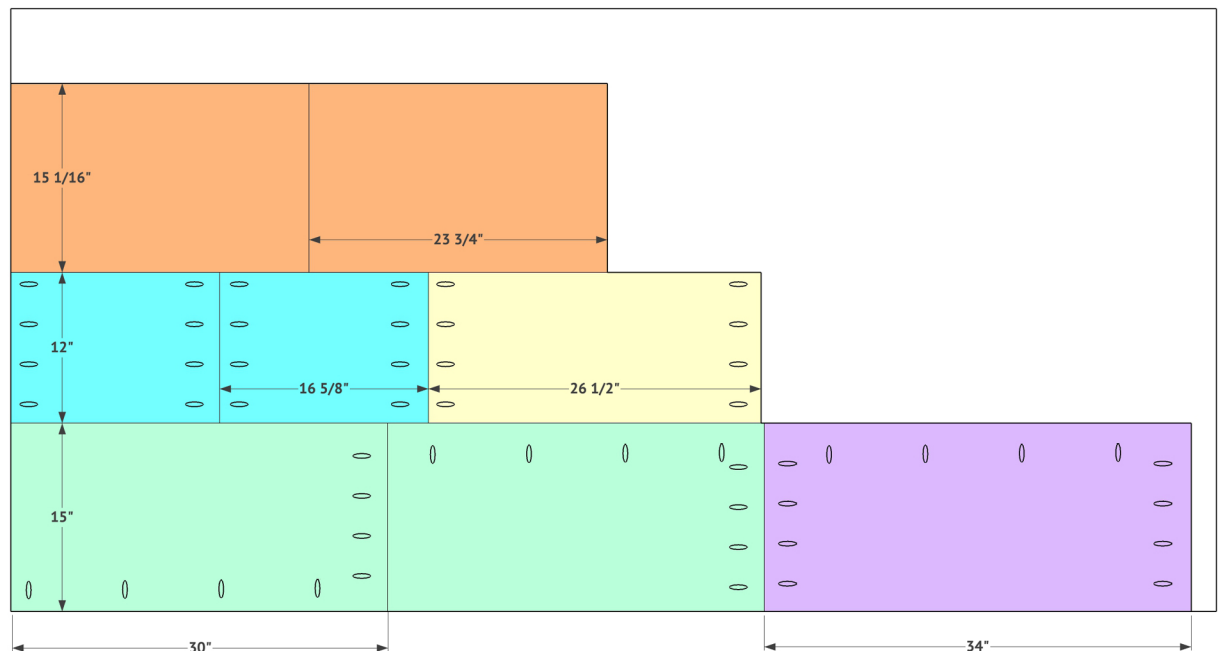

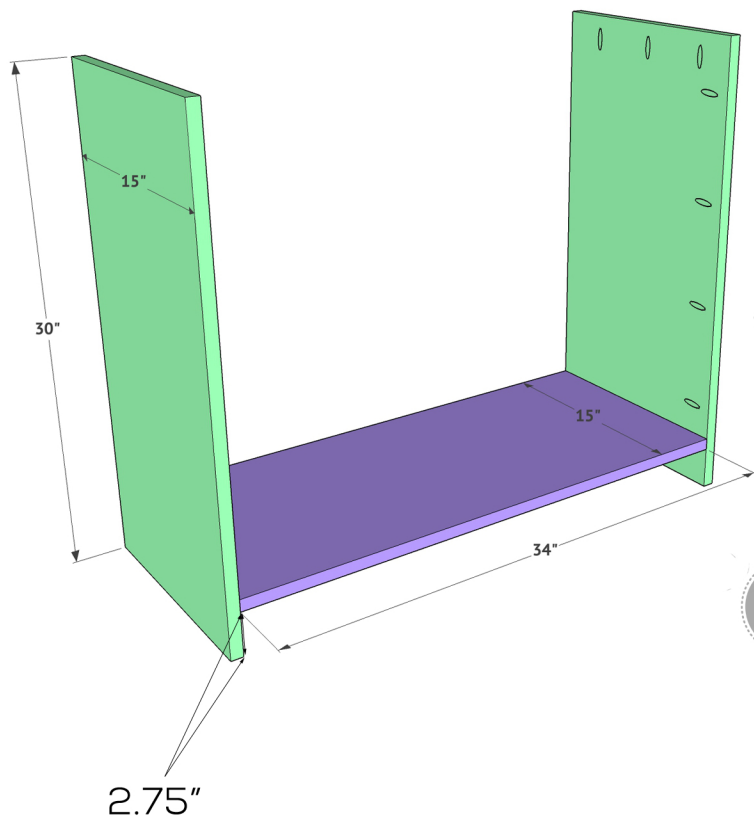

First, build the body of the cabinet. This is $\frac{3}{4}$ " hardwood plywood ripped to 15" wide. You can have the hardware store rip the boards for you to make it easier to get home. Add $\frac{3}{4}$ " pocket holes on both sides and base as pictured. Attach the base to both sides using a line of wood glue and 1.25" pocket hole screws through your pocket holes. The base will line up 2.75" from the base of the sides to the bottom of the base piece.

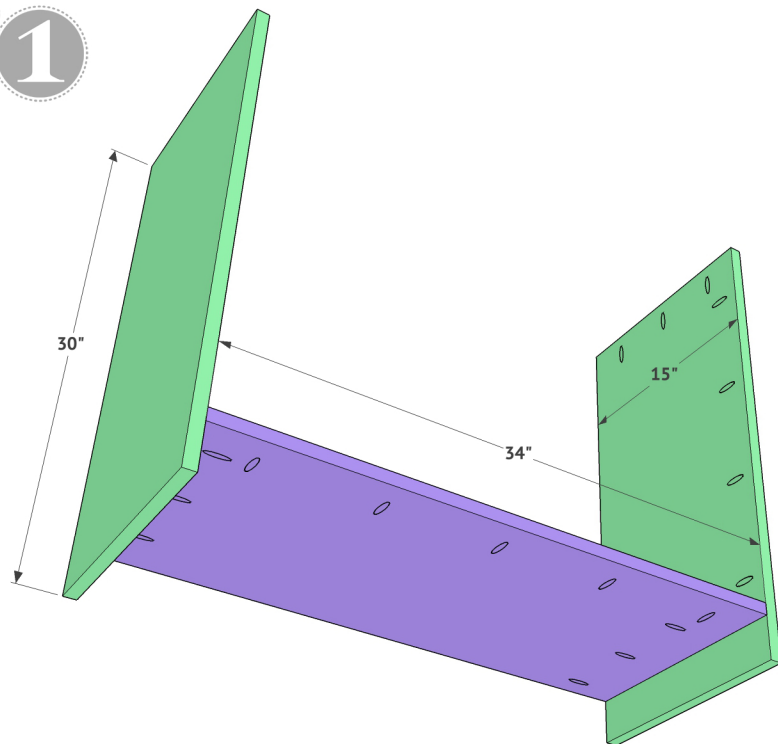

Now add the middle divider. Add $\frac{3}{4}$ " pocket holes to the top and bottom of this board and attach it to the center of the bottom board using wood glue and 1.25" pocket hole screws. This board will line up in the center of the base board.

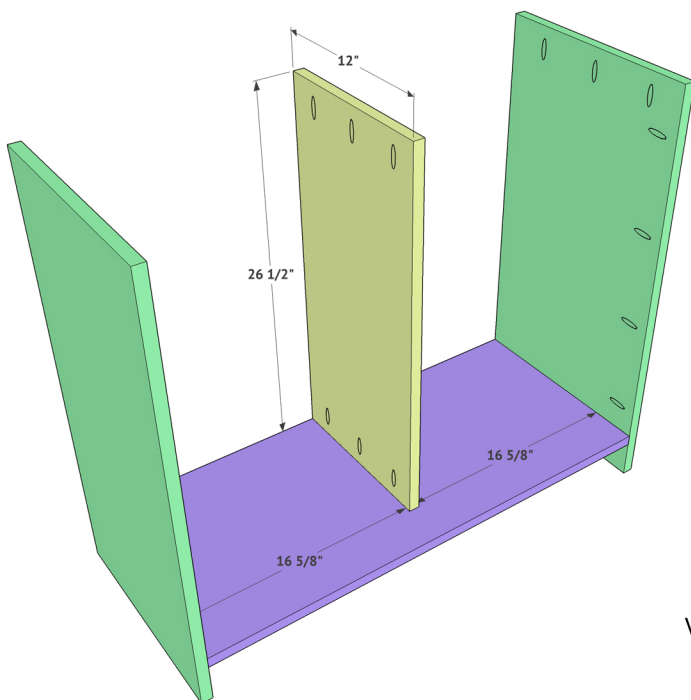

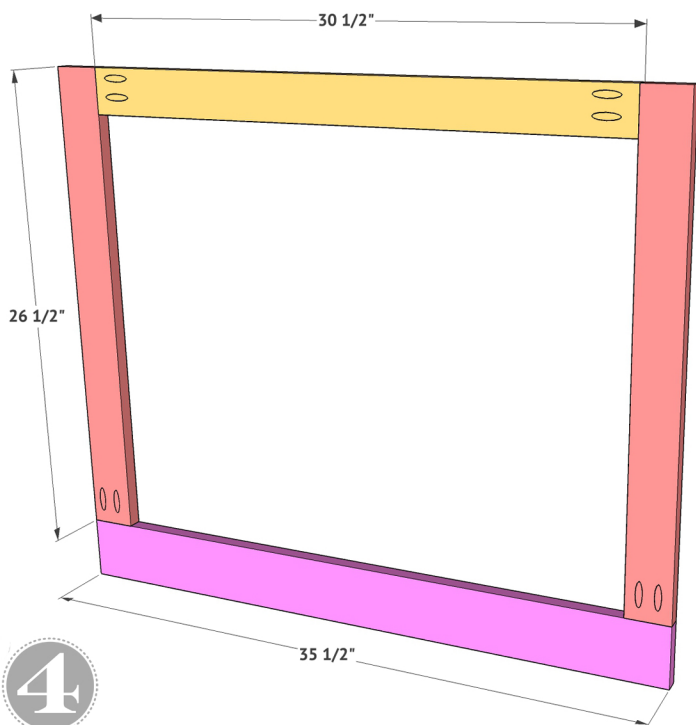

3

Build the face frame next. The bottom board is a 1x4 and the sides and top board are 1x3. Add 3/4" pocket holes on both sides of the top board and to one end of each side board. Attach all pieces to form a rectangle using wood glue and 1.25" pocket hole screws. Make sure all corners and sides are flush.

4

Before attaching your face frame, attach the shelf boards. I lined mine up 13" from the base, but you can position yours to best fit your storage needs. These boards are also 12" deep like the middle divider. Attach them to the sides and middle divider using wood glue and 1.25" pocket hole screws through the 3/4" pocket holes.

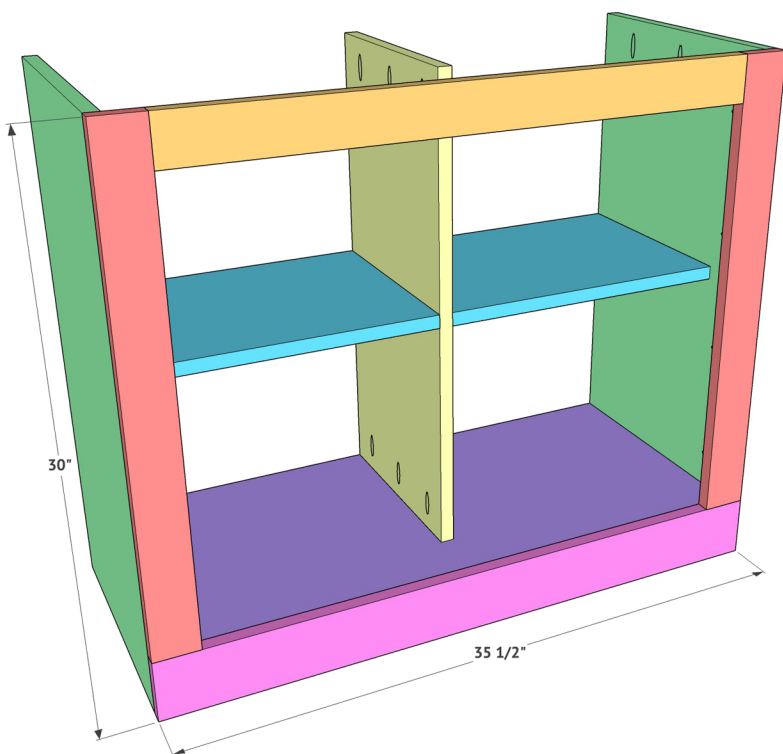
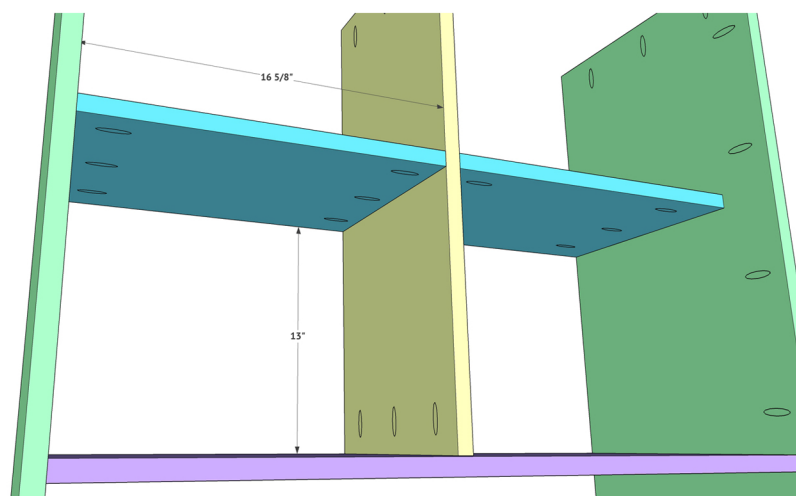

5

Attach the face frame next. Make sure all sides and base are flush and attach using wood glue and 1.25" pocket hole screws through the 3/4" pocket holes on the cabinet.

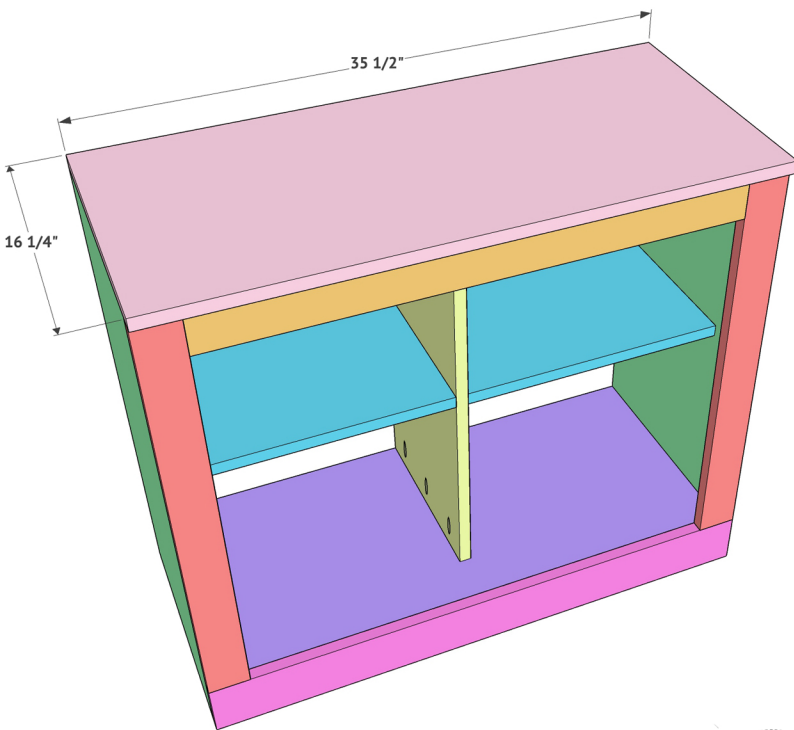

6

Attach the top of the cabinet now. I used a 3/4" thick edge-glued panel for my top. Cut it to size and attach using wood glue and 1.25" pocket hole screws through the 3/4" pocket holes on the inside and top of the cabinet.

7

Attach the back of the cabinet. I used barnwood planks on mine, but the plans show 1/4" hardwood plywood. You can really use whatever you want on this part. Attach the back using 1" brad nails or staples.

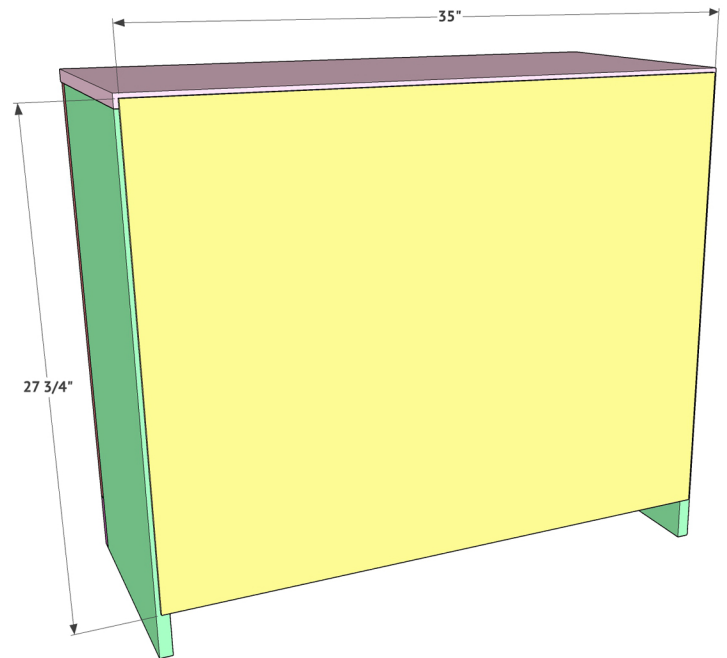

8

Now it's time to build the doors to cabinet. The back of the doors is 1/2" hardwood plywood. Cut them to size.

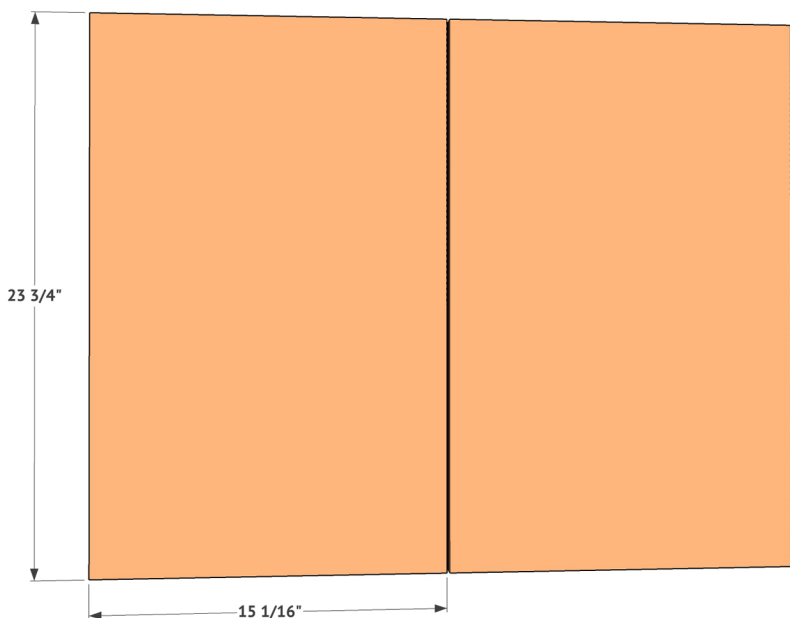

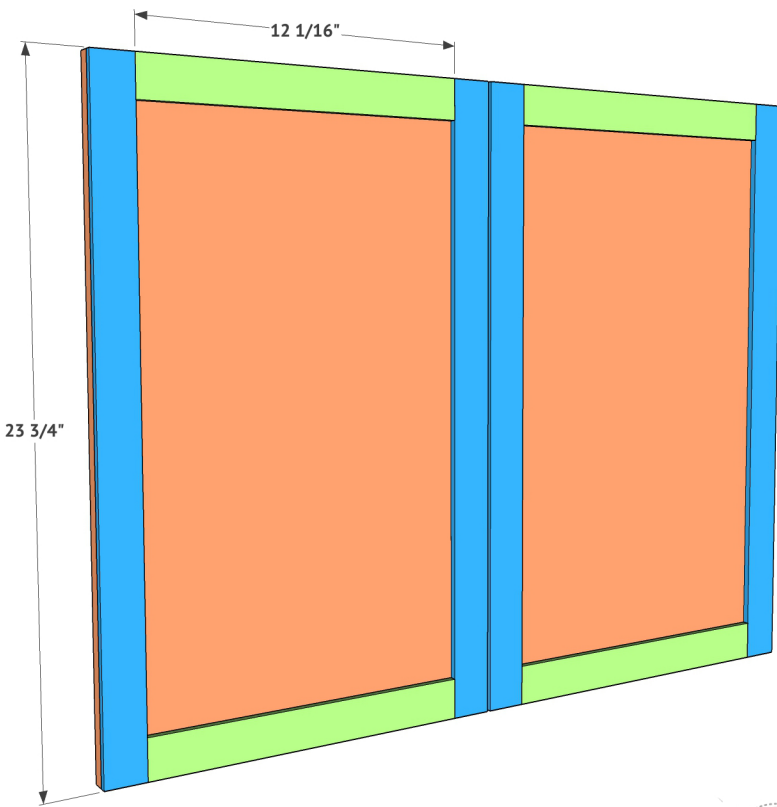

9

Add the outside trim next. I am using bender board from HD, but you can also use 1/4" craft boards. These boards are ripped to 1.5" wide each.

Attach the vertical boards first using wood glue and 1/2" brad nails. Then measure and cut the horizontal boards using wood glue and 1/2" brad nails.

10

Measure and cut the diagonal trim pieces next. These are also bender boards or craft boards that I ripped to 3/4" wide. Attach these boards using wood glue and 3/4" brad nails.

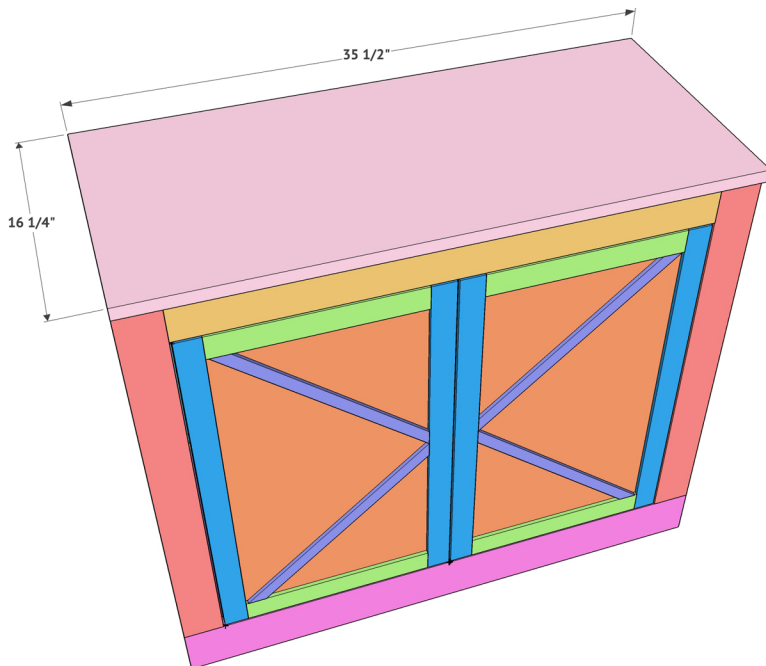
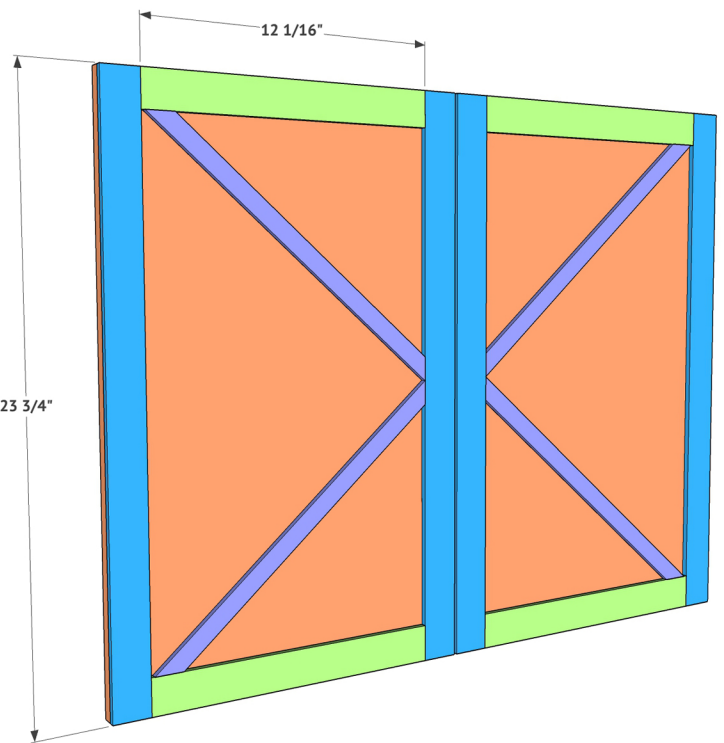

11

The final step is attaching your doors! Refer to our site for details on all the fun hardware I used as well as stain and paint colors!

If you build this cabinet, be sure to use #shanty2chic on IG so we can see it and share!

Happy Building!