



©2023 WWW.SHANTY-2-CHIC.COM



Record Player Stand

Supply List

Item	Quantity	Description
16" x 48" laminated pine project panel	2	
metal feet	4	see post for link
record dividers	2	see post for link
1.25" Kreg pocket hole screws	several	
wood glue		

Remember!

Many of these cuts are best made as you go. If you have questions, check out the tutorial on our site!

CUT LIST

16" x 48"
laminated
project
panels

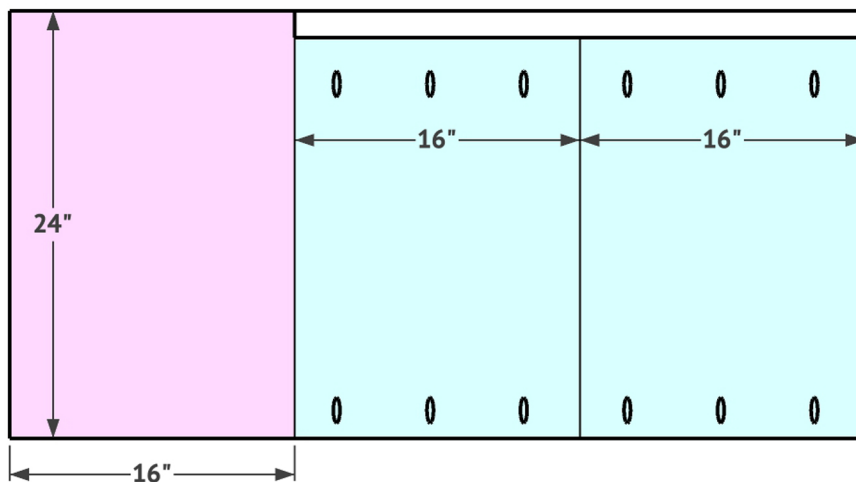
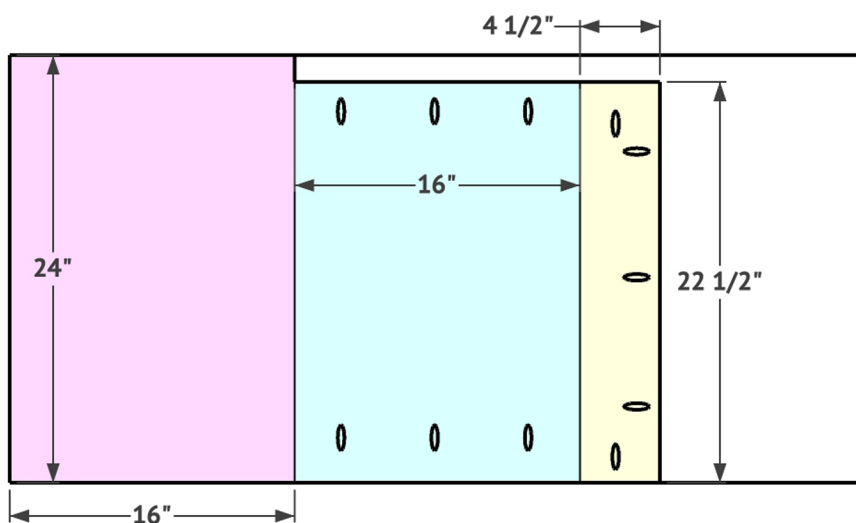

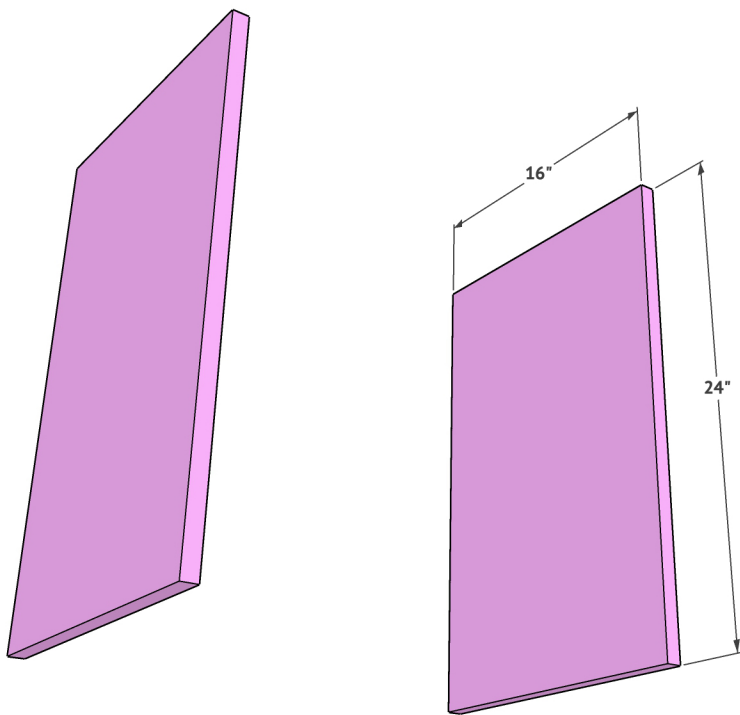

1

The first step is making your cuts. I used laminated pine boards to build this stand. These can typically be found by other dimensional lumber at the hardware store. I purchased two 16" x 48" boards to build this.

Cut two sides to 24" long each.

Next, cut the boards to create the shelf pieces. You will have 3 of these boards identical to one another.

Add 3/4" pocket holes to the shorter sides of all 3 boards. You want the pocket holes on the side of the board that will face down on all 3.

2

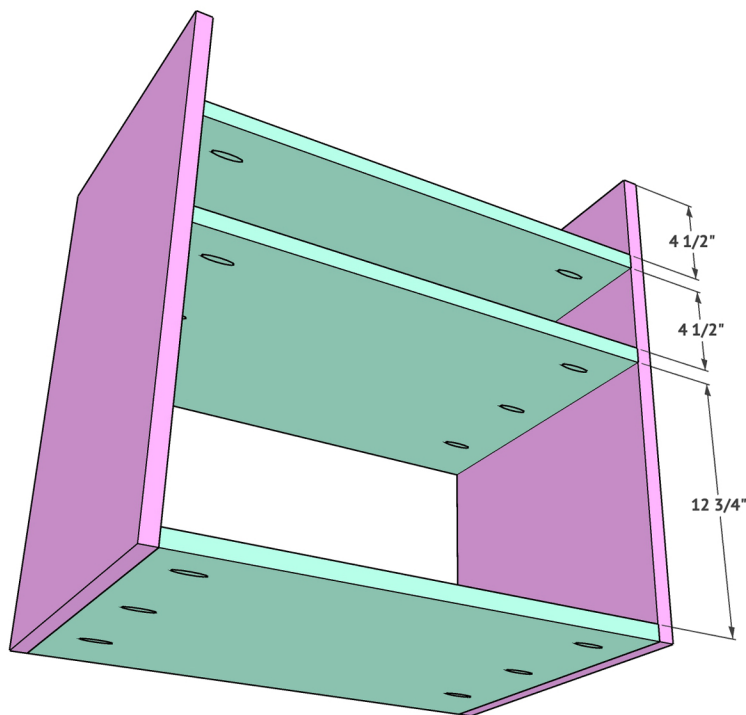
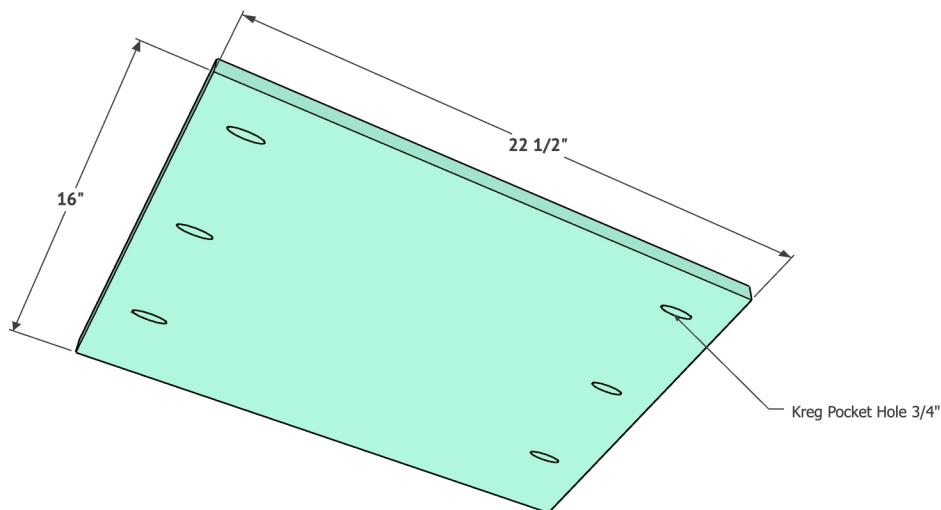

3

Now attach the shelf boards to the sides of the record player stand. These will attach through the pocket holes of the shelf boards and into each side using wood glue and 1.25" pocket hole screws. Attach the top shelf first to make the pocket holes easier to access.

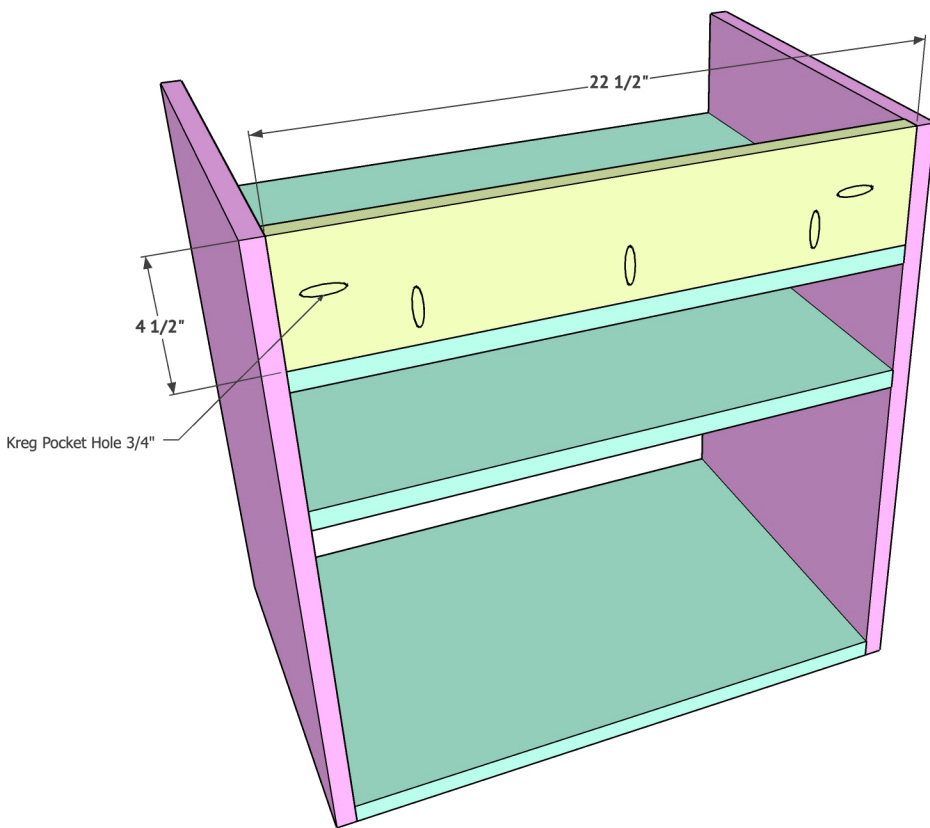

4

The final step is attaching the top trim piece. Add 3/4" pocket holes to one side and both short sides of the trim piece. Attach it to the stand using wood glue and 1.25" pocket hole screws through the pocket holes and into the stand.

At this point you are ready to stain your record player stand and add the hardware! Check out our website to see which hardware we used and other tips as well!
Happy Building!