



©2023 WWW.SHANTY-2-CHIC.COM



# Modern Waterfall Console

## Supply List

Item	Quantity	Description
2 x 4 x 8 Framing Lumber	5	
12" x 72" laminated pine project panels	4	
wood glue		
Pocket Hole Screws	several	2.5" and 1.25"

*Remember!*

Many of these cuts are best made as you go. If you have questions, check out the tutorial on our site!

## CUT LIST

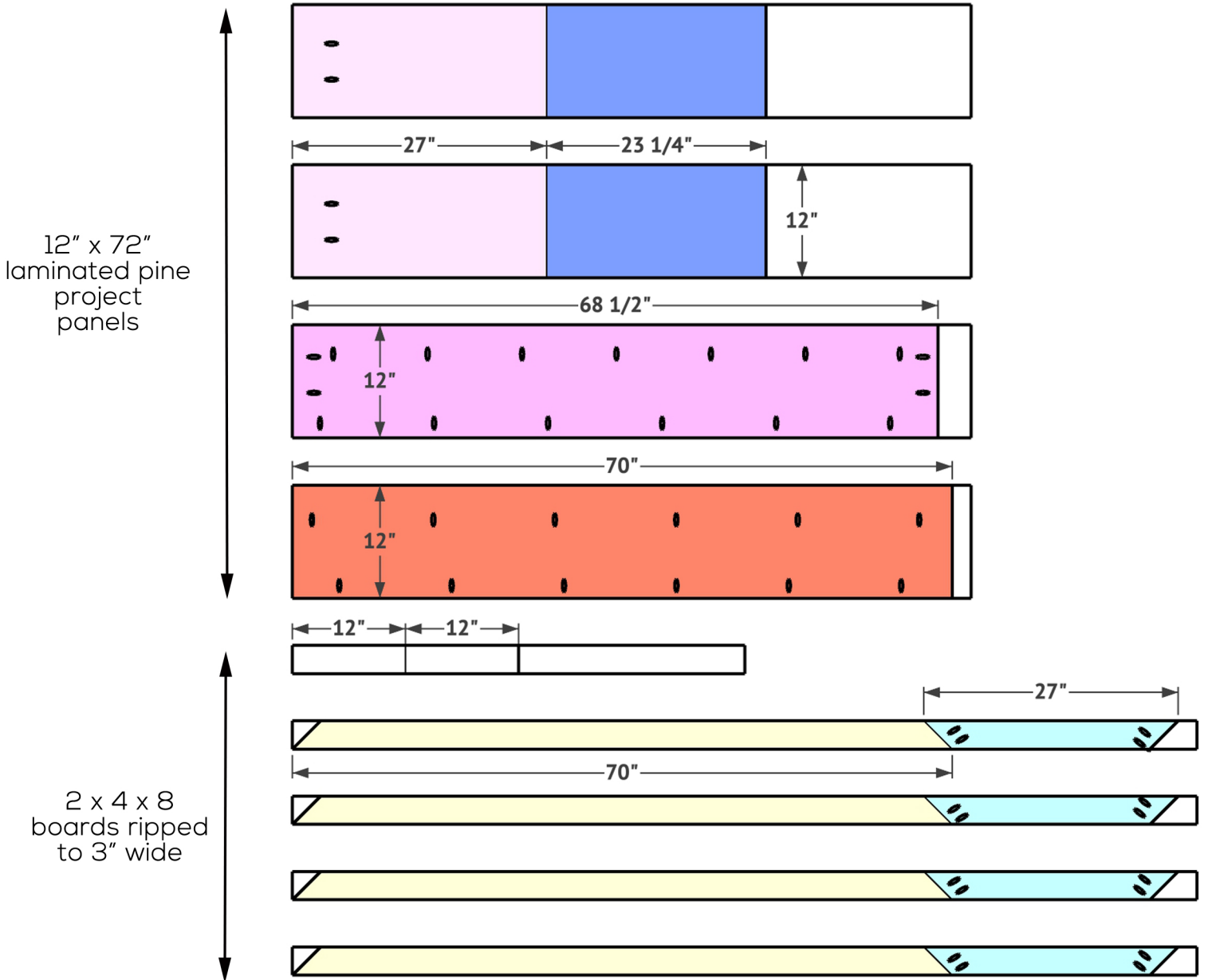

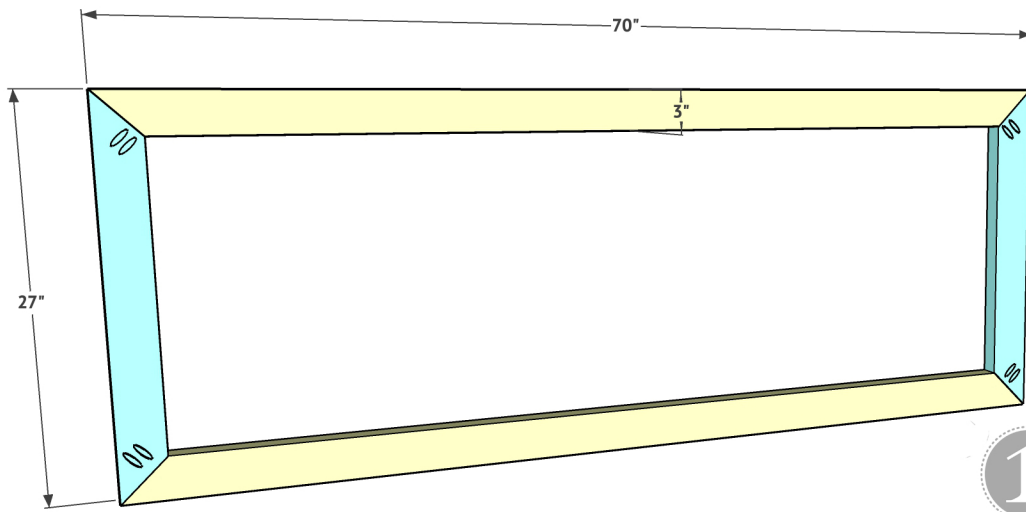

Create the frames first. These are made from 2x4 boards that I ripped to 3" wide each on the table saw. You will create 2 identical frames, one for the front and one for the back. Each piece will be cut at a 45° angle on each end. Add 1.5" pocket holes to the ends of each of the shorter frame pieces. You will do these also at a 45° angle. Attach the pieces to create 2 rectangle frames using wood glue and 2.5" pocket hole screws.

1

Next, attach the bottom board to the front frame. The bottom shelf board is made from one of the 12" wide project panels. Add 3/4" pocket holes down both short and long ends of this board. Attach the board to the frame using wood glue and 1.25" pocket hole screws. The top of the bottom shelf will line up flush with the top of the bottom frame piece.

2

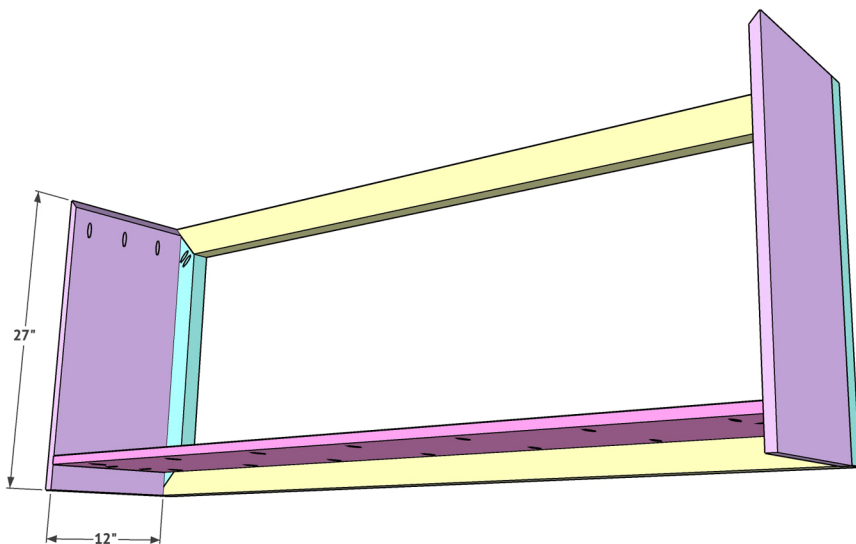
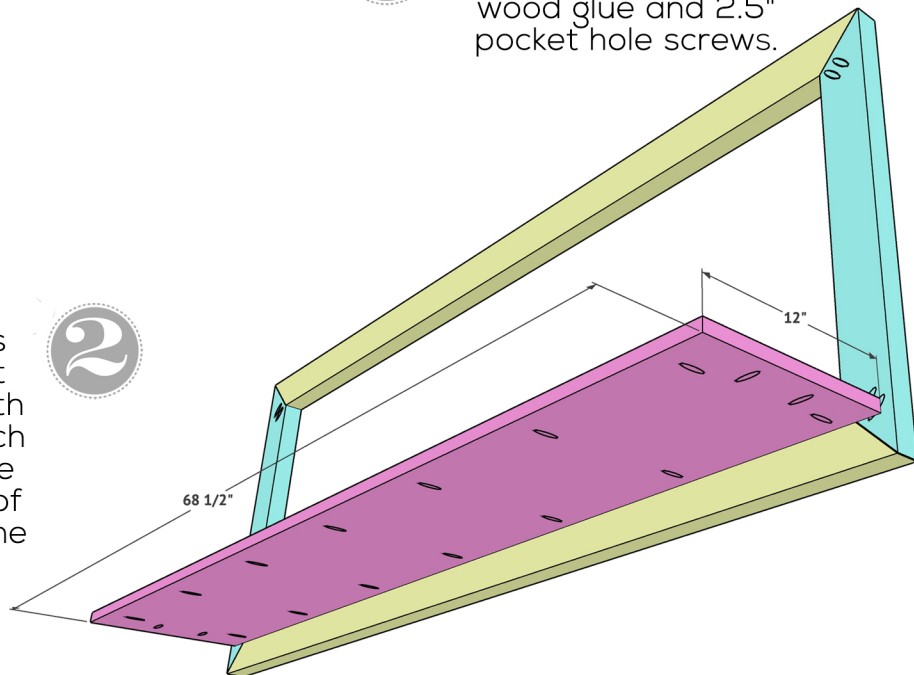

3

Attach the sides of the cabinet next. These are also laminated pine boards. The base of each of these boards will be a straight cut and the top of each board will be cut at a 45° angle. Add 3/4" pocket holes at the top of each of these boards just below the angle cut as well as down both long sides. Attach the sides to the base with 1 1/4" pocket hole screws through the base shelf board and into the side boards and also connect to the frame through the pocket holes on the board and into the frame. The side will be flush with the outside edge of the frame.

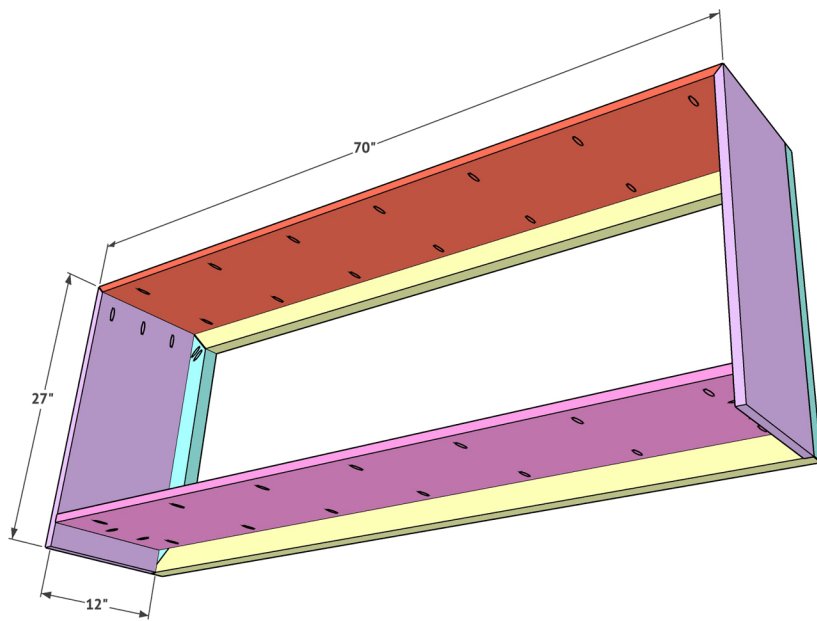

4

Now attach the top of the table to the frame. Add 3/4" pocket holes along both long sides of this project panel. Attach the top to the front frame using 1 1/4" pocket hole screws and wood glue. The top of this board will be flush with the top of the frame. Also, attach the side pieces up into the top board also using 1 1/4" pocket hole screws and wood glue. Your angles should be flush forming a square edge on the top corners and everything should line up flush with your frame.

5

Now, attach the back frame to the cabinet. The easiest way to do this is to lay the back frame flat and put the cabinet on top of it. Attach everything to the back frame just like you attached it to the front frame using wood, glue and pocket hole screws.

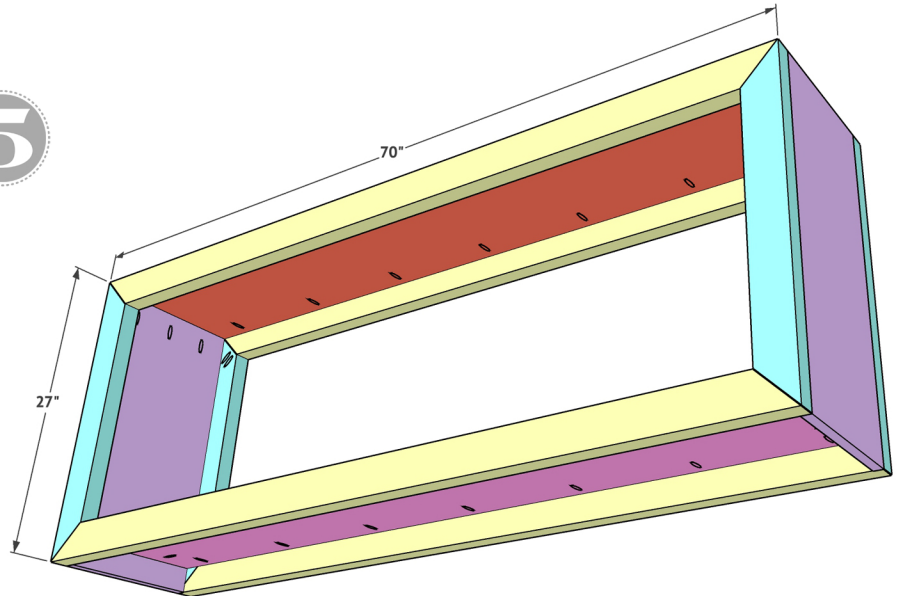

6

Using scraps from the 2x4 boards, cut two supports for each side. These will be 12" long each to match the width of the laminated board. Attach them to the inside of the cabinet side pieces, using wood glue and 3/4" brad nails.

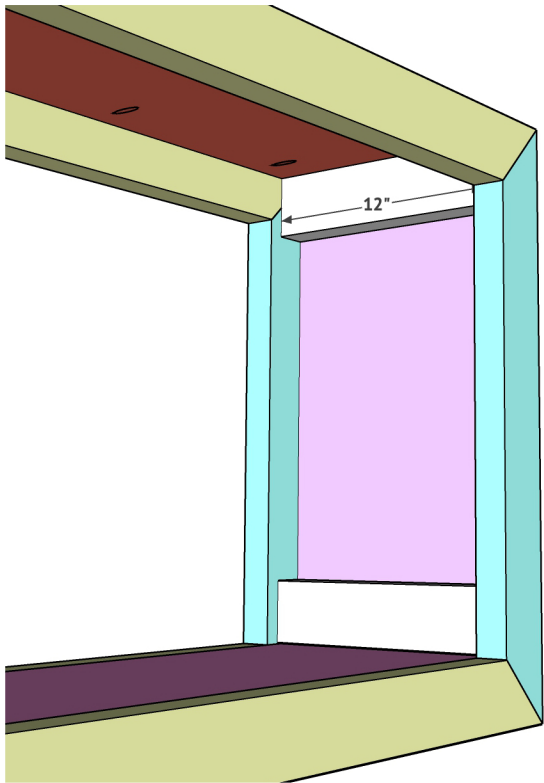

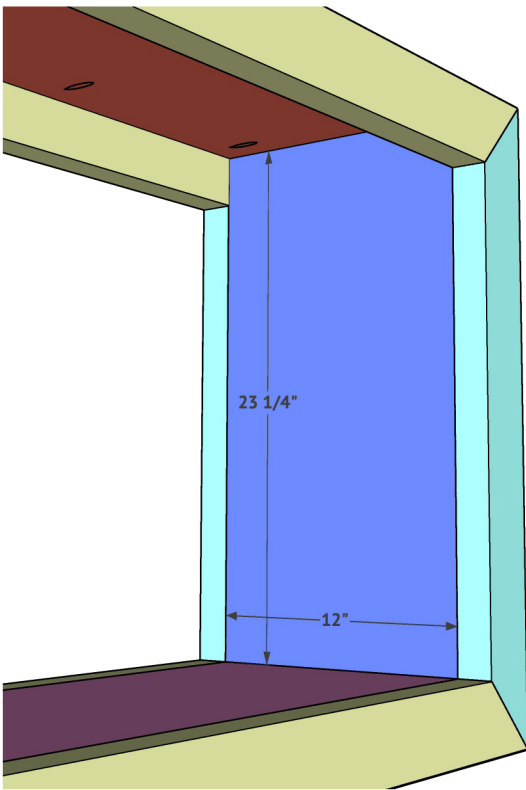

The final step in construction of the table is attaching the inside trim pieces to give it a thick, chunky look. These pieces are also cut from the laminated pine boards. Cut them to size and attach them to the inside support pieces using wood glue and brad nails.